

STATE	DIST. NO.	PLANNING YEAR	TOTAL SHEETS
VT	71-C	1989	3

TOWN OF TROY
 Project FAGH 71-C
 Pin # 00R194
 Route VT105
 Date 1/1/1989

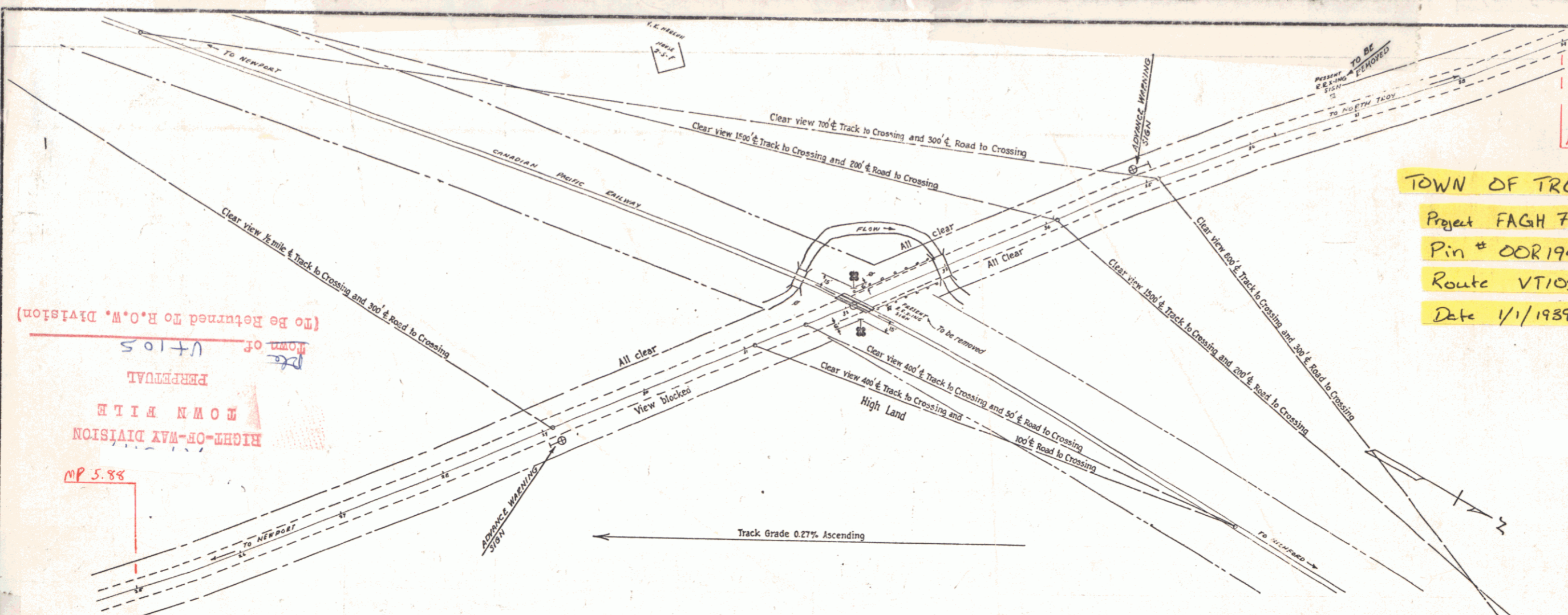

(To Be Returned to R.O.W. Division)
 Form of VT105
 PERMANENT
 TOWN OF TROY
 RIGHT-OF-WAY DIVISION
 MP 5.88

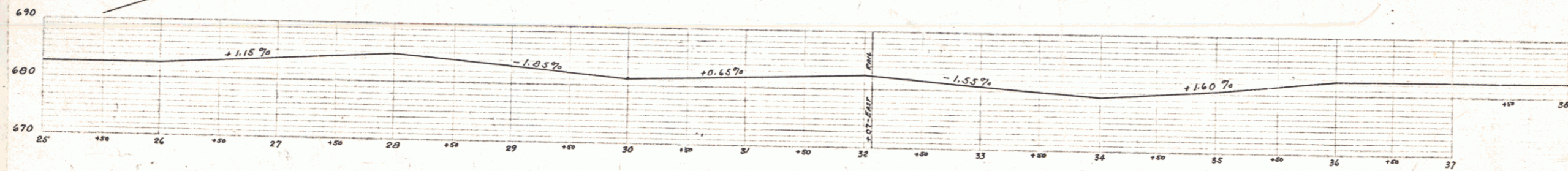

PROFILE OF ROAD

STATE OF VERMONT
 STATE HIGHWAY DEPARTMENT
 PLAN OF PROPOSED
 GRADE CROSSING PROTECTION PROJECT
 ORLEANS COUNTY
 AID GRADE CROSSING PROJECT NO F.A.G.H. 71-C
 AT INTERSECTION OF CANADIAN PACIFIC RAILWAY AND ROUTE
 THE TOWN OF TROY AT MILEAGE STATION 32+07.

APPROVED: *J. G. [Signature]*
 ENGINEER MAINTENANCE OF WAY
 CANADIAN PACIFIC RAILWAY

APPROVED: *H. [Signature]*
 COMMISSIONER OF HIGHWAYS

STATE OF VERMONT
 STATE HIGHWAY DEPARTMENT
 PROJECT NO. 71-C
 TITLE: Railroad grade crossing protection
 LOCATION: At intersection of Canadian Pacific Railway and Route 105 in the town of Troy at mileage station 32+07.

02/16/89
 [Signature]

HIGHWAY CROSSING DIVISION PLAN
 Surveyed by M. N. D.
 Designed by [Signature]
 Drawn by D. W. P.
 Traced by D. W. P.
 Checked by [Signature]
 Series A.A.-4, No. 71-C
 Sheet 7 of 3

VT 105