

STATE	DIST. NO.	PLANNING YEAR	TOTAL SHEETS
VT	71-C	1989	3

TOWN OF TROY
 Project FAGH 71-C
 Pin # 00R194
 Route VT105
 Date 1/1/1989

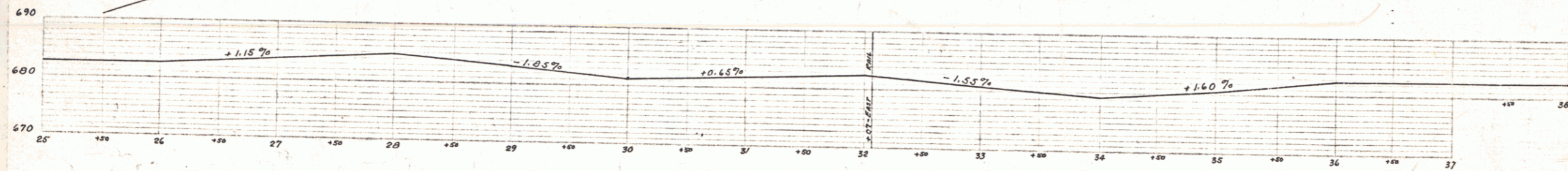
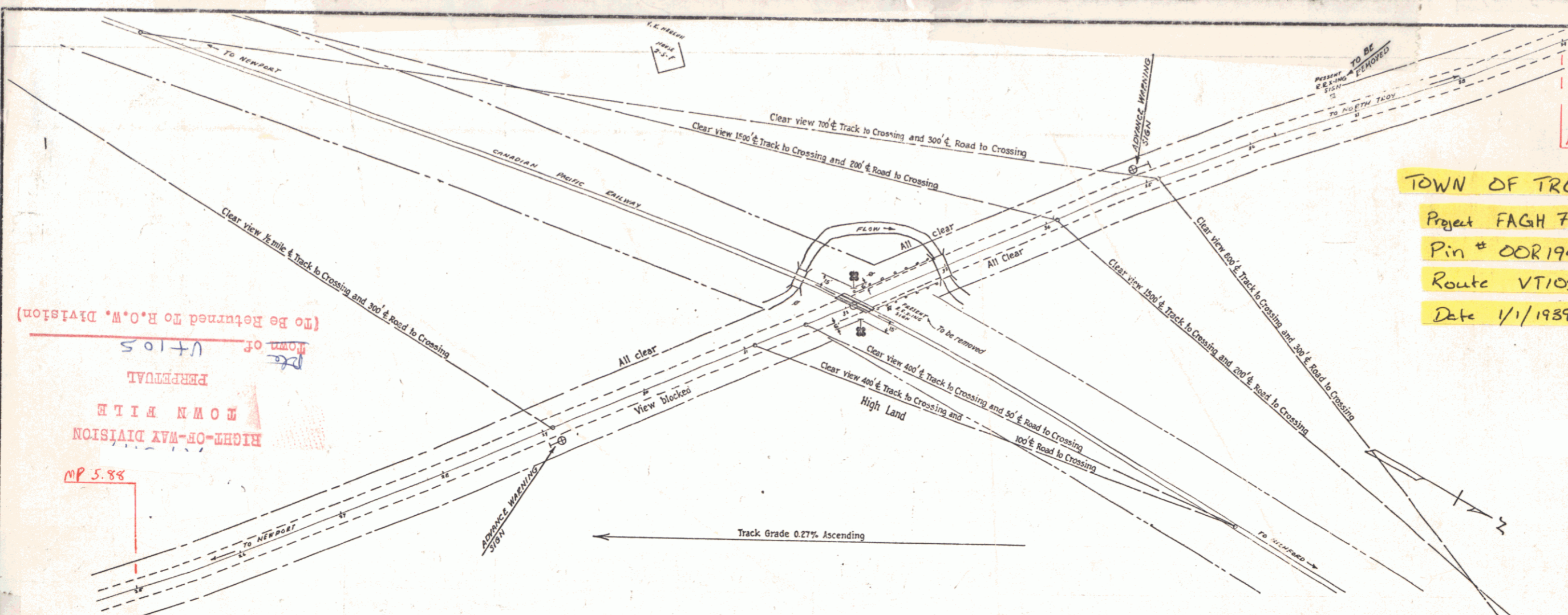

- R.R. RIGHT OF WAY
- STATE HIGHWAY RIGHT OF WAY
- EDGE OF HIGHWAY
- ⊙ ADVANCED WARNING SIGN
- ⊙ FLASHING LIGHT SIGNAL

STATE OF VERMONT
 STATE HIGHWAY DEPARTMENT
 PLAN OF PROPOSED
 GRADE CROSSING PROTECTION PROJECT
 ORLEANS COUNTY
 AID GRADE CROSSING PROJECT NO F.A.G.H. 71-C
 AT INTERSECTION OF CANADIAN PACIFIC RAILWAY AND ROUTE
 THE TOWN OF TROY AT MILEAGE STATION 32+07.

APPROVED: *J. G. [Signature]*
 ENGINEER MAINTENANCE OF WAY
 CANADIAN PACIFIC RAILWAY

APPROVED: *H. [Signature]*
 COMMISSIONER OF HIGHWAYS

STATE OF VERMONT
 STATE HIGHWAY DEPARTMENT
 PLAN OF PROPOSED
 GRADE CROSSING PROTECTION PROJECT
 ORLEANS COUNTY
 AID GRADE CROSSING PROJECT NO F.A.G.H. 71-C
 AT INTERSECTION OF CANADIAN PACIFIC RAILWAY AND ROUTE
 THE TOWN OF TROY AT MILEAGE STATION 32+07.

DATE: 1/1/89
 DRAWN BY: [Signature]
 CHECKED BY: [Signature]

02/13/89
 [Signature]

Surveyed by: M. N. D.
 Designed by: [Signature]
 Drawn by: D. W. P.
 Traced by: [Signature]
 Checked by: [Signature]
 Series: A.G.H. No. 71-C
 Sheet 7 of 3

VT 105