

INDEX OF SHEETS

1.	Title Page	
2-3.	Typicals	
4.	Quantity and Drainage	
5.	Earthworks and Grade	
6.	Right-of-Way Detail	
7-8.	Plan and Profile	
9.	20 Scale	
10.	Blank	
11.	B-1 Banking Tables	7/17/67 R
12.	C-1 Corps	9/10/69 R
13.	D-6 HGI w/Grate for use in Ditches	12/21/66
14.	D-11 Details of Grates and Covers	12/2/69 R
15.	E-13 State Route Markers and Aux. Markers	8/28/64 R
16-19.	Blank	
20.	E-31 Fed. Aid Const. Identification Signs	8/21/67 R
21.	E-32 Road Construction Approach Signs	1/6/67
22.	E-34 On-Project Construction Signs	5/3/67 R
23.	E-36 Road Const. Signs Betterment Projects	1/24/68
24.	G-3 Three C.S.R. w/Std. Posts, Item 542 Anchors, Item 544	9/1/66 R
25.	G-4 Wood and Steel Marker Posts	12/30/65 R
26.	J-1 Boundary Markers, Item 567	3/10/65
27-29.	Blank	
30-32.	Vt. 100 Cross Sections	
33-34.	Vt. 105 Cross Sections	
35-37.	Ramp Cross Sections	

STATE OF VERMONT  
DEPARTMENT OF HIGHWAYS  
PROPOSED IMPROVEMENT

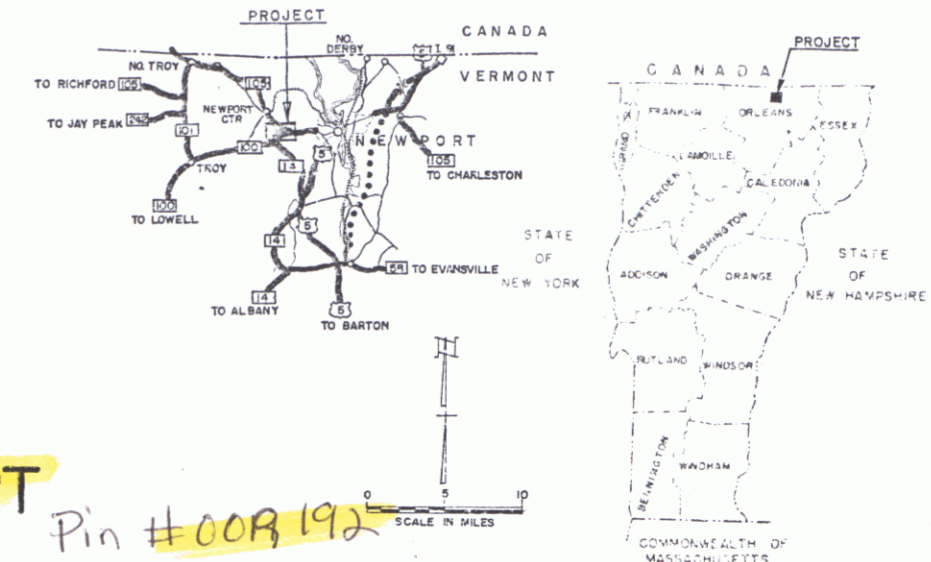

TOWN OF NEWPORT  
COUNTY OF ORLEANS  
JCT. OF VT. ROUTES 100 & 105  
TROY-NEWPORT ROAD

Pin #008192

BEGINNING AT A POINT 3.869 MILE NORTHEASTERLY OF THE TROY-NEWPORT TOWN LINE AND EXTENDING NORTHEASTERLY 0.1610 MILE.

PROJECT NAME & NUMBER TYPE PAVEMENT AREA.  
NEWPORT RF 029-2(1) BIT. CONC. PAVT. 2,068 S.Y.  
RECORD PLANS

LENGTH OF PROJECT 850 FEET + 0.1610 MILE

VT. 100	
ADT 1967	2100
ADT 1987	3500
DHV 1987	320
D	5% 8%
T	50 MPH

SUBBASE OF GRAVEL—MRS ALICE PERCEY PIT—NEWPORT, VT.  
CRUSHED GRAVEL OR CRUSHED STONE PLANT MIXED BASE COURSE & BITUMINOUS CONCRETE—L.M. PIKE PLANT—NEWPORT, VT.  
TACK COAT TYPE III—MCEL GIL CO.—ALBANY, N.Y.  
STONE GRITS—WATERLOO MARBLE—SO. STUCKLEY, QUE.  
CONCRETE CLASS B—CALKINS READY MIX CONCRETE—COVENTRY, VT.  
REINFORCING STEEL—ALLEN LUMBER CO. (BELGIUM)—ST. JOHNSBURY, VT.  
REINFORCED CONCRETE PIPE, GRAINITE SLOPE EDGING, GUARD RAIL & EROSION CONTROL ITEMS—S.T. GRISWOLD & CO., INC.—WILLISTON, VT.  
METAL CULVERT PIPE—NEW ENGLAND METAL CULVERT CO.—WHITE RIVER JCT., VT.  
CAST IRON GRATES—E.L. LEBARON FOUNDRY CO.—BROCKTON, MA.

CONTRACTOR—LEO & ROLAND LAPERLE, DBA LAPERLE CONSTR. CO. ST. JOHNSBURY, VT.  
RES. ENG.—MARK G. HUTCHINS.  
RECORD PLANS—A.G. SPIDLE.

CONTRACT DATED—JANUARY 15, 1971.  
STARTED—MAY 5, 1971.  
COMPLETED—JULY 29, 1971.  
ACCEPTED—JULY 29, 1971.

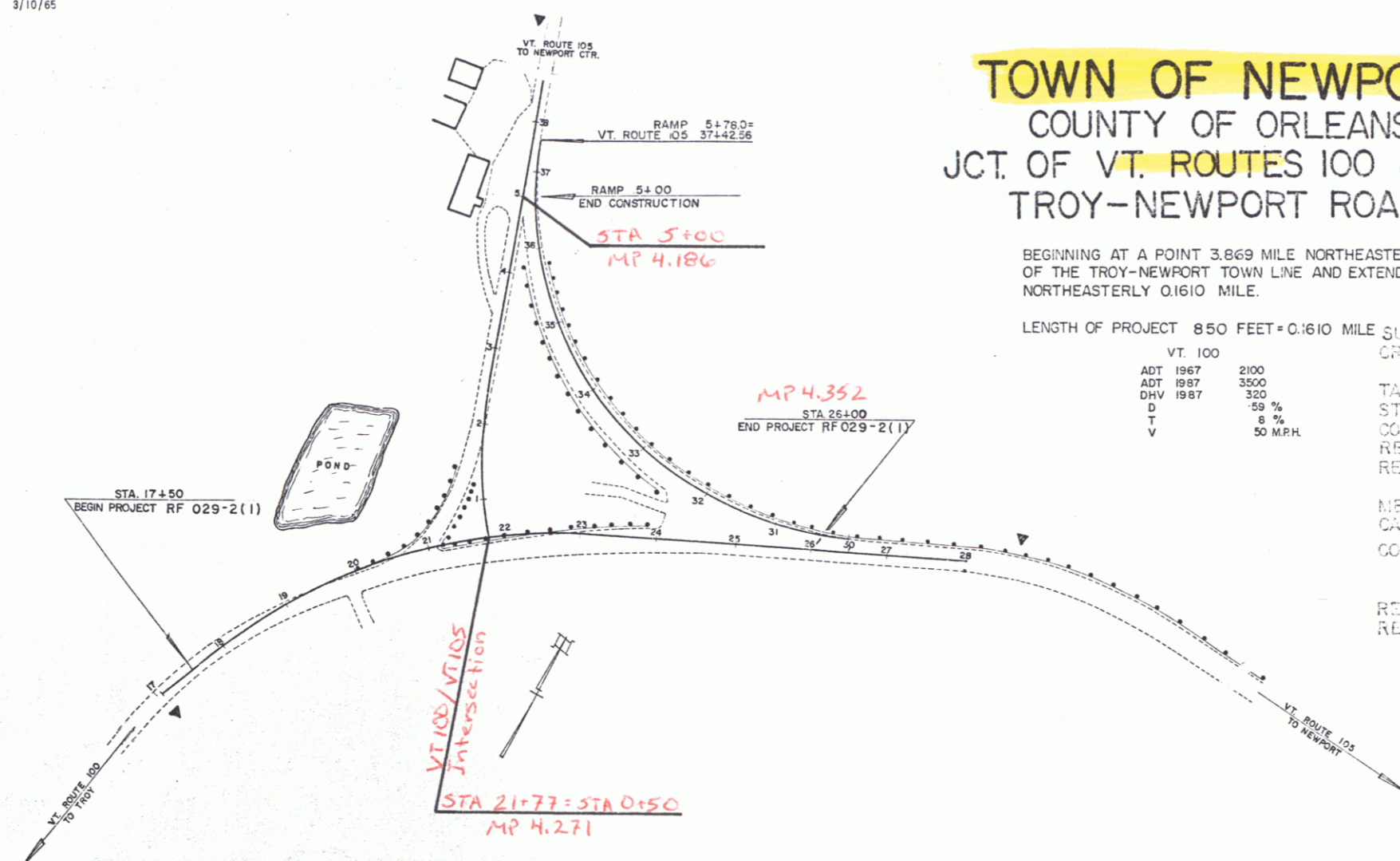

CONVENTIONAL SIGNS

POINT OF ACCESS	X
LIMITS OF ACCESS	---
COUNTY LINE	---
TOWN LINE	---
FENCE LINE	---
STONE WALL	---
UNFENCED PROPERTY	---
GUARD RAIL	---
TRAVELED WAY	---
RAILROAD	---
RETAINING WALL	---
CENTER LINE	---
SURVEY LINE	---
CULVERT	---
DROP INLET	---
TROUBLELY HOLE	---
POWER POLES	---
TELEPHONE POLES	---
TREES	---
ROCKS	---
F.A. CONSTRUCTION IDENTIFICATION SIGNS	---

NEWPORT - RF 029-2(1)  
CONTRACTOR - LEO & ROLAND LAPERLE, DBA LAPERLE CONSTR. CO. ST. JOHNSBURY, VT.  
CONST. COMPLETED JULY 29, 1971.

SLOPE RIGHTS	SR
GROUND ELEVATION	---
GRADE ELEVATION	---
CURVE DATA	---
DEFLECTION OF ANGLE	Δ
DEGREE OF CURVE	D
RADIUS OF CURVE	R
TANGENT DISTANCE	T
LENGTH OF CURVE	L
EXTERNAL DISTANCE	E
POINT OF INTERSECTION	PI
POINT OF CURVE	PC
POINT OF TANGENT	PT
POINT ON SUB-TANGENT	PST
POINT ON CURVE	---

FOR RIGHT OF WAY DETAILS, SEE RIGHT OF WAY PLANS FOR THIS PROJECT.

APPROVED DATE 18 April 1971	APPROVED DATE 19 Oct 70	APPROVED DATE 10/13/70	APPROVED DATE 4/14/67	APPROVED DATE 4/21/67	APPROVED DATE 4/24/67
--------------------------------	----------------------------	---------------------------	--------------------------	--------------------------	--------------------------

NOTE: ANY FURTHER INFORMATION CONCERNING FINAL QUANTITIES, METHODS OR OTHER DETAILS RELATIVE TO THIS PROJECT MAY BE FOUND IN EITHER THE FIELD BOOK OR THE ESTIMATE FILE.

DEPARTMENT OF TRANSPORTATION  
FEDERAL HIGHWAY ADMINISTRATION

APPROVED \_\_\_\_\_ DATE \_\_\_\_\_

PROJECT RF 029-2(1)

SHEET 1 OF 37 SHEETS

STATE OF VERMONT  
DEPARTMENT OF HIGHWAYS  
RIGHT-OF-WAY PLANS  
DETAIL SHEET  
/ OF /

TABLE OF PROJECT PROPERTY ACQUISITION

PARCEL NO.	GRANTOR	SHEET NO.	BEGINNING STATION	ENDING STATION	TAKING	REM.	RIGHTS	TITLE TAKEN	DATE	TOWN OR CITY RECORDED	BK.	PG.	REMARKS
1	HILLIKER, MYRL S. & LORETTA L.		16+50	27+25	5.3A±		DRAINAGE (P) SLOPE (1307'') (T) WATER PIPE LINE SLOPE (1089'') (T) SLOPE (9200'') (T) DRIVE (T) DRAINAGE (P) SLOPE (2614'') (T)						
			2+00 Lt										
			3+50 Lt										
			5+00										
			17+46 Rt										
			17+50 Lt										
			19+90 Rt										
			20+77 Lt										
2	LUNNA, HENRY C. & LORETTA A.		32+35 Lt	27+25 Lt	0.45A±		SLOPE (1307'') (T)						
			31+70 Rt	32+35 Rt									

TABLE OF REVISIONS

REVISION NO.	SHEET NO.	DESCRIPTION OF REVISION	DATE	MADE BY	APPROVED BY

MADE BY: RPD DATE 4-17-67  
CHECKED BY: \_\_\_\_\_ DATE \_\_\_\_\_

\_\_\_\_\_ PRESENT R.O.W.  
 - - - - - TAKING WITHOUT ACCESS  
 - - - - - TAKING WITHOUT ACCESS ALONG PROPERTY LINES  
 - - - - - TAKING WITH ACCESS  
 (P) PERMANENT EASEMENT  
 (T) TEMPORARY EASEMENT

SR - SR SLOPE RIGHTS  
 P - P PROPERTY LINE  
 Δ - Δ TOP OF CUT  
 O - O TOE OF SLOPE

APPROVED \_\_\_\_\_ CHIEF OF ACQUISITION DATE \_\_\_\_\_  
 APPROVED \_\_\_\_\_ HIGHWAY ENGINEER DATE \_\_\_\_\_  
 APPROVED \_\_\_\_\_ R.O.W. DIRECTOR DATE \_\_\_\_\_

PROJECT NEWPORT  
 NO. RF 029-2(1)  
 SHEET 6 OF 37

POOR ORIGINAL COPY

Contract Drive  
1190.21

Vertical Curve Data  
VT 100  
VT 100  
VT 100

Vertical Curve Data  
VT 100  
VT 100  
VT 100

Vertical Curve Data  
VT 100  
VT 100  
VT 100

Bituminous Concrete Surface for Outer of Tenth Island Item 504  
0+70-1+00 Rms. (Horizontal)

Rev Ramp  
Δ 142°34'14" RI  
D 10"  
R 6174.96  
T 83.46  
L 105.71  
E 116.94

Surv Ramp  
Δ 17°52'21"  
D 10"

VT 105  
Δ 96°52'22"  
D 13"  
R 44074  
T 194.00  
L 742.56  
E 221.26

26400  
En+Project

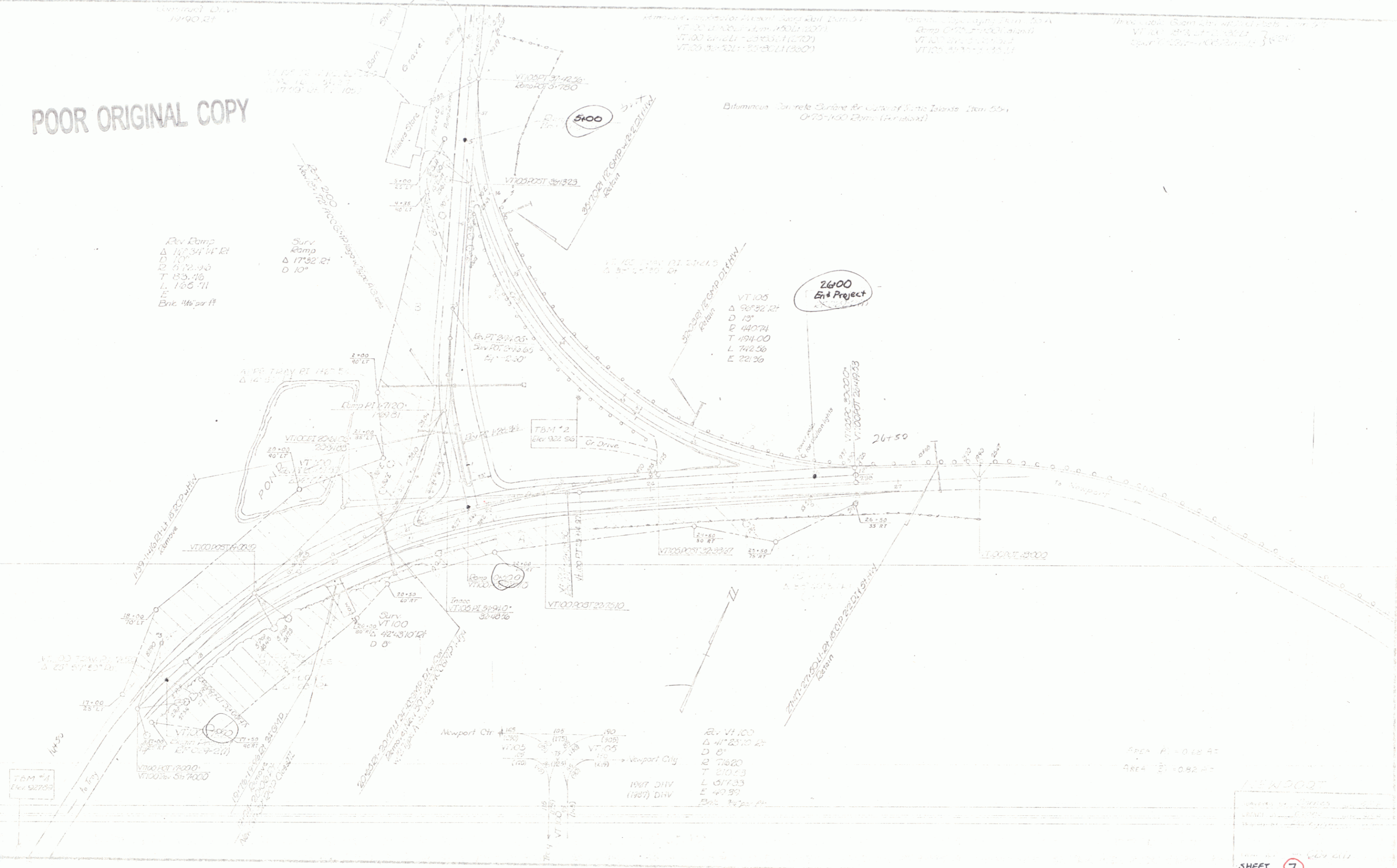

TBM #4  
Elev 927.55

Newport Ctr  
1185

Newport City  
1187

26410  
Δ 41°25'12" RI  
D 8"  
R 71820  
T 210.53  
L 517.33  
E 49.39

AREA A = 0.62 AC  
AREA B = 0.82 AC

NEWPORT  
SHEET 7



RAMP CURVE (SURV.)  
 Δ 17° 32' RT  
 D 10'  
 R 572.96  
 T 86.36  
 L 175.33  
 E 6.79

RAMP CURVE (REV.)  
 Δ 16° 34' 14" RT  
 D 10'  
 R 572.96  
 T 83.46  
 L 165.71  
 E 6.04

Δ 96° 32' RT  
 D 13'  
 R 440.76  
 T 494.0  
 L 742.56  
 E 221.36

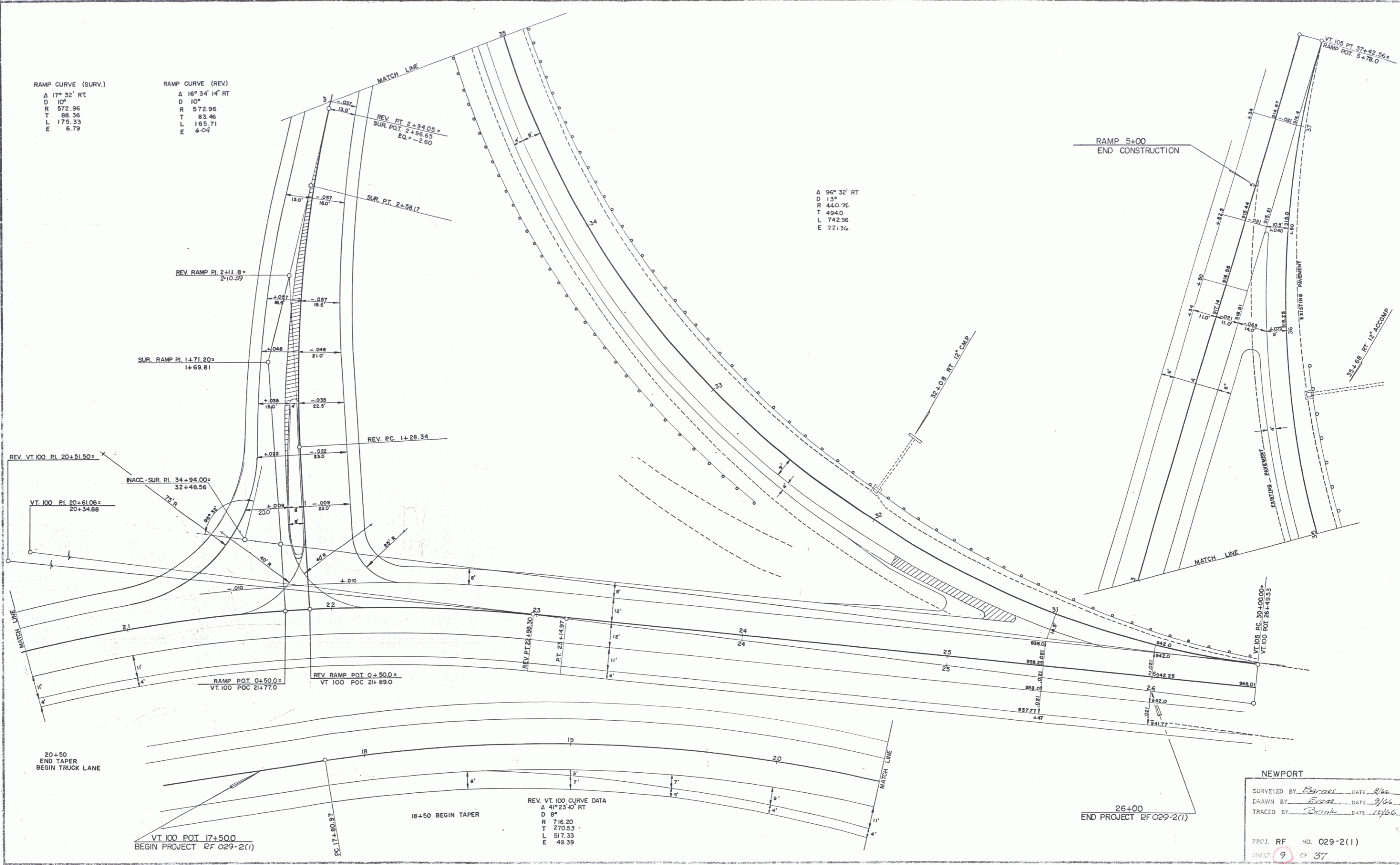

NEWPORT  
 SURVEYED BY Boyer DATE 8/66  
 DRAWN BY Evans DATE 9/66  
 TRACED BY Boyer DATE 10/66  
 PROJ. RF NO. 029-2(1)  
 SHEET 9 OF 37  
 0-7