

- INDEX OF SHEETS
- SHEET NO. 1 TITLE PAGE
  - 2 TYPICAL CROSS-SECTION OF IMPROVEMENT
  - 3 PLAN AND PROFILE STA. 12+00 - 20+00
  - 4-5 BRIDGE 15+50
  - 6-7 CROSS SECTIONS

FED. ROAD DIST. NO.	STATE	FED. AID PROJ. NO.	YEAR	SHEET NO.	TOTAL SHEETS
9	Vt.	77		1	7

STATE OF VERMONT  
STATE HIGHWAY DEPARTMENT

PLAN AND PROFILE OF PROPOSED  
STATE HIGHWAY  
FEDERAL AID PROJECT

TOWN OF FERRINAND Pin# 00R183

ISLAND POND-BLOOMFIELD ROAD  
BEGINNING 1750 FT EAST OF 1<sup>ST</sup>  
RAILROAD CROSSING EAST OF  
WENLOCK STATION AND EXTENDING  
8000 FEET SOUTHERLY



SCALE  
PLAN 1 IN. = 50 FT.  
PROFILE 1/4 IN. = 5 FT.  
CROSS SECTION 1 IN. = 5 FT.

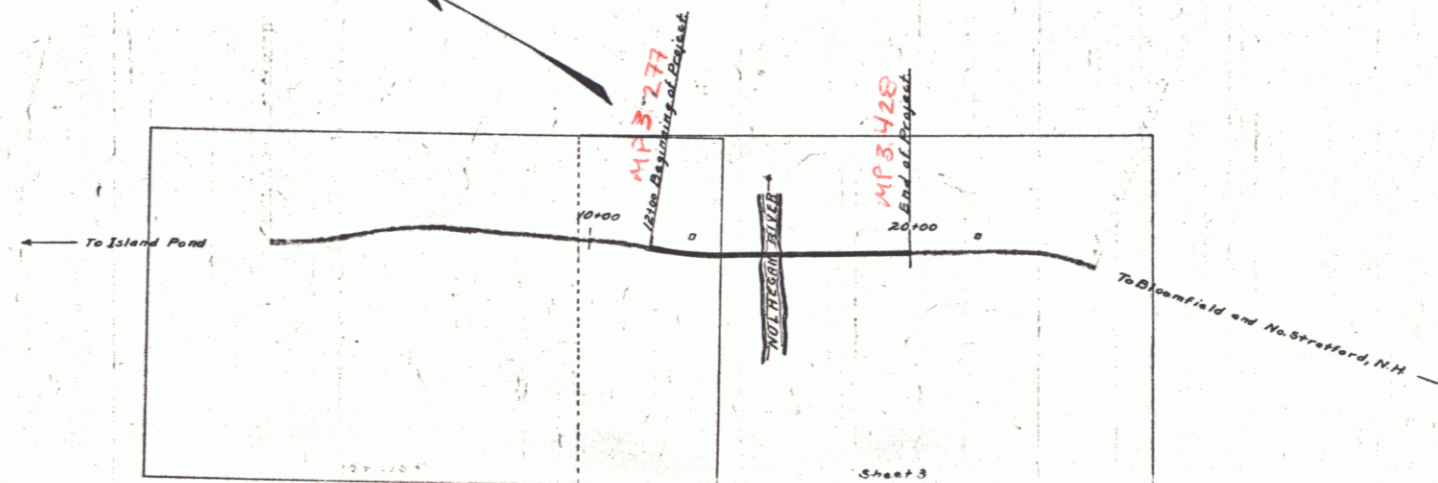

B# 94  
RIGHT-OF-WAY DIVISION  
TOWN FILE  
PERPETUAL  
Town of Ferrinand  
(To Be Returned To R.O.W. Division)

CONVENTIONAL SIGNS

- COUNTY LINE
- TOWN LINE
- FENCE LINE
- STONE WALL
- UNFENCED PROPERTY
- GUARD RAIL
- TRAVELED WAY
- RAILROAD
- RETAINING WALL
- CENTER LINE
- SURVEY LINE
- CULVERT
- DROP INLET
- TROLLEY POLE
- POWER POLE
- TELEPHONE POLE
- TREES
- HEDGE

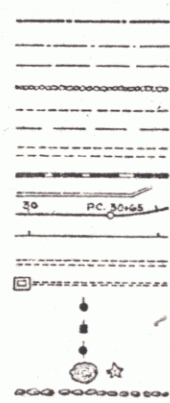

- GROUND ELEVATION
- GRADE ELEVATION
- CURVE DATA
- DEFLECTION ANGLE Δ
- DEGREE OF CURVE D.
- RADIUS OF CURVE R.
- TANGENT DISTANCE T.
- LENGTH OF CURVE L.
- EXTERNAL DISTANCE E.
- POINT OF INTERSECTION P.I.
- POINT OF CURVE P.C.
- POINT OF TANGENT P.T.

LAYOUT  
Scale 1" = 300'

SUBMITTED BY ORDER OF THE STATE HIGHWAY BOARD  
CHIEF ENGINEER  
DEPARTMENT OF HIGHWAYS

Date 6/25/1923

RECOMMENDED  
DISTRICT ENGINEER  
BUREAU OF PUBLIC ROADS  
RECOMMENDED FOR APPROVAL  
CHIEF ENGINEER  
BUREAU OF PUBLIC ROADS  
APPROVED  
DIRECTOR - BUREAU OF PUBLIC ROADS

SERIES F No. 4 FILED  
SHEET 1 OF 7

DIST. # 9 PLANS 1



