

- INDEX OF SHEETS
- SHEET NO. 1 TITLE PAGE
 - 2 TYPICAL CROSS-SECTION OF IMPROVEMENT
 - 3 PLAN AND PROFILE STA. 12+00 - 20+00
 - 4-5 BRIDGE 15+50
 - 6-7 CROSS SECTIONS

FED. ROAD DIST. NO.	STATE	FED. AID PROJ. NO.	YEAR	SHEET NO.	TOTAL SHEETS
9	Vt.	77		1	7

STATE OF VERMONT
STATE HIGHWAY DEPARTMENT

PLAN AND PROFILE OF PROPOSED
STATE HIGHWAY
FEDERAL AID PROJECT

TOWN OF FERRINAND Pin# 00R 183

ISLAND POND-BLOOMFIELD ROAD
BEGINNING 1750 FT EAST OF 1ST
RAILROAD CROSSING EAST OF
WENLOCK STATION AND EXTENDING
800 FEET SOUTHERLY



SCALE
PLAN 1 IN. = 50 FT.
PROFILE 1/4 IN. = 5 FT.
CROSS SECTION 1 IN. = 5 FT.

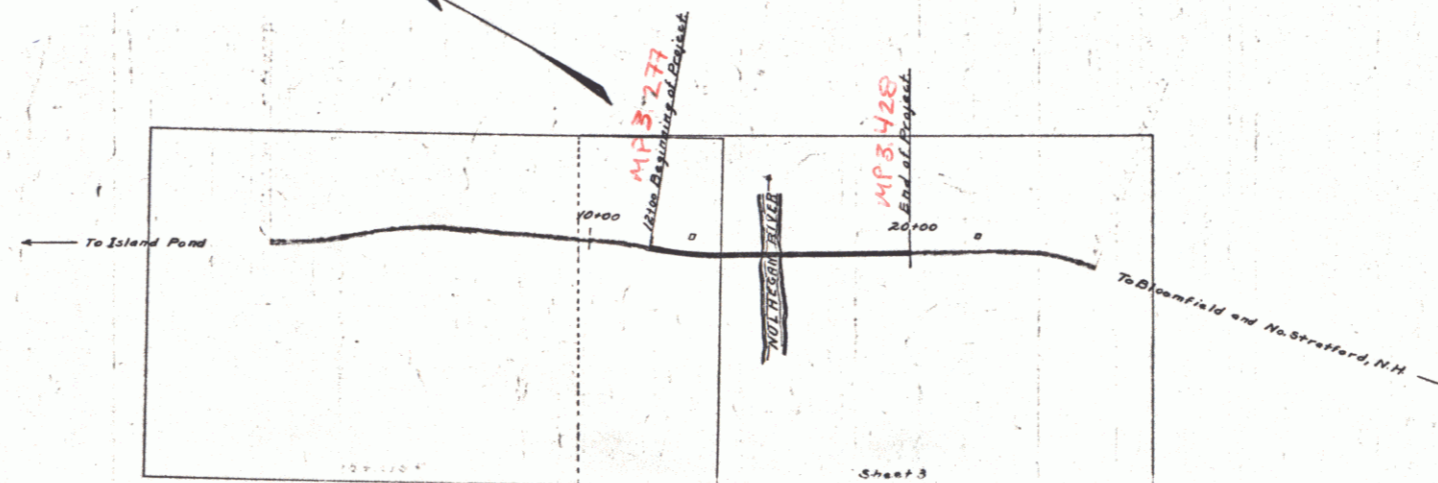

B# 94
RIGHT-OF-WAY DIVISION
TOWN FILE
PERPETUAL
Town of Ferrinand
(To Be Returned To R.O.W. Division)

CONVENTIONAL SIGNS

- COUNTY LINE
- TOWN LINE
- FENCE LINE
- STONE WALL
- UNFENCED PROPERTY
- GUARD RAIL
- TRAVELED WAY
- RAILROAD
- RETAINING WALL
- CENTER LINE
- SURVEY LINE
- CULVERT
- DROP INLET
- TROLLEY POLE
- POWER POLE
- TELEPHONE POLE
- TREES
- HEDGE

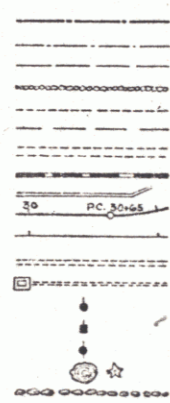

- GROUND ELEVATION
- GRADE ELEVATION
- CURVE DATA
- DEFLECTION ANGLE Δ
- DEGREE OF CURVE D.
- RADIUS OF CURVE R.
- TANGENT DISTANCE T.
- LENGTH OF CURVE L.
- EXTERNAL DISTANCE E.
- POINT OF INTERSECTION P.I.
- POINT OF CURVE P.C.
- POINT OF TANGENT P.T.

LAYOUT
Scale 1" = 300'

SUBMITTED BY ORDER OF THE STATE HIGHWAY BOARD
CHIEF ENGINEER
DEPARTMENT OF HIGHWAYS

Date 6/25/1923

RECOMMENDED
DISTRICT ENGINEER
BUREAU OF PUBLIC ROADS
RECOMMENDED FOR APPROVAL
CHIEF ENGINEER
BUREAU OF PUBLIC ROADS
APPROVED
DIRECTOR - BUREAU OF PUBLIC ROADS

SERIES F No. 4 FILED
SHEET 1 OF 7

DIST. # 9 PLANS 1