

PLAN
 DATE 1908
 DRAWN BY G. W. GANN
 CHECKED BY

PROPOSED
 HIGHWAY
 No. 102
 DATE 1908
 DRAWN BY G. W. GANN
 CHECKED BY

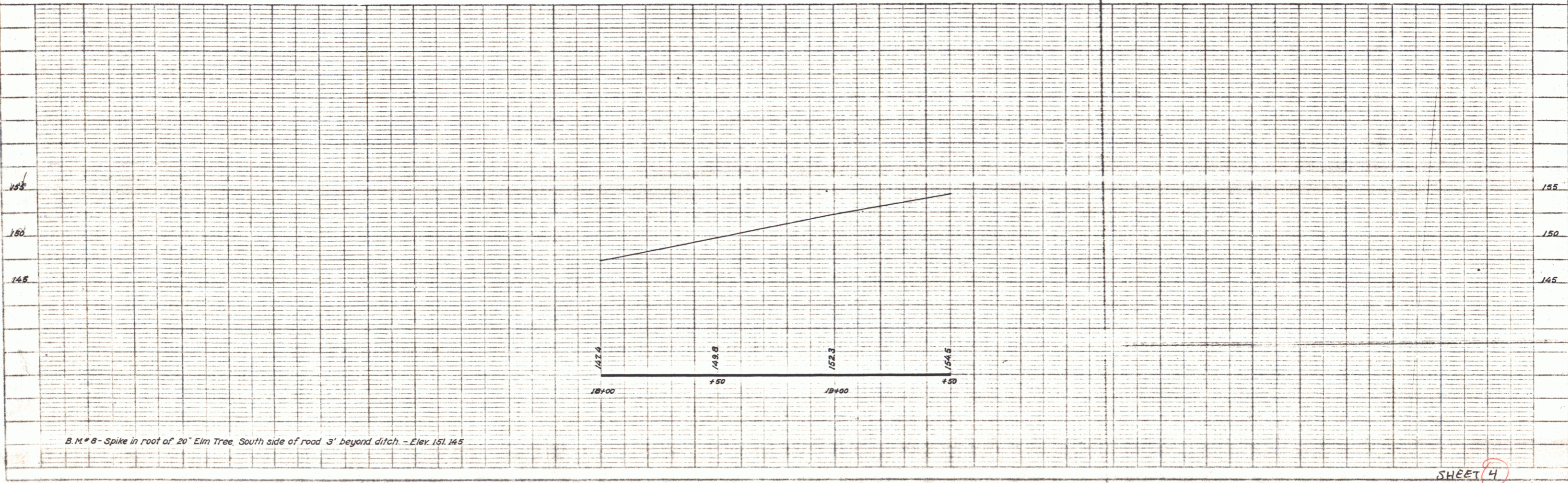
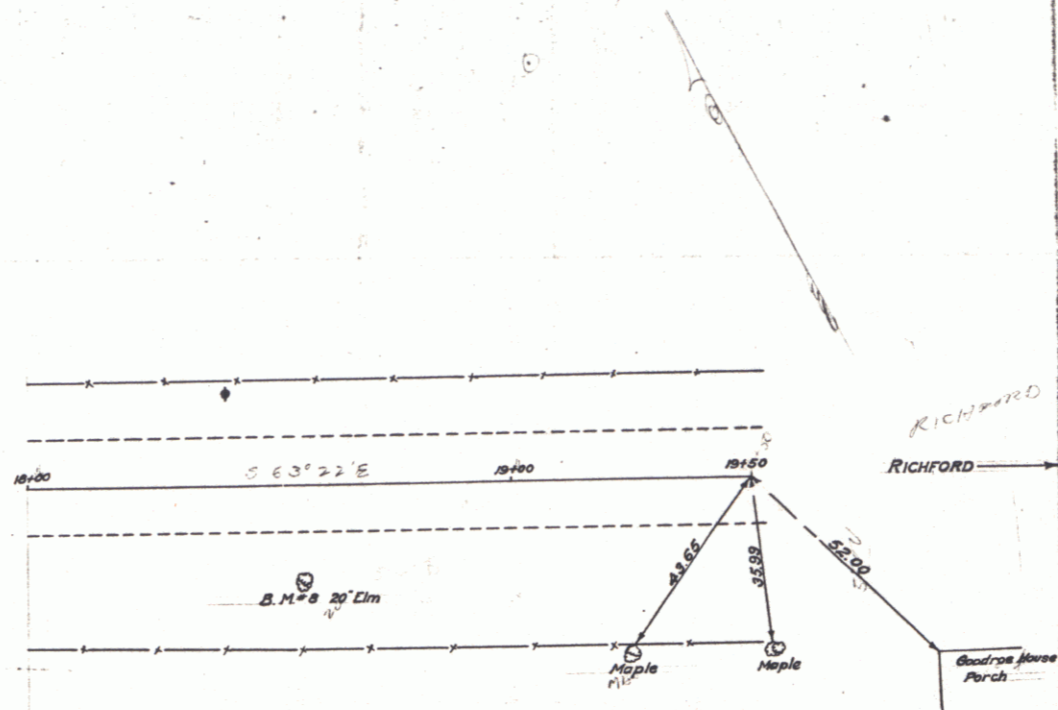

B.M. # 8 - Spike in root of 20' Elm Tree, South side of road 3' beyond ditch. - Elev. 151.143

PLATE 1-PLAN-PROFILE BY G. W. GANN

SHEET 4

6