

WOOD GUARD RAIL REQUIRED

CULVERT STATION	LEFT	RIGHT
4+75	24	24
9+30	24	24

NEW POINT CONC PIPE CULVERTS REQUIRED

STATION	DIAM	LENG	CONC	CRIM.	STEEL GATE
4+75	24"	40'	2.2	29	198"
2+50L - 3+45R	12"	60'	1.4	-	59"
3+30	18"	36'	1.0	-	54"
6+20L	18"	36'	1.0	30	-

CHANGING ELEVATIONS OF MANHOLE & CATCHBASINS

STATION	LEFT	RIGHT	TYPE
2+60	-	6'	M.H.

INDEX OF SHEETS
 Sheets 1-2 Plan and Profile Sheets
 3 Sid. Structure Sheet 3-20
 4 Sid. Structure Sheet 3-22
 5-7 Cross Sections

VT 105 ST. ALBANS

Mile Point
 St. Albans City: 0.00-0.023
 St. Albans Town: 0.00-0.300

Town: St. Albans
 Proj. No. MM 0.00-0.23
 Date: 1/1/31
 Re: VT 105
 Plat# COR 171

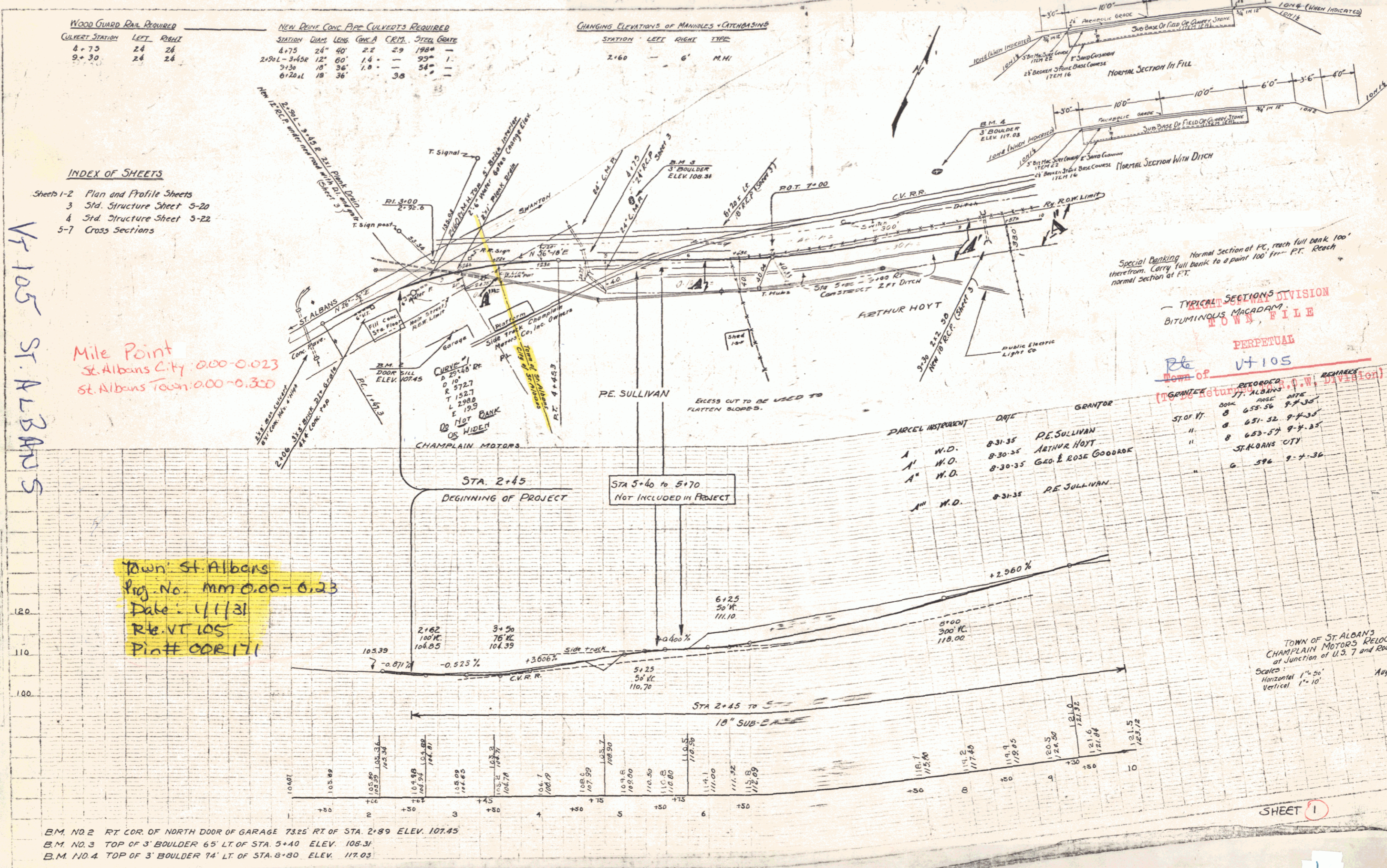

PARCEL INSTRUMENT

DATE	GRANTOR
8-31-35	PE. SULLIVAN
8-30-35	ARTHUR HOYT
8-30-35	Geo. & Rose Goodale
8-31-35	PE. SULLIVAN

TYPICAL SECTIONS DIVISION
 BITUMINOUS MACADAM
 PERPETUAL
 Town of VT 105
 (To Return to P.W. Division)

TOWN OF ST. ALBANS
 CHAMPLAIN MOTORS RELOCATED
 at Junction of U.S. 7 and Route 105
 Scales
 Horizontal 1" = 50'
 Vertical 1" = 10'
 August

B.M. NO. 2 RT. COR. OF NORTH DOOR OF GARAGE 73.25' RT. OF STA. 2+89 ELEV. 107.45
 B.M. NO. 3 TOP OF 3' BOULDER 65' LT. OF STA. 5+40 ELEV. 105.31
 B.M. NO. 4 TOP OF 3' BOULDER 74' LT. OF STA. 8+80 ELEV. 117.03