

PLAN
 SHEET NO. 10
 TOWN OF SHELDON
 1930
 SHEET 20

DATE SHEET
 1930

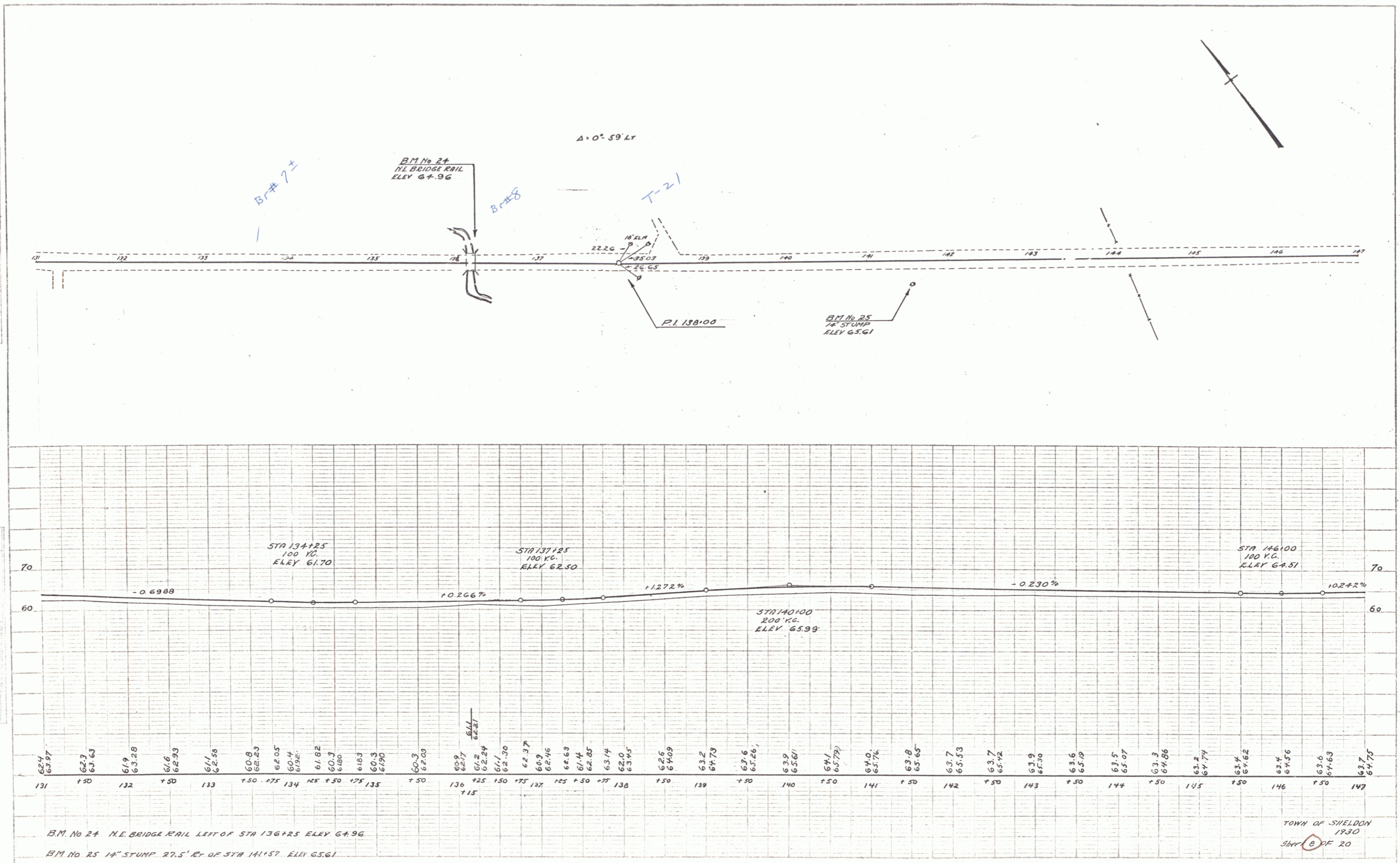

B.M. No 24 N.E. BRIDGE RAIL LEFT OF STA 136+25 ELEV 64.96
 B.M. No 25 14" STUMP 27.5' R. OF STA 141+57 ELEV 65.61

TOWN OF SHELDON
 1930
 SHEET 20