

**NEW CABLE GUARD RAIL REQUIRED**  
 ~ON LEFT~  
 STA 134+85 To STA 137+09 LENGTH 224 LIN. FT.  
 ~ON RIGHT~  
 STA 137+25 To STA 137+97 " 72 " "  
 STA 143+30 To STA 148+06 " 536 " "  
 STA 143+75 To STA 145+03 " 128 " "  
 STA 145+76 To STA 148+00 " 224 " "  
**TOTAL ON SHEET 1184 LIN. FT.**

**NEW WOOD GUARD RAIL REQUIRED**  
 ~ON RIGHT~  
 STA 134+88 To STA 135+12 LENGTH 24 LIN. FT.

**RIP-RAP FOR BANK PROTECTION**  
 WIDTH 62'

**NEW CULVERTS REQUIRED**  
 STA 135+00 & 135+00 NEW 18" R.C. PIPE - LENGTH 32 L.F.  
 REINFORCED CONCRETE CLASS B (1-2 1/2") 31 cu yds  
 REINFORCING STEEL 33 LBS

POSTING	STATION	FOOTING	PIECE	SHEET	TOTAL SHEETS
9	VI	FR20A152B	7	23	

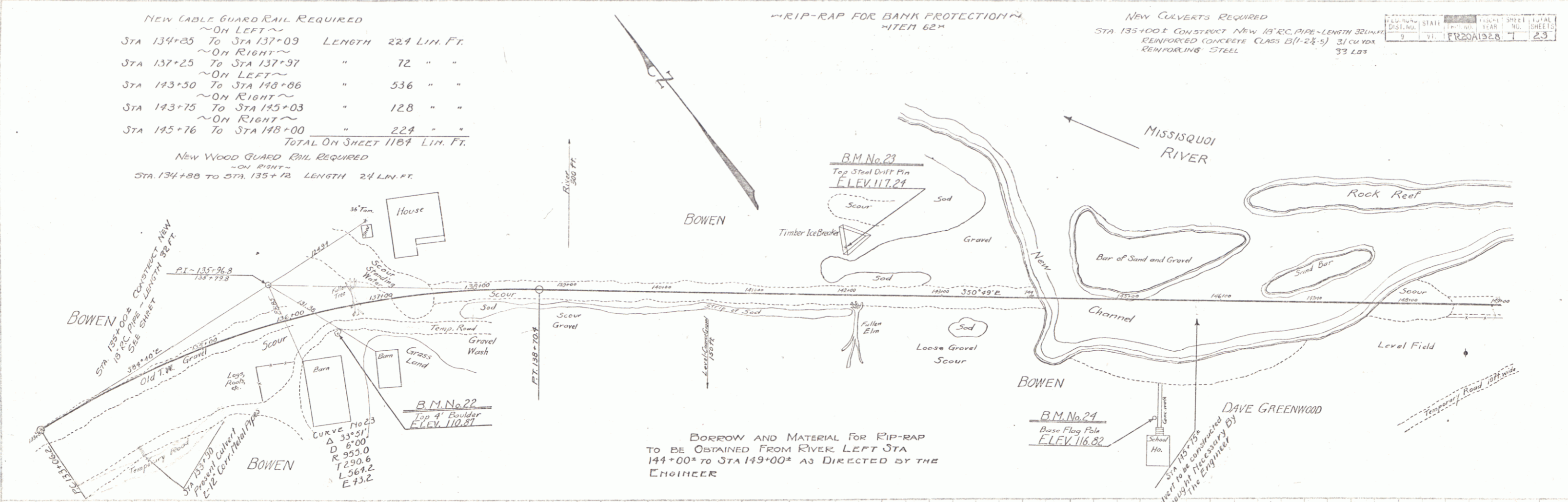

BORROW AND MATERIAL FOR RIP-RAP TO BE OBTAINED FROM RIVER LEFT STA 144+00 TO STA 149+00 AS DIRECTED BY THE ENGINEER

DAVE GREENWOOD  
 STA 135+00  
 New Culvert to be constructed by STA 135+00  
 New 18" pipe to be installed by STA 135+00

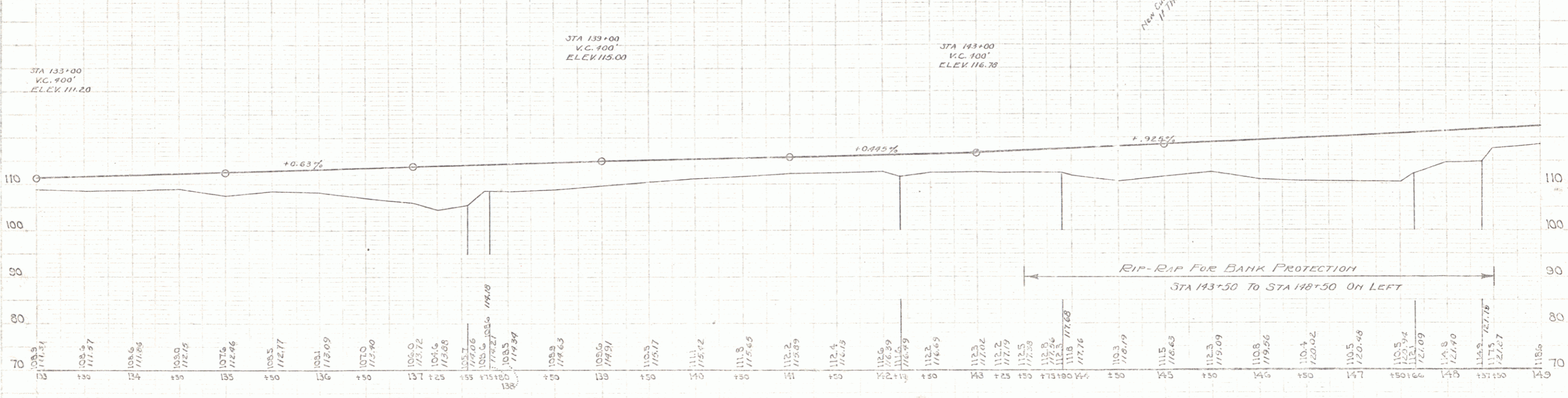

B.M. No. 21 - Foundation Stone S.W. cor. red barn shed Bowen Farm - ELEV. 111.20  
 B.M. No. 22 - Top 4 ft. Boulder between Bowen house and barn - ELEV. 110.87  
 B.M. No. 23 - Top Steel Drift Pin West side timber ice breaker No. side road - ELEV. 117.24  
 B.M. No. 24 - Top Conc. Base Flag Pole at School House - ELEV. 116.82

Series C. No. 204  
 SHEET 7 OF 23