

|                     |       |              |              |              |
|---------------------|-------|--------------|--------------|--------------|
| FED. ROAD DIST. NO. | STATE | PROJECT YEAR | TOTAL SHEETS | TOTAL SHEETS |
| 9                   | VT    | 1928         | 4            | 23           |

NEW WOOD GUARD RAIL REQUIRED  
 ~ON LEFT~  
 STA 97+39 TO STA 97+63 LENGTH 24 LIN. FT.  
 ~ON RIGHT~  
 STA 97+39 TO STA 97+63 " 24 " "  
 TOTAL ON SHEET 48 LIN. FT.

NEW CULVERT REQUIRED  
 STA 97+51 CONSTRUCT NEW BOX CULVERT 4'-3"  
 REIN. CONCRETE CLASS A (12"x12") 16 Cu. Yds.  
 REIN. STEEL 1038 LBS.

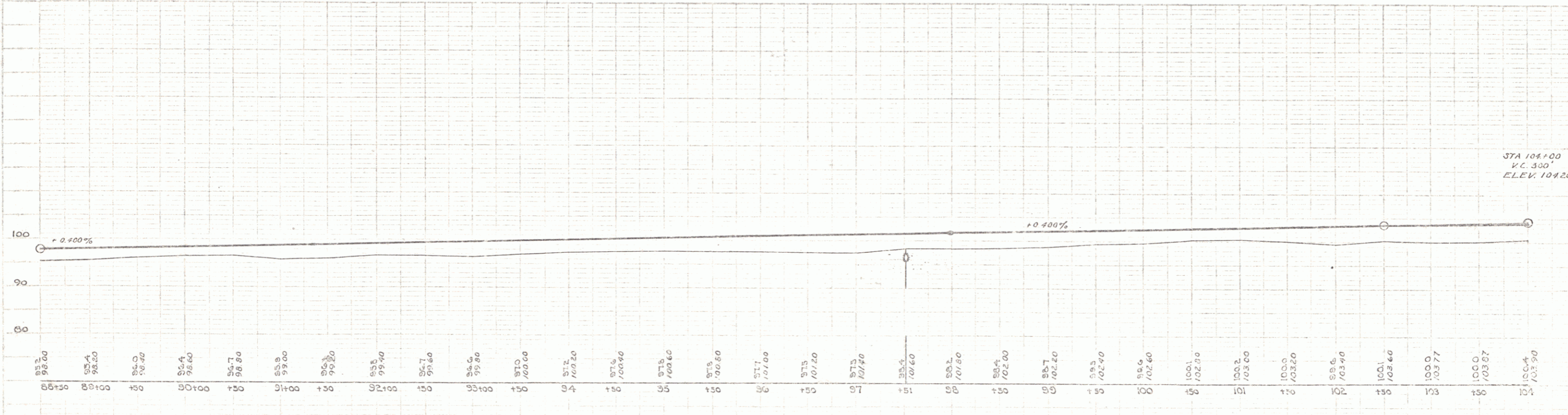
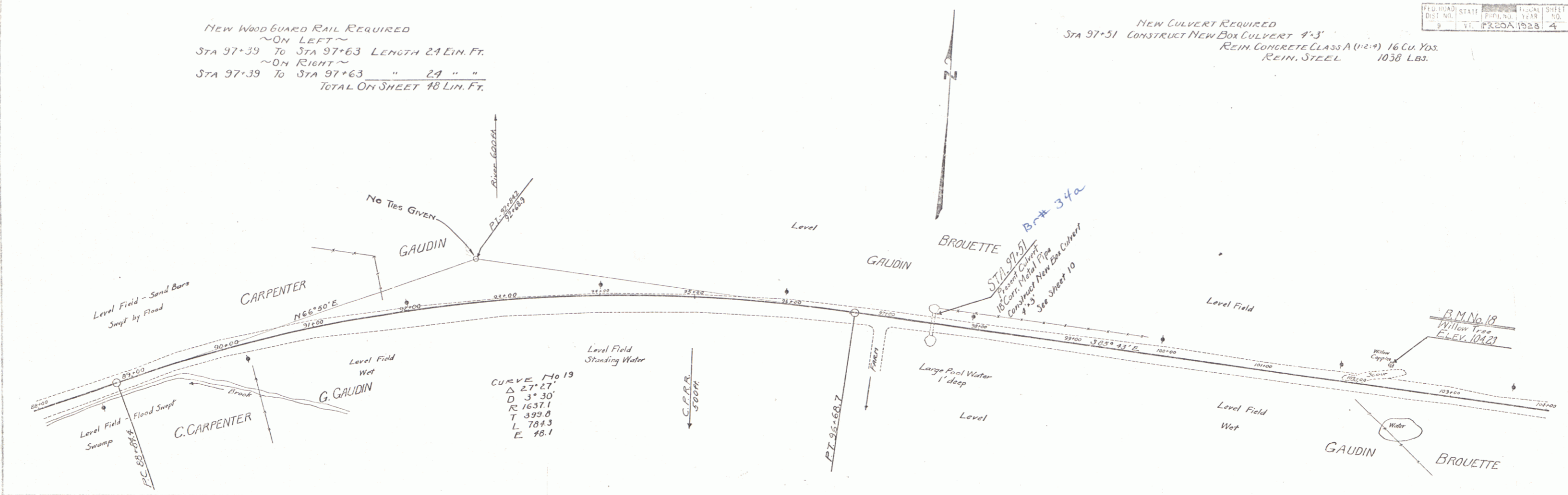

B.M. No. 17 - Spike in 5" Birch Left of Sta. 89+00± - ELEV. 98.10  
 B.M. No. 18 - Spike in 4" Willow No. of road - ELEV. 104.23

Scale - P. No. 20A  
 SHEET 4 OF 23