

GUIDE POSTS OF WOOD

STATION	LEFT	RIGHT
203+00	1	
214+00	1	
216+58	2	
218+30	1	

RESET CABLE GUARD RAIL
 STA. TO STA. LORR LENG
 203+11 - 211+71 RT 1136

REINFORCED CONCRETE PIPE CULVERTS

STATION	SIZE	LENG	CONC	CEM	BLK	STEE
210+66	18" 36"	157'	1.5C	15	157'	
213+95	24" 36"	27'	1.5C	27	93'	
216+56	24" 44"	27'				

CULVERT REPAIRS

STATION	TYPE	REPAIRS	CRM	REINF	STEE
203+00	18"	EXTEND 42.15'			

134-L 1932 18 90

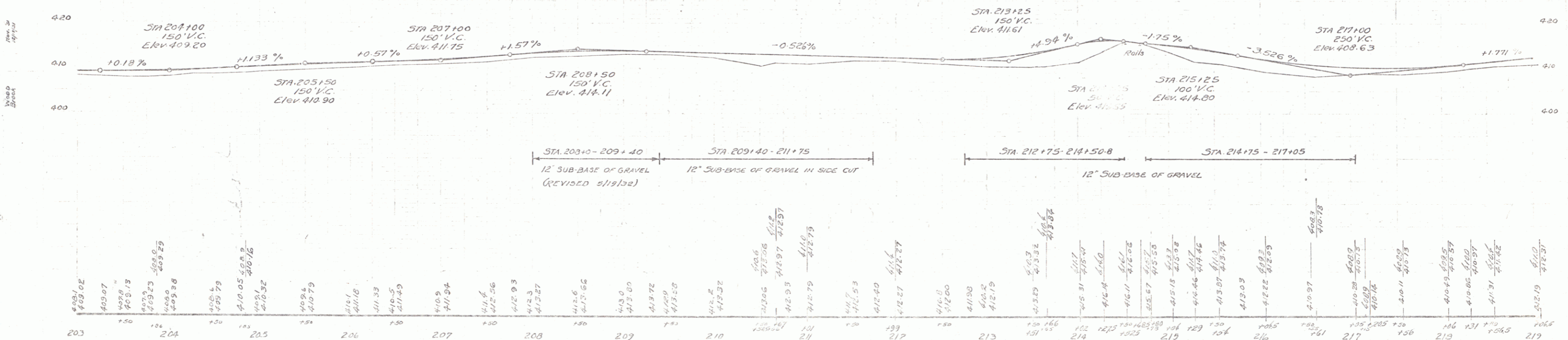
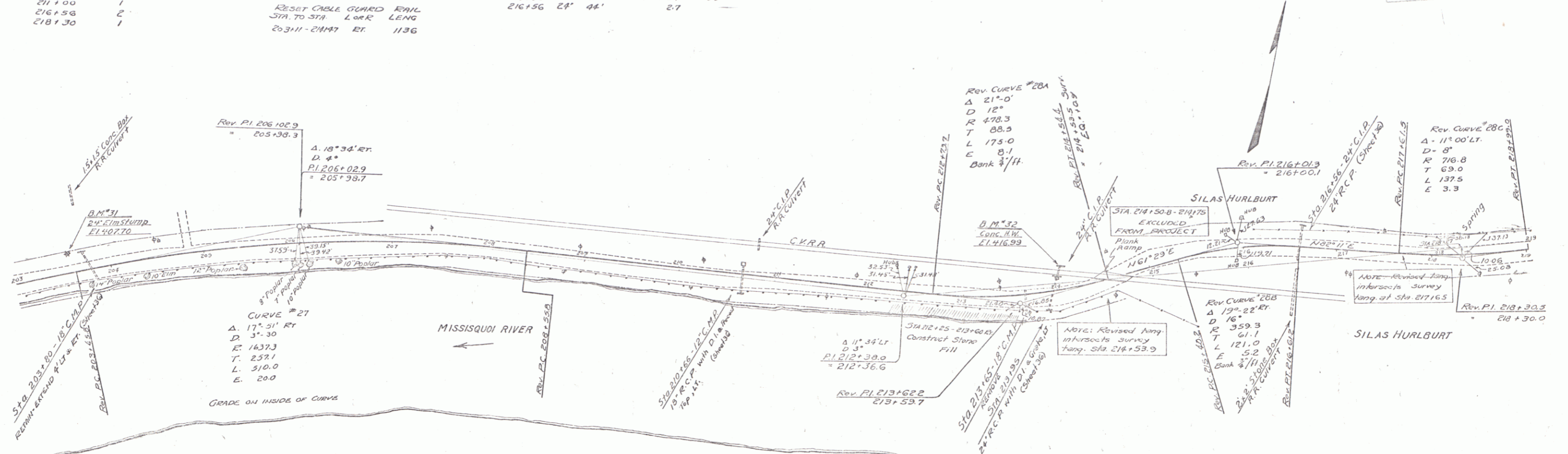

STA. 203+0 - 209+40 12" SUB-BASE OF GRAVEL (REVISED 5/19/32)
 STA. 209+40 - 211+75 12" SUB-BASE OF GRAVEL IN SIDE CUT
 STA. 212+75 - 214+50+8 12" SUB-BASE OF GRAVEL
 STA. 214+75 - 217+05

B.M. #31 SPIKE IN 24" BLMSTUMP/BLT. STA. 203+58. ELEV. 407.70

B.M. #32 PAINT SPOT ON CONC. HEAD WALL OF RR. CULV. 26 FT. STA. 213+00. ELEV. 412.99

SERIES F No. 133-L
 SHEET 18 OF 90