

Parcel #1 Hazel M. Starr
 Beg. Sta. @ 14+50 Rt. - End Sta. @ 20+92 Rt.
 Taking .60 A±

Parcel #2 Lamoille County Bank
 Beg. Sta. @ 20+00 Lt. - End Sta. @ 21+00 Lt.
 Taking .15 A±

Parcel #3 David D. & Benning B. Garrison
 Beg. Sta. @ 20+57 Lt. - End Sta. @ 25+63 Rt.
 Taking .80 A±

Parcel #4 Jean-Bul & Germaine Bonneau
 Beg. Sta. @ 25+57 Rt. - End Sta. @ 28+00 Rt.
 Taking 0.19 A±

Parcel #5 Citizens Utilities Company
 Sta. 21+02 Existing Penstock Sleeve
 See Utility Agreement

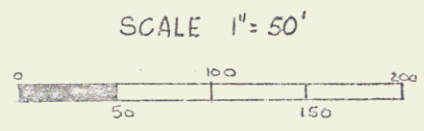
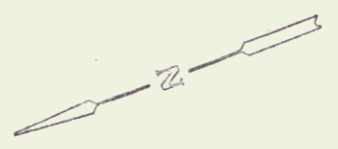
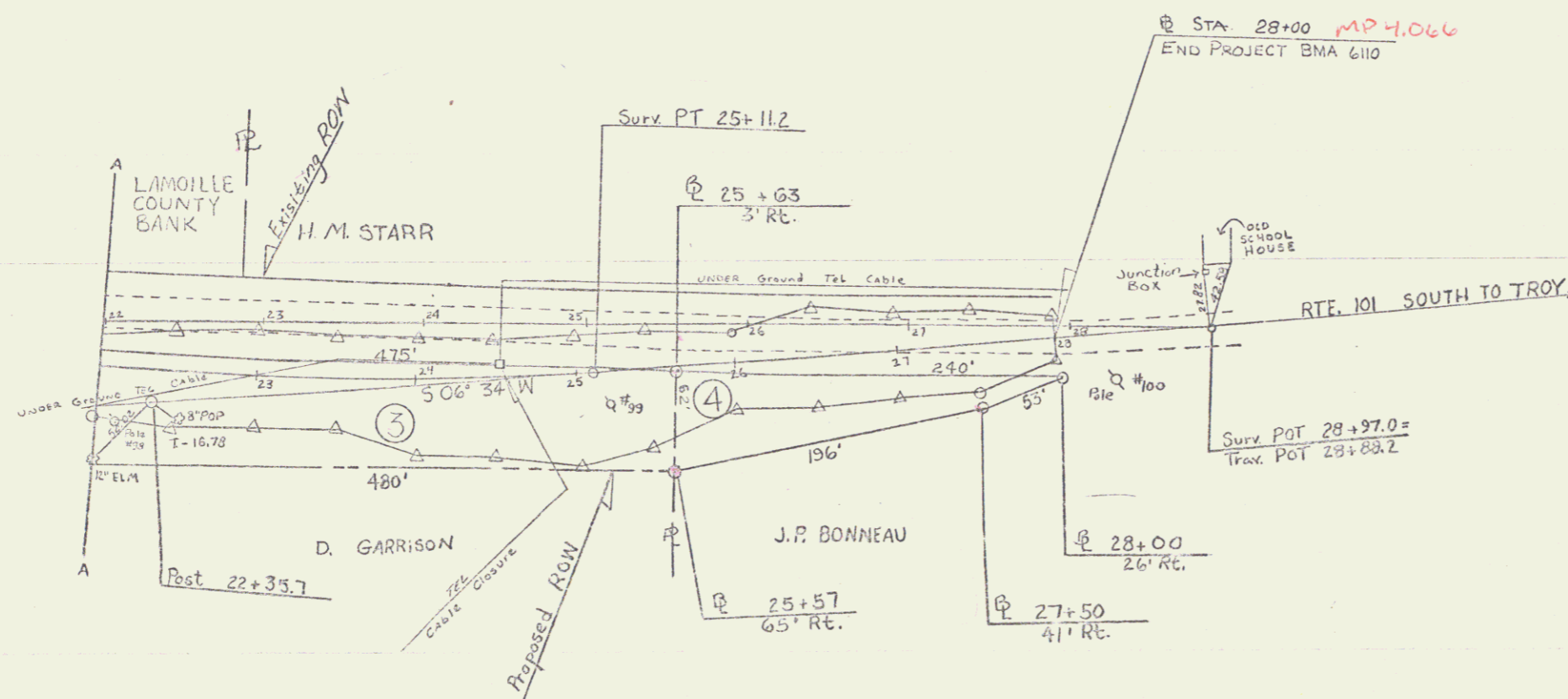

VERMONT DEPARTMENT OF HIGHWAYS
 RIGHT OF WAY PLANS
 PROJECT: VERMONT ROUTE 101
 OVER JAY BRANCH
 BMA 610
 TOWN OF TROY NOVEMBER, 1970
 SHEET 2 OF 2