

Parcel	Kind of Instrument	Date of Grant	Grantee	Recorder's Office	Book	Page	Date	Remarks
B'	G.C.D.	11-30-34	From A.P. Burbank St. of W.	32	284	12-6-34		

NRM  
99B 1935 5 21  
(1935)

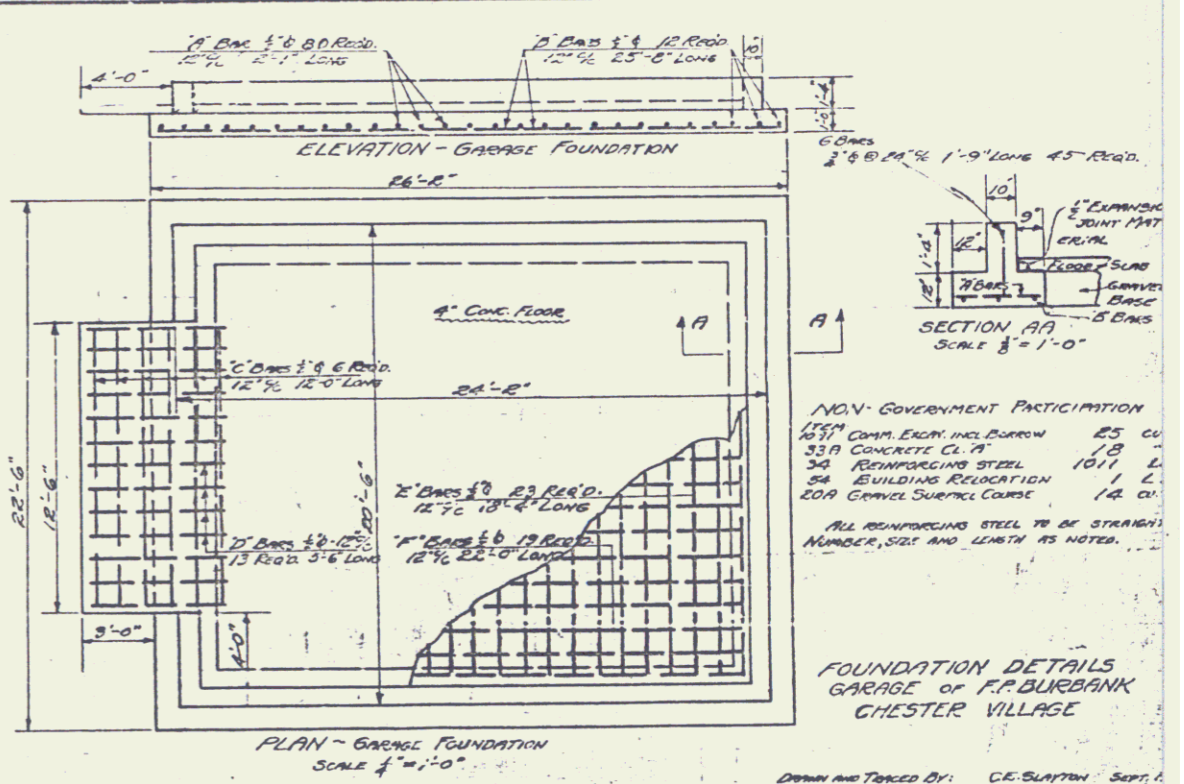
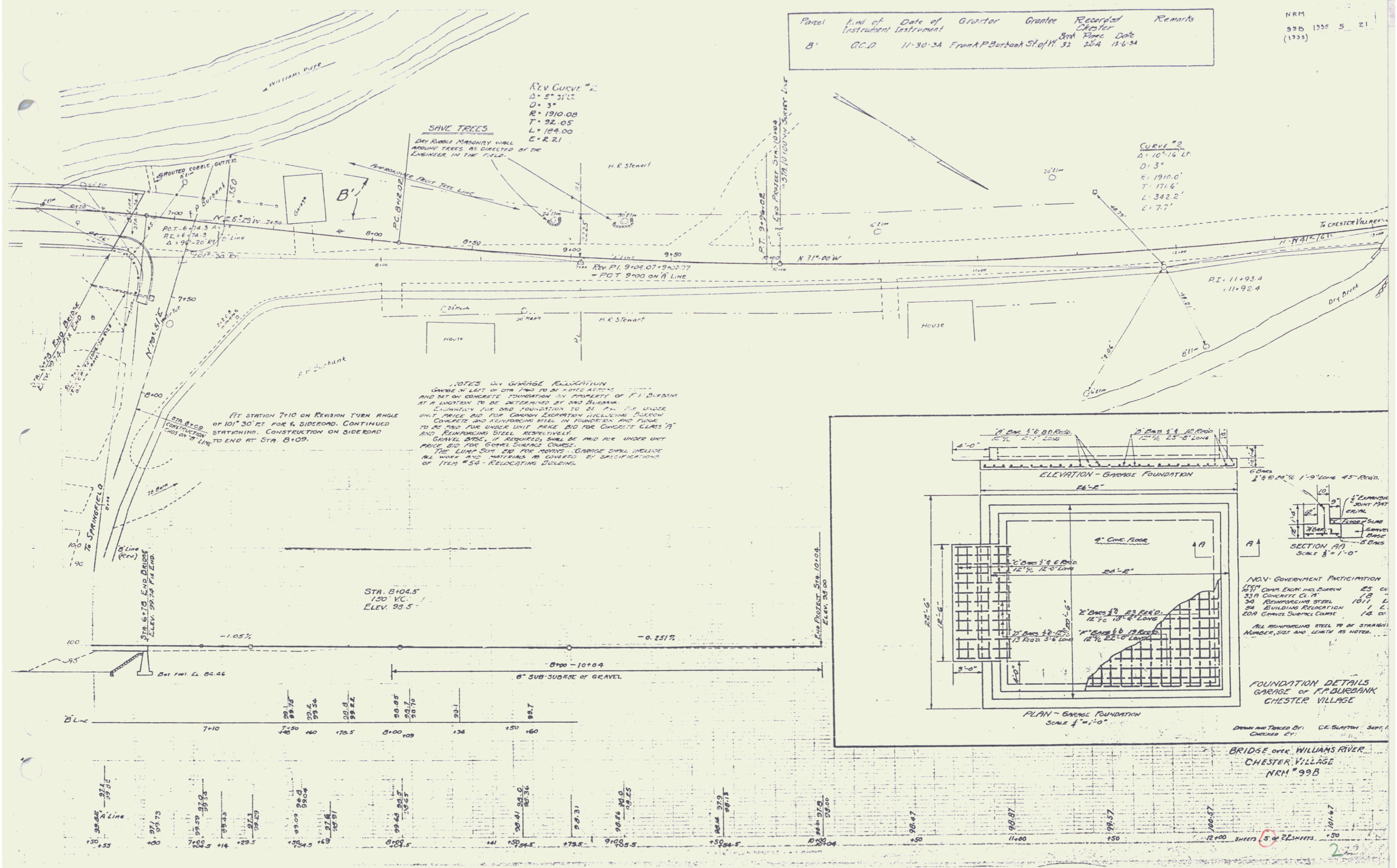

NO. GOVERNMENT PARTICIPATION  
 15% CONN. EXCH. INC. BUREAU 25 CC  
 33% CONCRETE CL. 'A' 12  
 34% REINFORCING STEEL 1011 L  
 54% BUILDING RELOCATION 1 L  
 20% GRAVEL SURFACE COURSE 12 CC

ALL REINFORCING STEEL TO BE STRAIGHT NUMBER, SIZE AND LENGTH AS NOTED.

Drawn and Titled By: C.E. SHAFER Sept. 1  
 Checked By:

BRIDGE OVER WILLIAMS RIVER  
 CHESTER VILLAGE  
 NRM #99B

12x100 SHEETS 5 OF 22 SHEETS