

Stone Fill for Slope Protection Item 522
 565+50 DA
 569+50 DA
 575+00 DA

| C.I. UNDERDRAIN FLUSHING BASIN WITH C.I. COVER - ITEM 530 | | CONSTRUCT DRIVE | |
|---|----|-----------------|----|
| 565+20 | LT | 562+00 | RT |
| 565+34 | LT | 564+50 | RT |
| 569+01 | LT | 572+50 | LT |
| 574+00 | LT | | |
| 575+00 | LT | | |
| 578+00 | LT | | |

Muck Excavation 565+50-569+40 LT

THREE CABLE GUARD RAIL W/STEEL POSTS
 565+92 - 568+00 RT
 565+40 - 568+00 RT

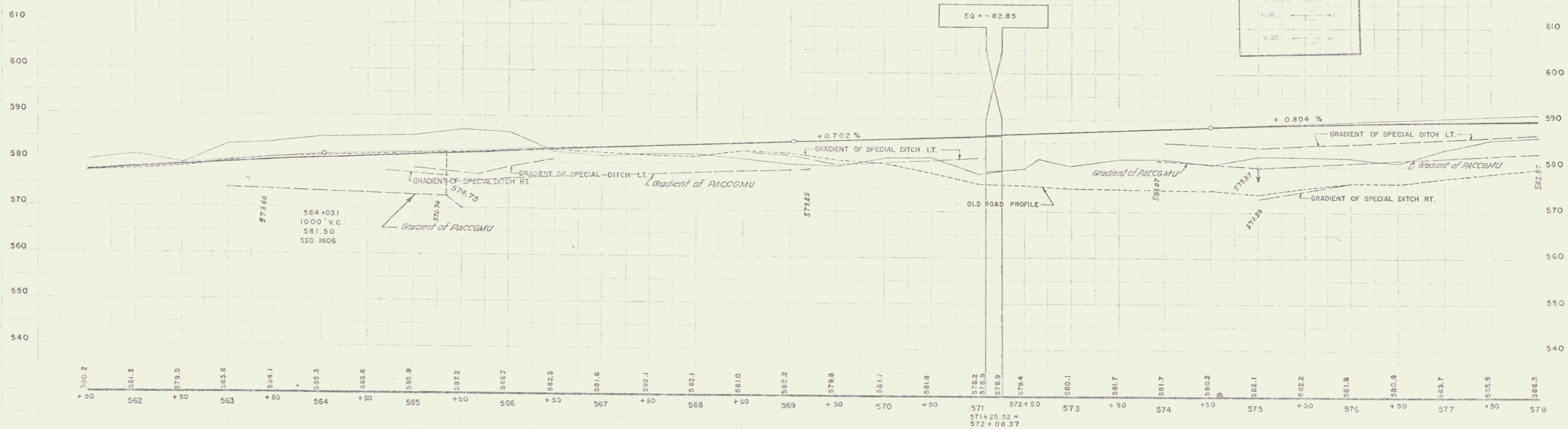
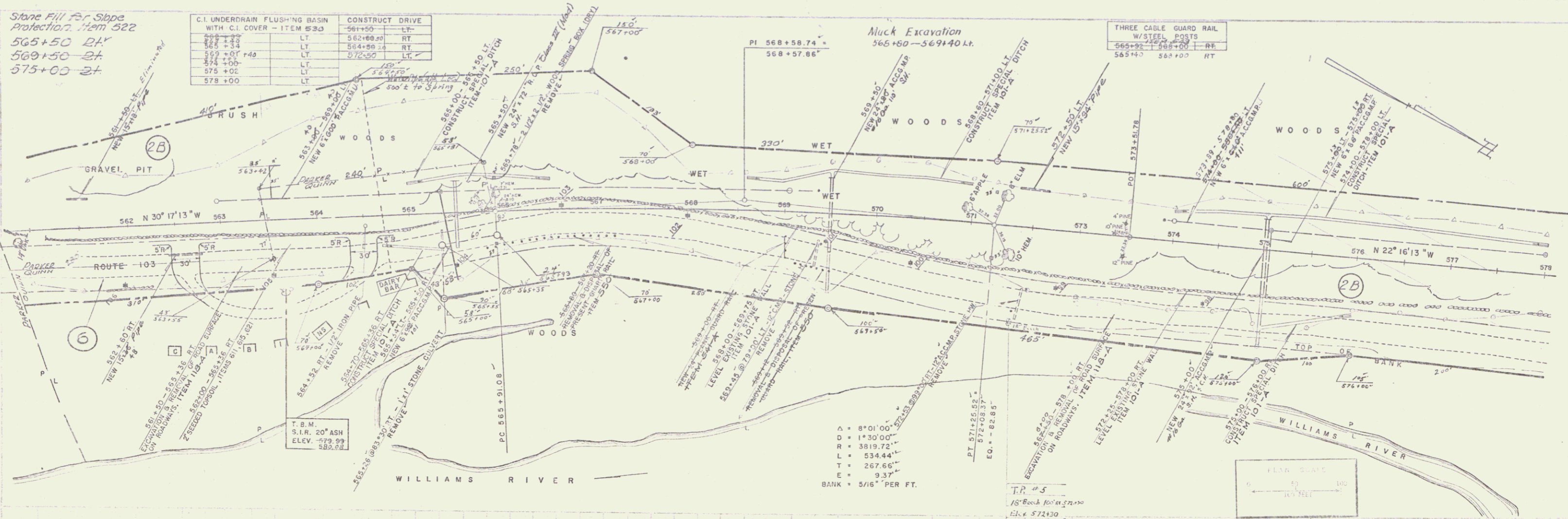

T.B.M. 79' RT. 563+65 S.I.R. 20' ASH ELEV. 579.99

CHESTER PROJECT No. 025-1(15)
 SHEET 73