

GORDON E. ANSICORR & ASSOCIATES
REGISTERED ENGINEERS AND ARCHITECTS

GORDON E. ANSICORR & ASSOCIATES
REGISTERED ENGINEERS AND ARCHITECTS

Δ = 12° 14' 38"
D = 2° 00' 00"
R = 2864.79'
L = 612.19'
T = 307.27'
E = 16.14'
BANK = 7/16" PER FT.

CONSTRUCT DRIVE
536+55 LT
541+50 RT

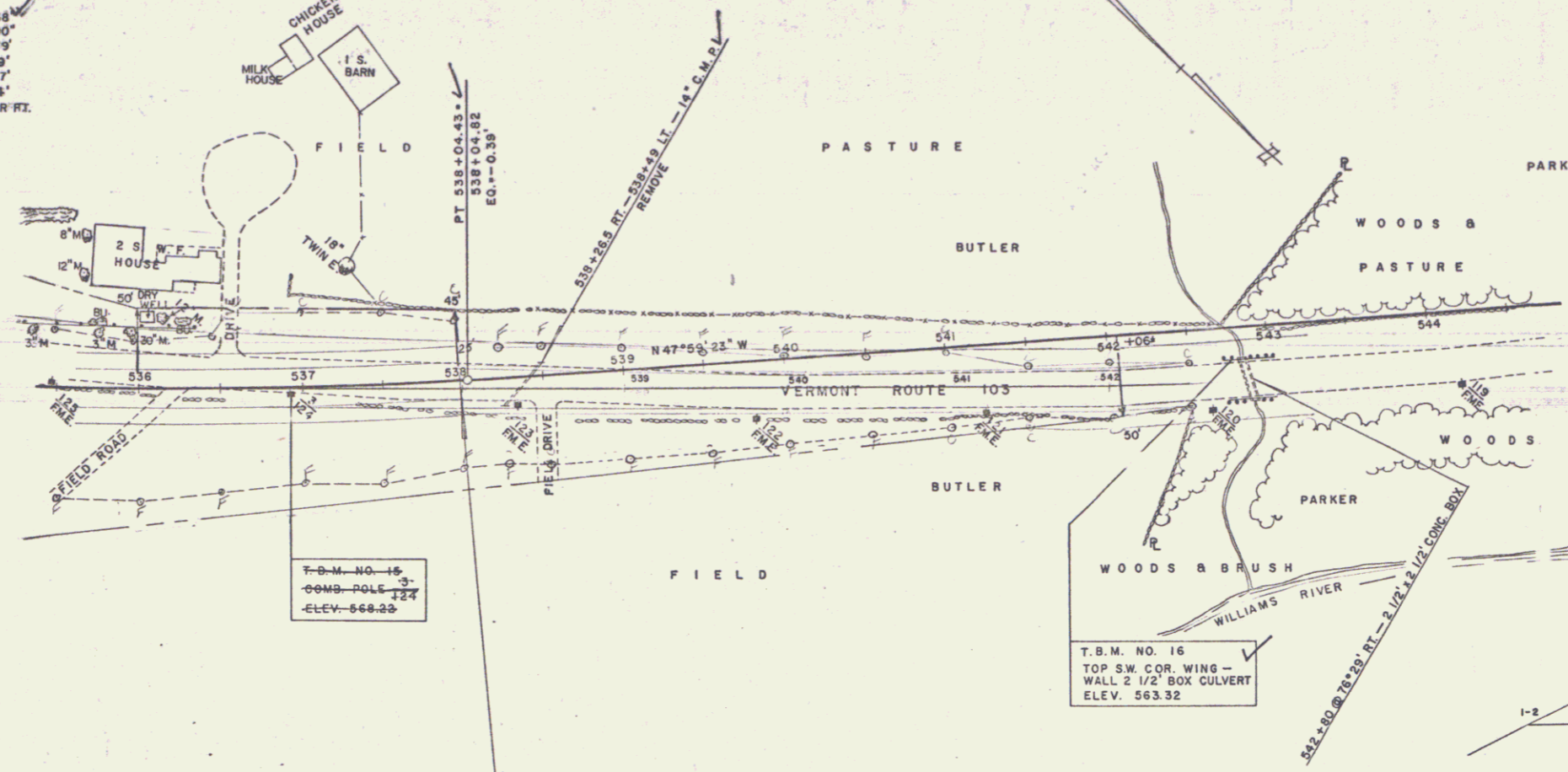

T.B.M. NO. 16
COMB. POLE
ELEV. 568.23

T.B.M. NO. 16
TOP S.W. COR. WING -
WALL 2 1/2" BOX CULVERT
ELEV. 563.32

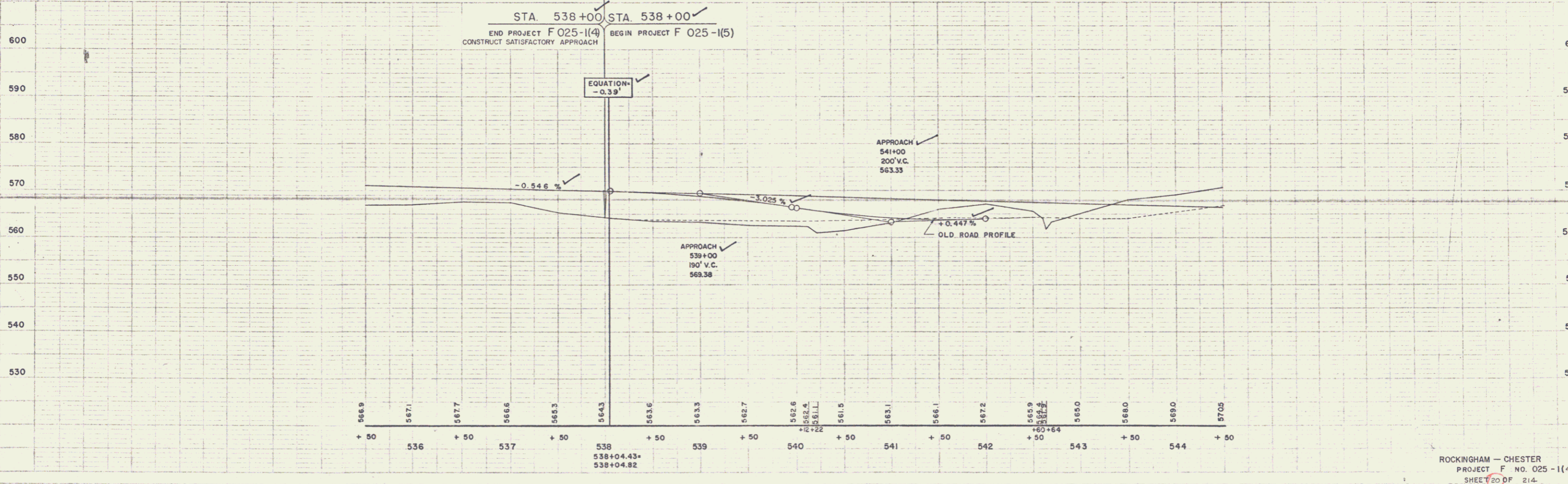
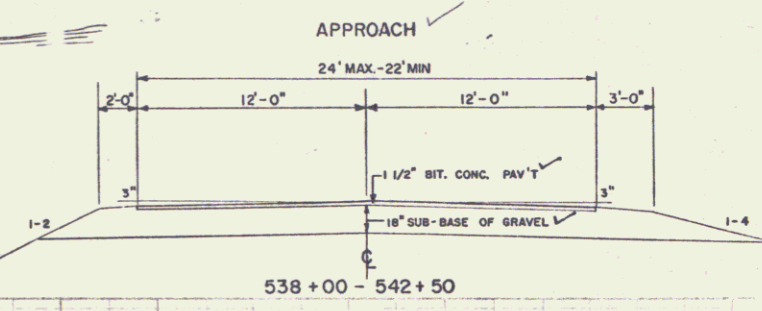

ROCKINGHAM - CHESTER
PROJECT F NO. 025-1(4)
SHEET 20 OF 214
GORDON E. ANSICORR & ASSOCIATES
REGISTERED ENGINEERS AND ARCHITECTS

12