

DEMOLITION & REMOVAL OF BUILDING

ITEM 586

Sta 153+65	27'
" 153+70	"
" 157+15	"
" 157+35	"
" 158+45	"
" 158+90	"
" 159+45	"
" 157+80	14'
" 159+00	"

Sta 22+00
Begin Construction

$\Delta 4^{\circ}54'30''$ Rt
D 11'
R 572936'
T 2485'
L 4902'
E 632'
No Brk

Three Cable Guard Rail w/ Steel Posts Item 543

156+24 Lt - Vt. 100 27+10 Rt
Vt. 100 27+10 Lt - 169+00 Lt
27+93 Lt - 27+93 Rt } Vt. Rte. 100
27+37 Lt - 27+93 Rt }
30+88 Lt - 32+00 Lt }
Construct Approach
161+19.5 Lt
162+70 Rt
Construct Drive Vt. Rte 100
27+50 Lt
23+00 Rt
191
189+100 Rt.

Unclass Channel Excav. Item 106-C

Chan. 15+00 - Chan. 24+50

Steel Guide Posts
App. @ 10' Intervals 10'

Muck Excavation
165+85 - 169+50

Place Guard Rail w/ Posts
161+70 Rt.

Stone Fill for Slope Protection, Item 5

Chan. 15+00 - Chan. 24+50

Stone Fill Heavy Type 100
Sta. 163+00 - 179+25 Lt.

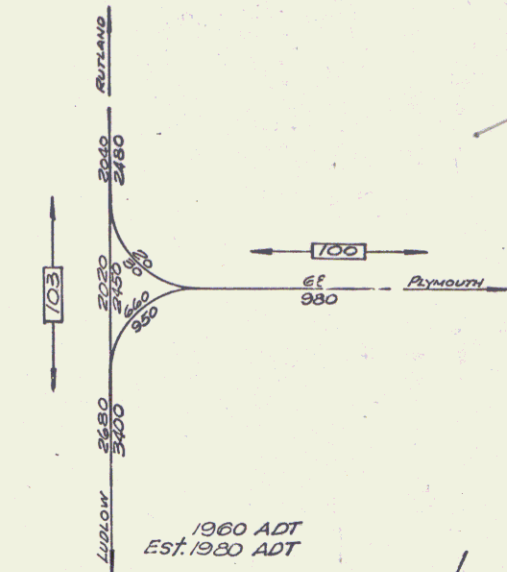
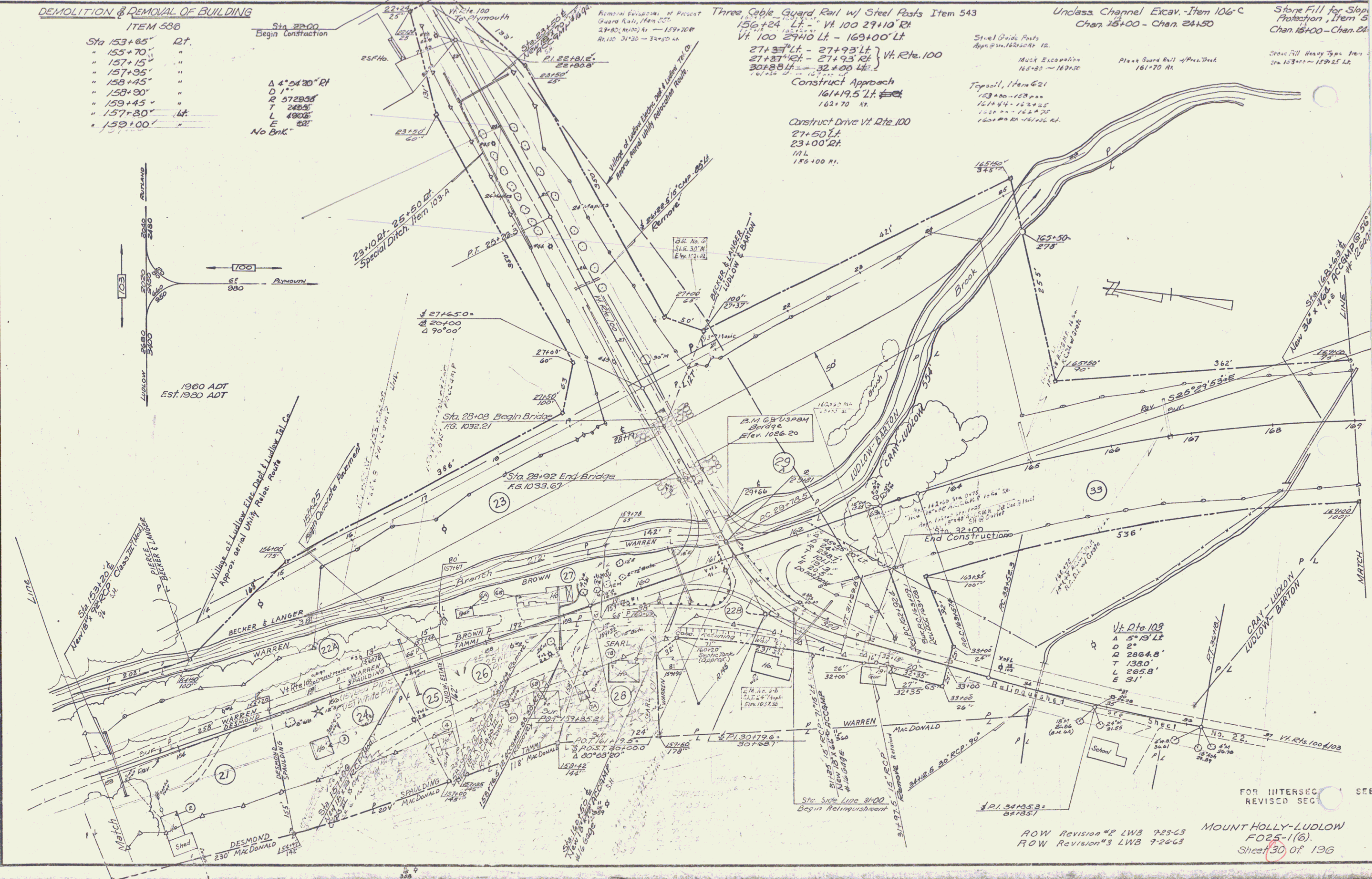

Vt. Rte 109
A 5' 13' Lt
D 2'
T 2804.8'
L 1380.0'
E 31'

FOR INTERSEC SEE REVISD SEC

ROW Revision #2 LWB 7-23-63
ROW Revision #3 LWB 7-26-63
MOUNT HOLLY-LUDLOW
FO25-1(6)
Sheet 30 of 196