

WOOD GUARD RAIL REQUIRED		
CULV. STA	LEFT	RIGHT
250+32	24'	24'
253+30	24'	24'
254+34	24'	24'
256+50	24'	—
260+38	24'	24'

CABLE GUARD RAIL REQUIRED		
STATIONS	LEFT	RIGHT
255+24-257+00	—	176'

NEW REIN. CONC. PIPE CULVERTS REQUIRED					
CULV. STA	DIAM.	LENGTH	CONC.	REIN. STEEL	
250+32	18"	36'	1.0 cu	—	54 lbs
253+30	15"	32'	1.2 cu	1.2 cu	174 lbs
254+34	15"	32'	1.9 cu	1.2 cu	92 lbs
256+50	15"	40'	1.0 cu	1.2 cu	44 lbs
260+38	18"	36'	1.8	—	54 lbs

DES. NO. 127 A 1930 17 57

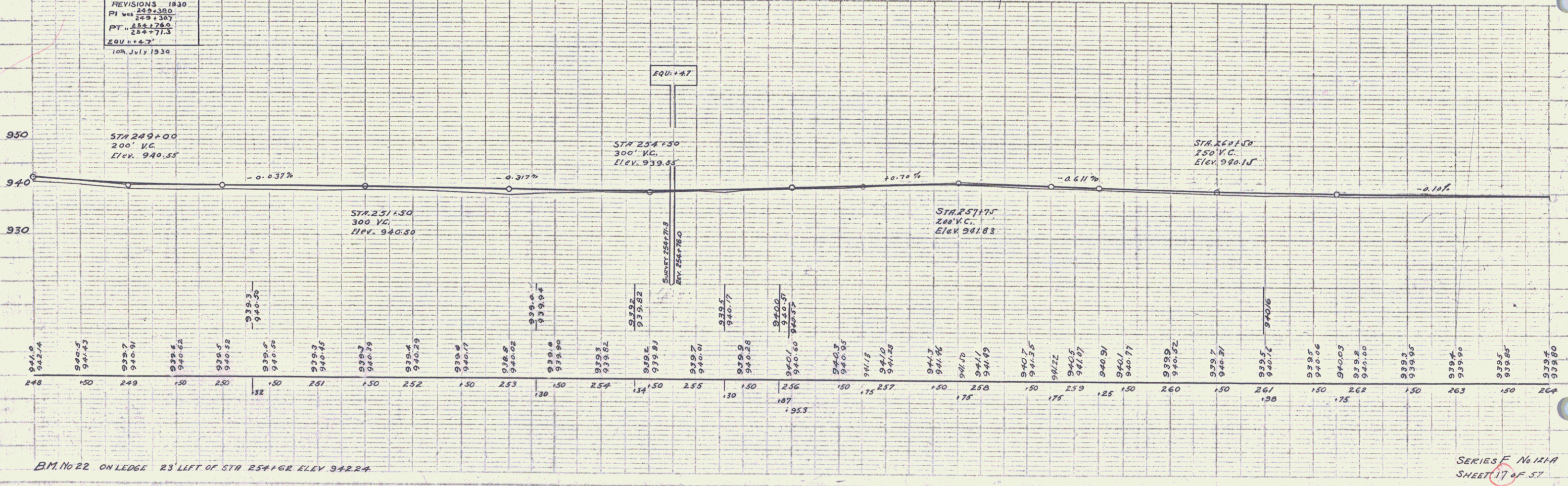
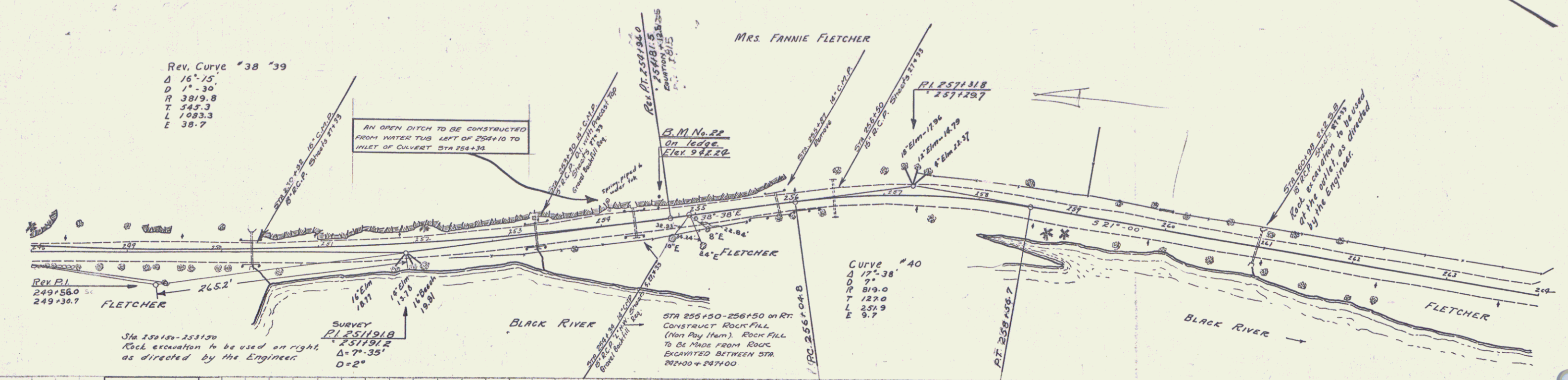

SERIES F No. 127 A SHEET 17 OF 57

16