

WOOD GUARD RAIL REQUIRED

CULV. STA	LEFT	RIGHT
203+30	—	24'
195+35	—	—

WOOD GUIDE POSTS REQUIRED

CULV. STA	LEFT	RIGHT
203+30	1	—
195+35	1	—

NEW REIN CONC PIPE CULVERTS REQUIRED

CULV. STA	LEN	CHC. A	CHC. C	REIN. STEEL GRADE
203+30	18'	60"	2.9	15 #3 213 #4
195+35	15'	40"	1.5	15 #3 174 #4

GRAVELLED COBBLE GUTTER REQUIRED

STATIONS	L+R	WIDTH	LENGTH	AREA
204+00-205+00	L	3'-0"	100'	333 sq. ft.

CONCRETE CURB AND GUTTER REQUIRED

STATIONS	L+R	WIDTH	CHC. B	SKEL
203+00-204+00	L	2'-0"	6.40	180 #

MAP STATE PLANNED LOCAL SHEET NO. 12A 1930 13 57

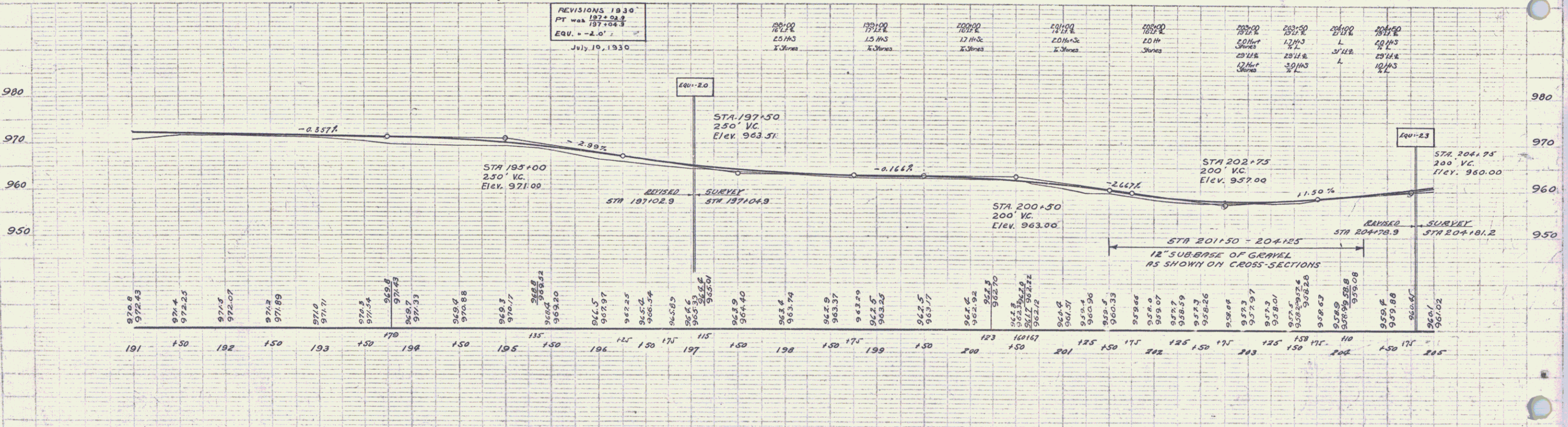
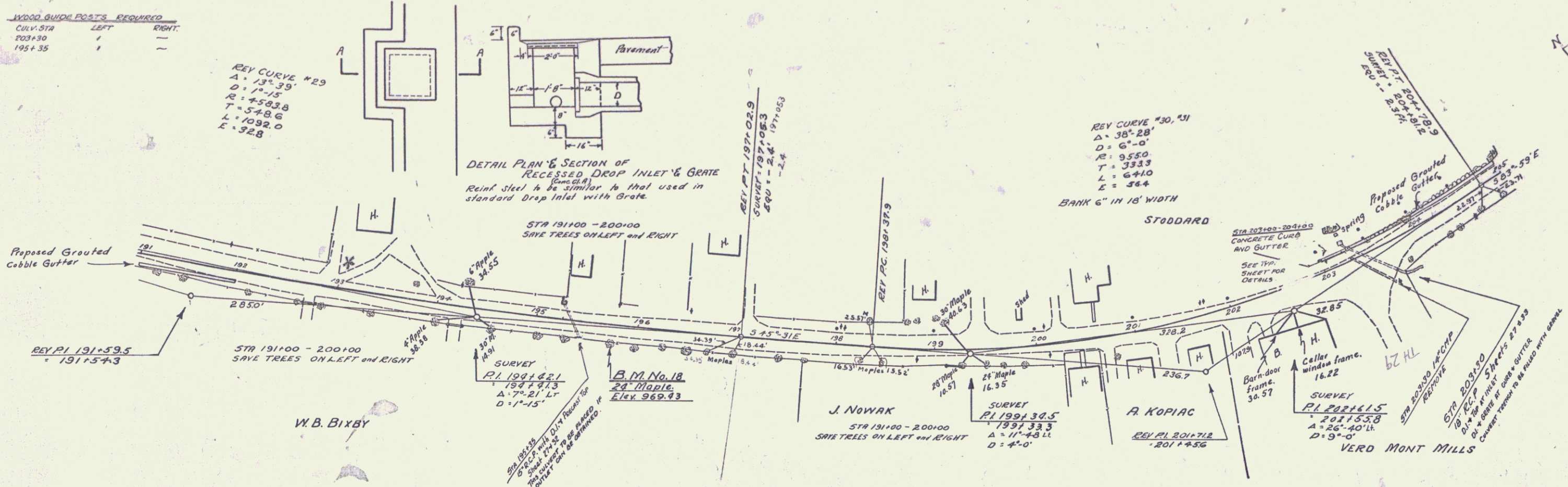

B.M. 1618 SPIKE IN ROOT OF 24" MAPLE 25' RIGHT OF STA. 195+76 ELEV. 969.43

SERIES F No. 121A SHEET 13 OF 57