

WOOD GUIDE POSTS REQUIRED		NEW 12" CORRUG. GALV. METAL PIPE REQUIRED		NEW CORR. CORR. AND GUTTER REQUIRED				GROUTED CORNELL GUTTER RUNOFF			
STATIONS	LEFT	RIGHT	STATIONS	LENG.	CORR. #	CONC. #	REIN. STEEL	STATIONS	L	R	LENG. QUANTITY
58100-6100	324	---	58198	24'	36'	1.8 cy	157 lb	61000-61000	L	---	300
61000-66100	560	---	61115	18'	32'	1.8 cy	157 lb	61000-66175	L	---	575'
			63130	18'	40'	1.8 cy	157 lb				19.1cy
			65136	18'	44'	1.8 cy	157 lb				36.6cy
			67157	36'	36'	4.0 cy	58 lb				1033'

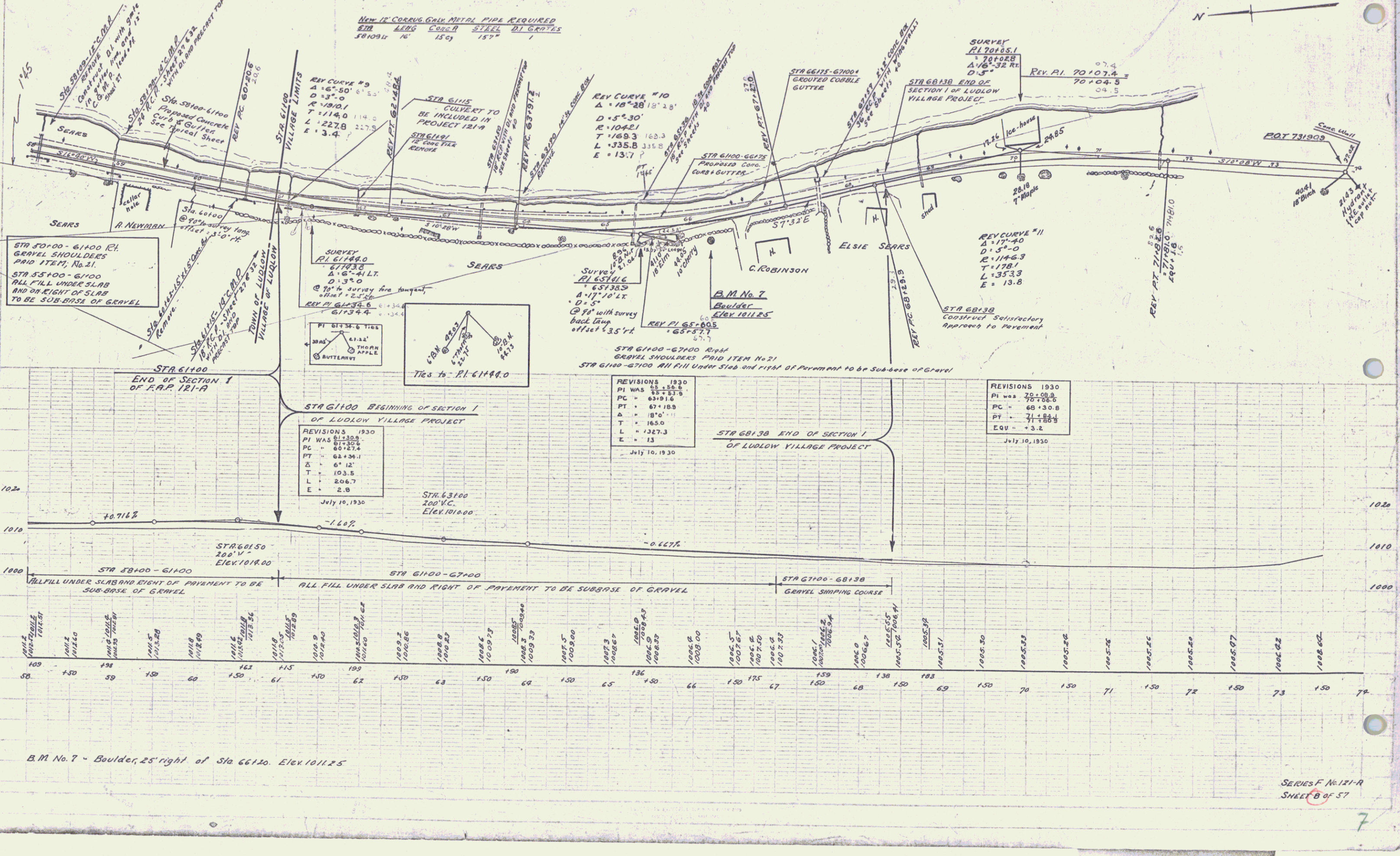

STA 50+00 - 61+00 R.H. GRAVEL SHOULDER PAID ITEM, No. 21
 STA 55+00 - 61+00 ALL FILL UNDER SLAB AND ON RIGHT OF SLAB TO BE SUB-BASE OF GRAVEL

REVISIONS 1930
 PI WAS 61+30.9
 PC = 61+30.4
 PT = 62+34.1
 Δ = 67° 12'
 T = 103.5
 L = 206.7
 E = 2.8
 July 10, 1930

REVISIONS 1930
 PI WAS 65+50.8
 PC = 63+91.6
 PT = 67+18.9
 Δ = 18° 11'
 T = 165.0
 L = 132.3
 E = 13
 July 10, 1930

REVISIONS 1930
 PI WAS 70+09.8
 PC = 68+30.8
 PT = 71+88.1
 Δ = 17° 11'
 T = 178.1
 L = 353.3
 E = 13.8
 July 10, 1930

STATION	100	150	200	250	300	350	400	450	500	550	600	650	700	750	800	850	900	950	1000
ELEVATION	109.50	109.50	109.50	109.50	109.50	109.50	109.50	109.50	109.50	109.50	109.50	109.50	109.50	109.50	109.50	109.50	109.50	109.50	109.50

B.M. No. 7 - Boulder, 25' right of Sta 66120. Elev 1011.25