

WOOD GUARD RAIL REQUIRED			CABLE GUARD RAIL REQUIRED			NEW REINFORCED CONCRETE PIPE CULVERTS REQUIRED				
CULY STA	LEFT	RIGHT	STATIONS	LEFT	RIGHT	STATION	DIAM	LENGTH	CODE	RAINF. STEEL
32+25	2'	2'	28+17.16	28+10.9	48'	32+25	18"	35'	18-4	5# 10s
38+64	2'	2'	31+00	32+10.4	18'	38+64	18"	32'	18-4	5# 10s

FED. ROAD DIST. NO.	STATE	FED. AID DIST. NO.	SHEET NO.	TOTAL SHEETS
8	IA	1910	6	57

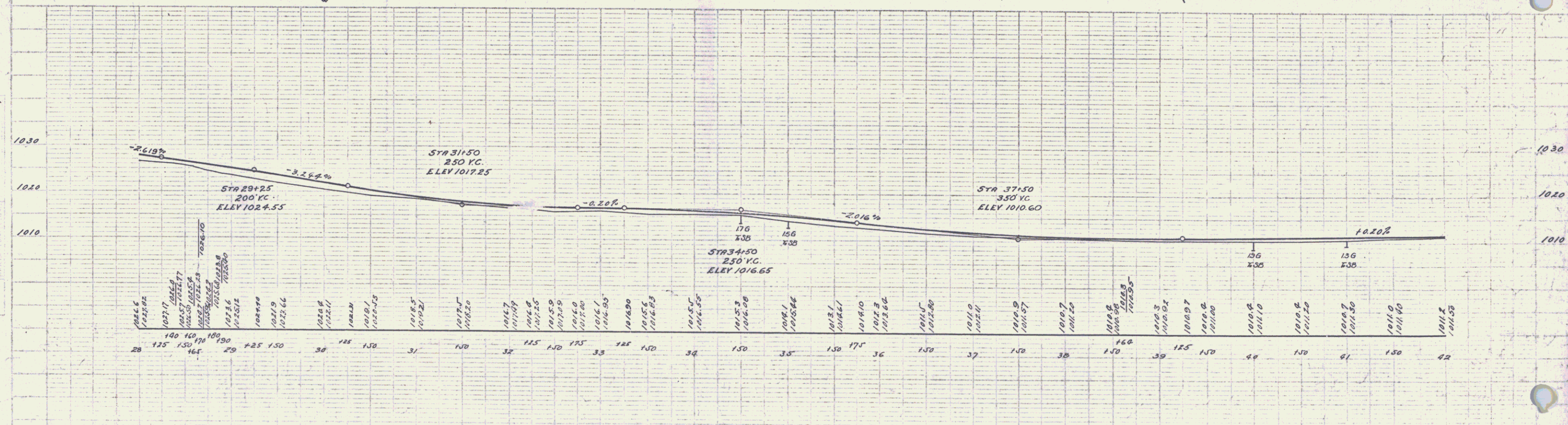
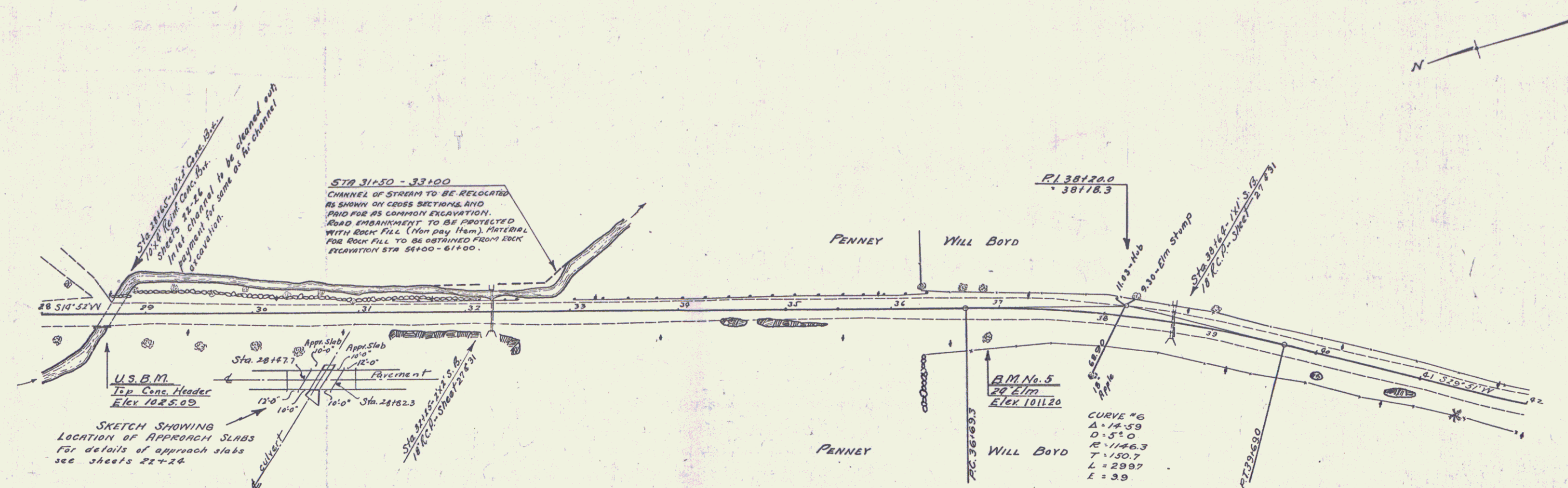

U.S.M. - On conc. header, 11' right of Sta. 29+16.2 Elev 1025.09
 B.M. No. 5 - Spike in root of 24' Elm, 24' right of Sta. 36+90. Elev 1011.20

SERIES F No. 121-A
 SHEET 6 OF 57

5