

WOOD GUARD RAIL REQUIRED

| CULV. STA. | LT. | RT. |
|------------|-----|-----|
| 5+07 | 24' | 24' |

CABLE GUARD RAIL REQUIRED

| STATIONS | LEFT | RIGHT |
|--------------------------|------|-------|
| 3+90 TO 6+70 BLINE 240' | - | - |
| 6+00 BLINE TO 11+50 480' | - | - |
| 10+76 TO 11+26 | 4-8 | - |

WOOD GUIDE POSTS REQUIRED

| CULV. STA. | LT. | RT. |
|------------|-----|-----|
| 6+92 | - | 1 |
| 8+16 | - | 1 |
| 8+88 | - | 1 |

NEW REINFORCED PIPE CULVERTS REQUIRED

| STATION | DIAM. | LENGTH | CONC. | REIN. STEEL |
|---------|-------|--------|--------|-------------|
| 5+07 | 15" | 36' | 2.3 cy | 33 lbs |
| 6+18 | 15" | 48' | 1.2 cy | 174 lbs |
| 8+16 | 15" | 52' | 1.5 | 174 lbs |
| 8+83 | 15" | 36' | 1.5 | 174 lbs |
| 11+00 | 30" | 56' | 3.2 | 58 lbs |

NEW REINFORCED DRAINAGE PIPE CULVERTS REQUIRED

| STATION | DIAM. | LENGTH | CONC. | REIN. STEEL |
|----------|-------|--------|--------|-------------|
| 12+75 R. | 12" | 24' | 2.3 cy | - |
| 9+00 " | 12" | 36' | 1.2 cy | - |

GRADED COBBLE CUTTER REQUIRED

| STATIONS | L. R. | WIDTH | BASE |
|--------------|-------|-------|------------|
| 7+00 TO 8+00 | R | 3'-0" | 35.0 in. W |

STANDARD UNDERDRYIN WITH 6" PER' G.M.P. COVERED

| STATIONS | DIAM. | L. R. | LENGTH |
|--------------|-------|-------|--------|
| 6+32 TO 8+00 | 6" | R | 108 FT |

100' SCALE
 12/1/1930
 57

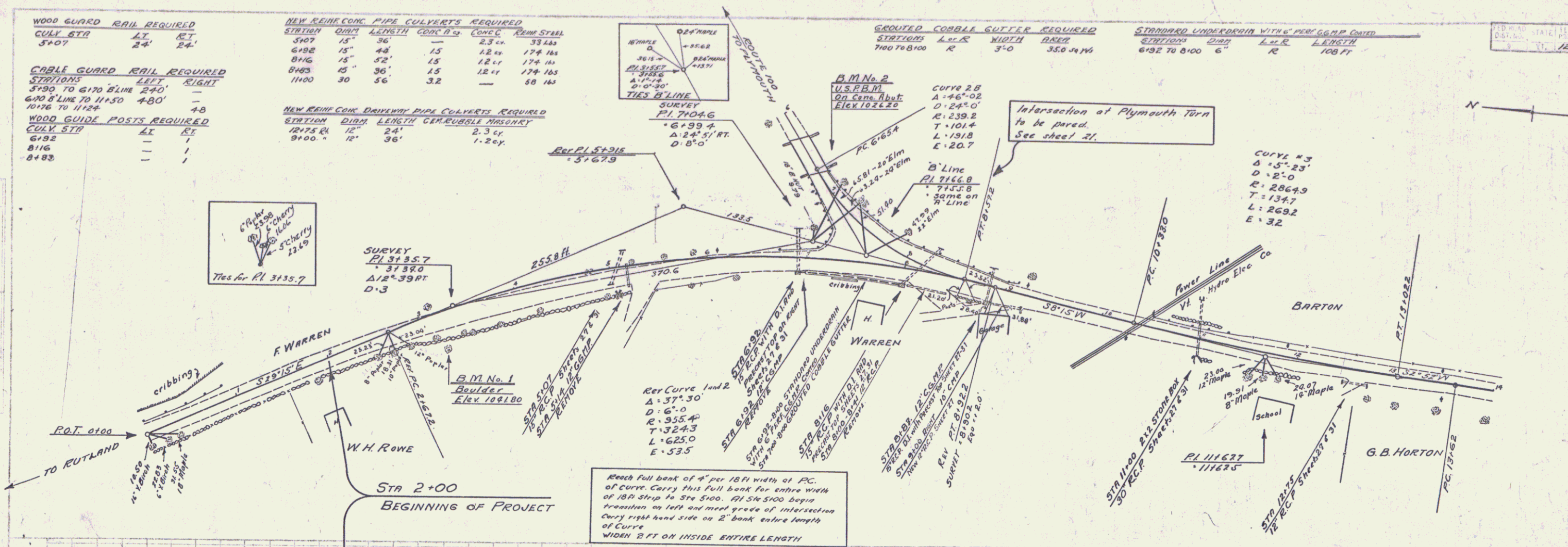

SUB-SOIL INVESTIGATION

- Mudus H
- Gravel G
- Sand S
- Silt SJ
- Clay C
- Quicksand Q
- ledge L

LEGEND

- Dry D
- Moist M
- Wet W
- Fine F
- Coarse C
- Stone Dose SD

Date of Investigation
 May 13-17, 1930

The intent of the sub-soil boring data as noted on the layouts is to show the sub-soil conditions only at the point where the boring was taken, and is no exact indication of surrounding sub-soil conditions.

Driveways to be constructed so as to provide satisfactory approaches to pavement at locations shown on cross sections, or as may be directed by the Engineer.

THE COMMON EXCAVATION INCLUDING ROCK AS ENCOUNTERED ON THE PROJECT, UNLESS OTHERWISE ORDERED BY THE ENGINEER, IS TO BE USED IN THE FORMATION OF EMBANKMENTS OUTSIDE OF THE PAVEMENT WIDTH AND ALSO IS NOT TO BE USED FOR SHOULDER CONSTRUCTION. APPROVED BOARDING IS TO BE USED FOR FILL UNDER PAVEMENT, AND FOR SHOULDER CONSTRUCTION OVER THE ENTIRE PROJECT EXCEPT AT THOSE LOCATIONS WHERE SUB-BASE OF GRAVEL OR GRAVEL SHOULDERS ARE CALLED FOR ON THE PLANS.

