

CHANNEL EXCAVATION  
 113+00 116+25 RT  
 117+00 118+30 RT  
 122+00 125+00 LT  
 127+30 127+65 LT

STONE FILL FOR  
 SLOPE PROTECTION  
 115+00 119+30 RT  
 121+00 123+40 RT  
 126+00 129+00 LT

THREE CABLE GUARD RAIL  
 WITH STEEL POSTS  
 115+00 - 122+54 RT  
 122+54 - 129+00 LT  
 115+20 - 122+93 RT. 775 l.f.  
 122+10 - 129+00 LT. 670 l.f.

MARY FLETCHER CHARLTON  
 PLANK GUARD RAIL 11m 541  
 113+00-113+24 Lt. 24 l.f.  
 CONSTRUCT TURN-OUTS  
 114+50 Rt.

# 4  
 6.61 acres ±  
 91+35 - 137+78

WOOD GUIDE POSTS Item 543

Sta.	Sta.	Lt.	Rt.
113+45	114+95	1	7
115+35		1	(Underdrain)
127+13		1	(Underdrain)
127+15		1	(Underdrain)

STATE OF VERMONT  
 PROCTOR-PIPER STATE FOREST

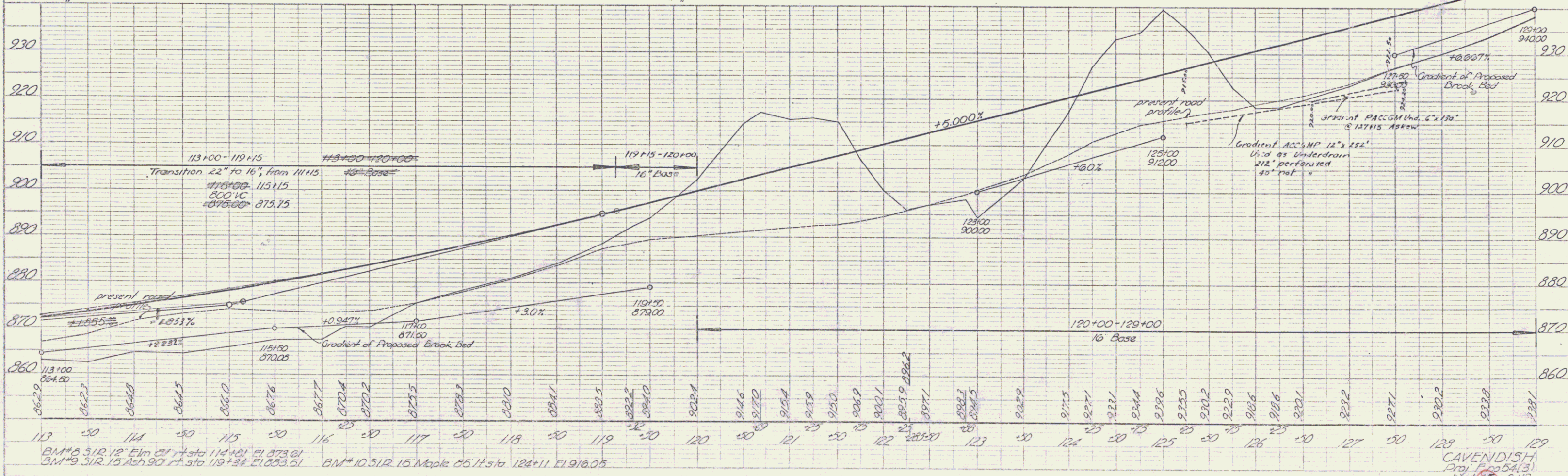
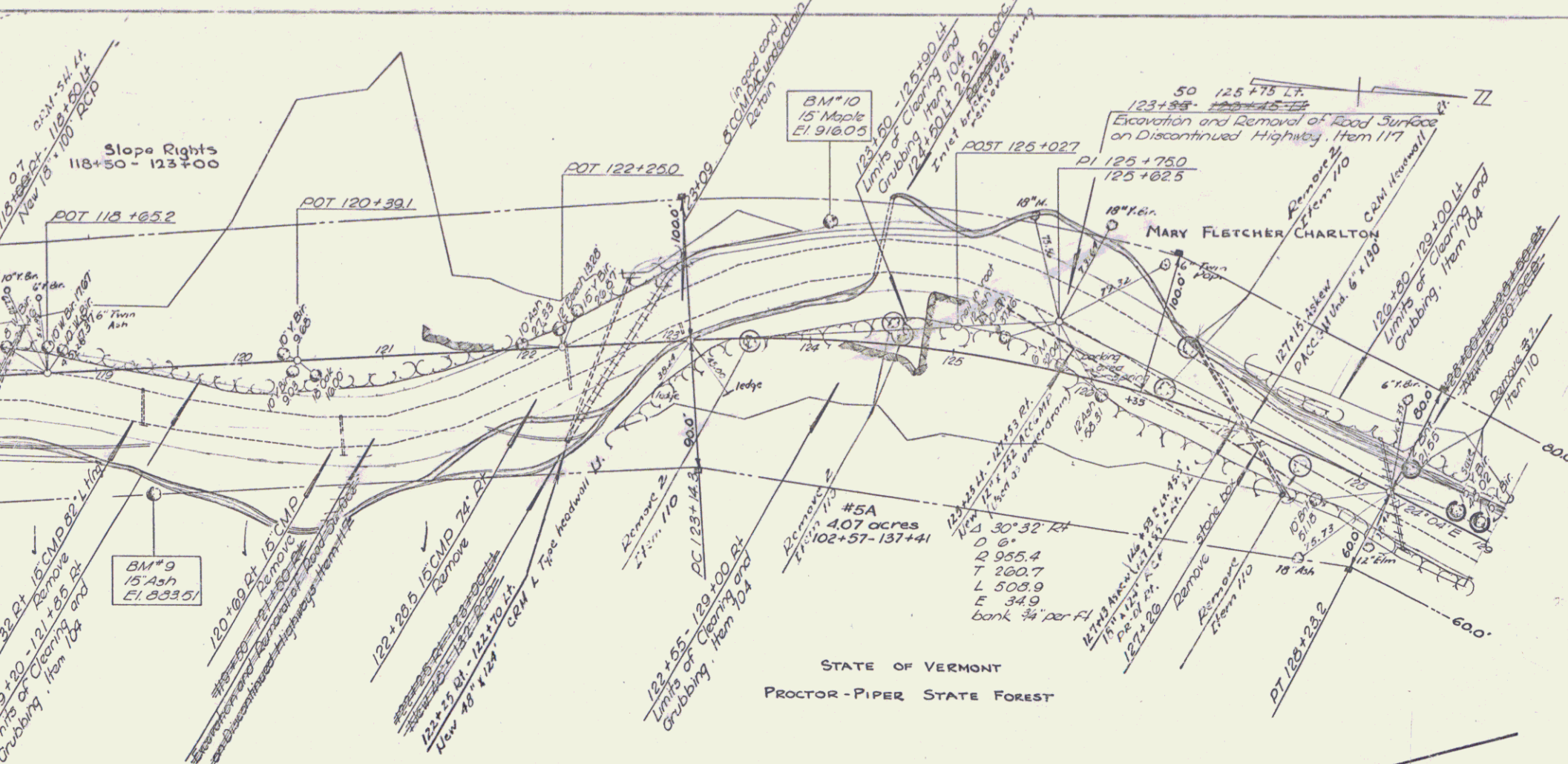

STATE OF VERMONT  
 PROCTOR-PIPER STATE FOREST

CAVENDISH  
 Proj. No. 54(3)  
 sheet 15 of 13