

FED. ROAD DIST. NO.	STATE	FED. AID FISCAL YEAR	SHEET NO.	TOTAL SHEETS
9	VT	54 B	8	39

**GUARD RAIL REQUIRED**

on LEFT

Sta. 87+94 to Sta. 88+18	- 24 Ft.
" 87+88 " " 90+12	- 24 "
" 94+18 " " 94+42	- 24 "
" 96+72 " " 96+96	- 24 "

on RIGHT

Sta. 87+94 to Sta. 88+18	- 24 Ft.
" 87+88 " " 90+12	- 24 "
" 94+18 " " 94+42	- 24 "
" 96+72 " " 96+96	- 24 "

Total This Sheet - 192 Ft.

**NEW CULVERTS REQUIRED**

Sta. 88+07 - 14" Corr. Iron Pipe Culvert - 30 Ft. Long
1-2 1/2-5 Concrete - 16 Cu. yds.
30' Rein. Steel
Sta. 90+00 - 3'x3' Rein. Concrete Culvert - 30 Ft. Long
1-2-4 Concrete - 6 Cu. yds.
1-2 1/2-5 Concrete - 2.5 "
Reinforcing Steel - 200'
Sta. 94+31 - 16" Corr. Iron Pipe Culvert - 30 Ft. Long
1-2 1/2-5 Concrete - 2 Cu. yds.
Sta. 96+83 - 14" Corr. Iron Pipe Culvert - 30 Ft. Long
1-2 1/2-5 Concrete - 17 Cu. yds.
Sta. 98+80 - 14" Corr. Iron Pipe Culvert - 28' Long

**SUB-BASE REQUIRED**  
Sta. 90+00 to Sta. 100+00 - Length - 100 Ft.

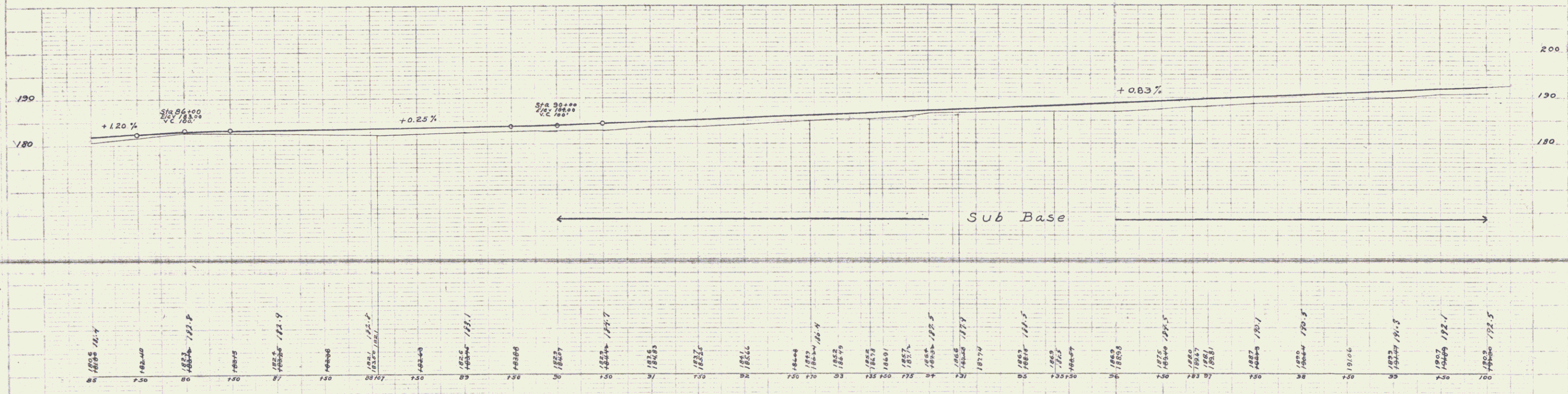
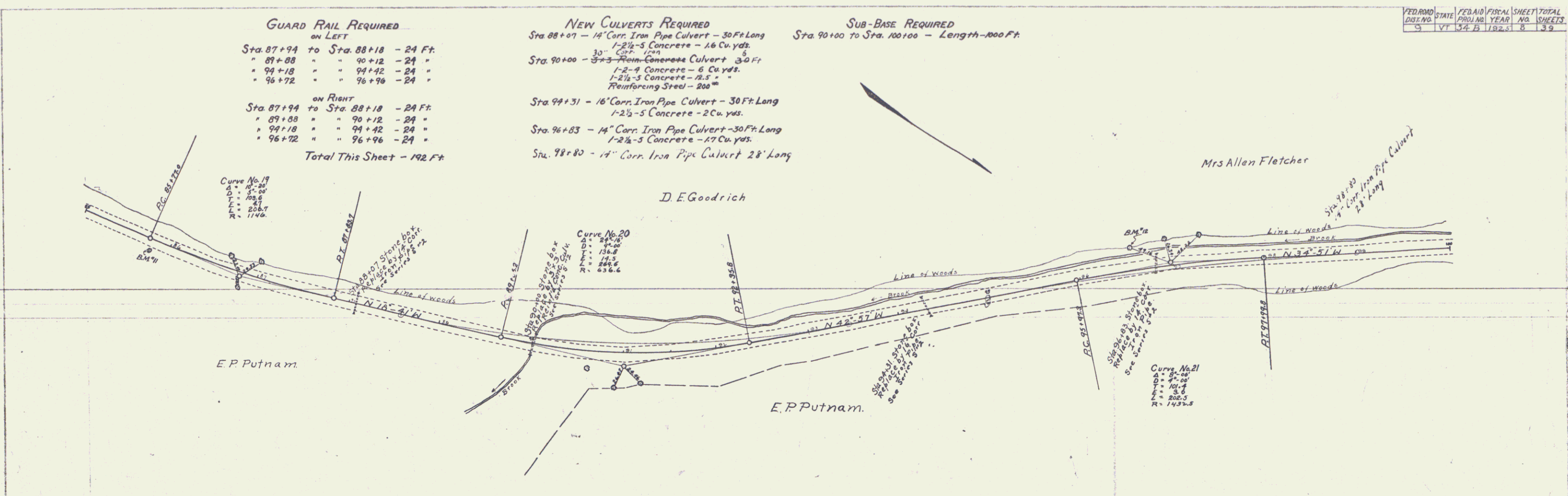

PLAN  
DATE: 8/1/13  
BY: [Signature]

PROFILE  
DATE: 8/1/13  
BY: [Signature]