

GUARD RAIL REQUIRED
 ON LEFT
 Sta. 74+78 to Sta. 75+02 - 24 Ft.
 " 79+38 " " 79+62 - 24 " "
 " 82+24 " " 83+08 - 24 " "
 " 84+78 " " 85+02 - 24 " "
 ON RIGHT
 Sta. 74+78 to Sta. 75+02 - 24 Ft.
 " 79+38 " " 79+62 - 24 " "
 " 82+24 " " 83+08 - 24 " "
 " 84+78 " " 85+02 - 24 " "

Total This Sheet - 192 Ft.

NEW CULVERTS REQUIRED
 Sta. 74+90 - 16" Cor. Iron Pipe Culvert - 36 Ft. Long
 1-2 1/2-5 Concrete - 17 Cu. yds.
 Sta. 79+50 - 16" Cor. Iron Pipe Culvert - 30 Ft. Long
 1-2 1/2-5 Concrete - 17 Cu. yds.
 Sta. 82+96 - 14" Cor. Iron Pipe Culvert - 28 Ft. Long
 1-2 1/2-5 Concrete - 16 Cu. yds.
 Sta. 84+89 - 14" Cor. Iron Pipe Culvert - 30 Ft. Long
 1-2 1/2-5 Concrete - 16 Cu. yds.

SUB-BASE REQUIRED
 Sta. 75+00 to Sta. 80+00 - Length 500'

FED. ROAD DIST. NO.	STATE	FED. AID PROJ. NO.	YEAR	SHEET NO.	TOTAL SHEETS
0	Vt.	5-2-B	1923	7	39

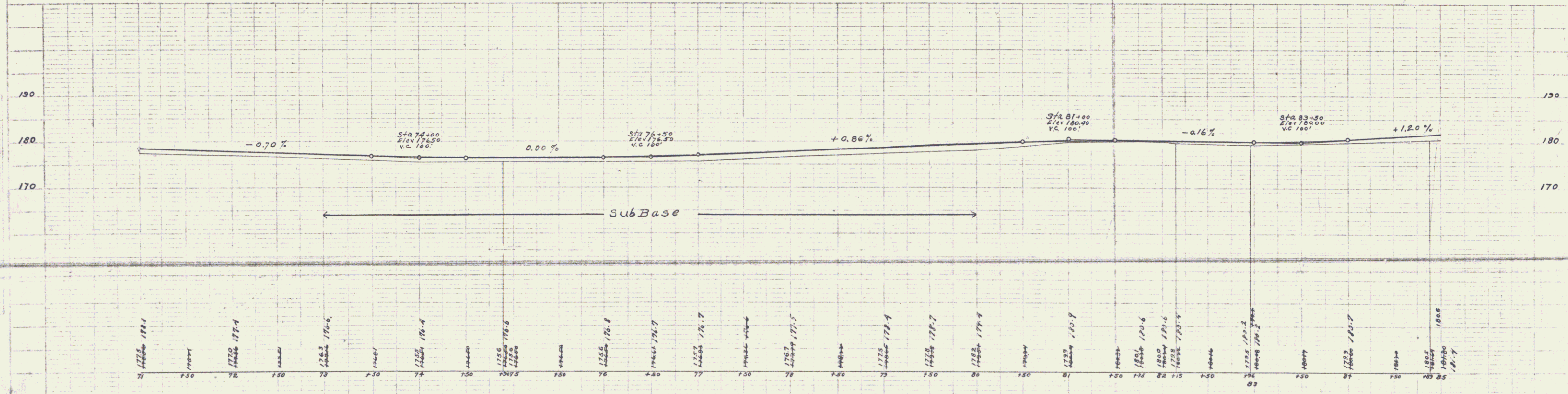
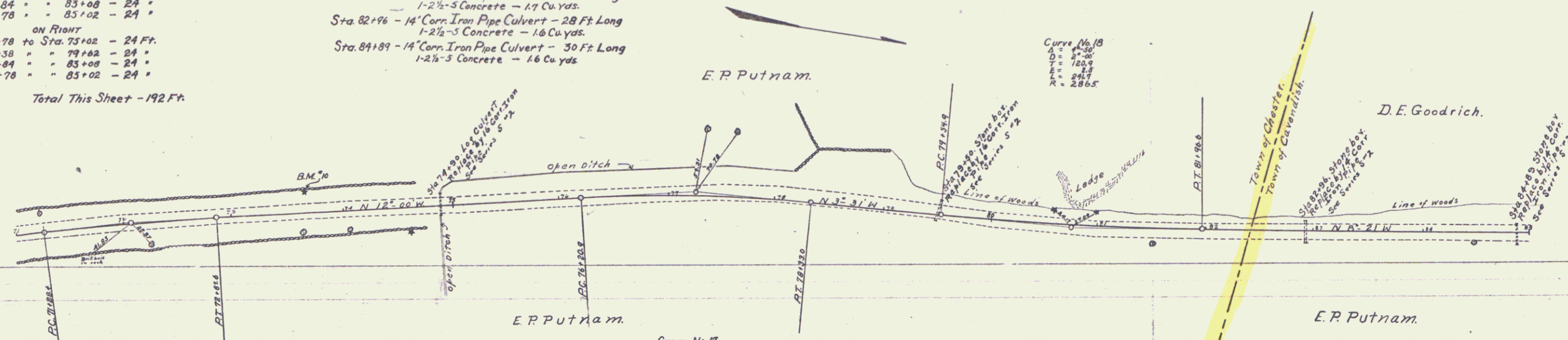

E.R. Putnam
 D.E. Goodrich
 Town of Chester
 Town of Cavendish

E.R. Putnam
 D.E. Goodrich
 Town of Chester
 Town of Cavendish