

Wood Gyro Rail Required

Culv. Sta.	Left	Right
202+69	26'	28'

NEW REIN. CONC PIPE CULVERTS REQUIRED

Sta.	Diag. Leng.	Conc. A	Steel
202+69	18' 4"	2.3cy	10#

DATE	BY	NO.	YEAR	SHEET
125-A		19	19	34

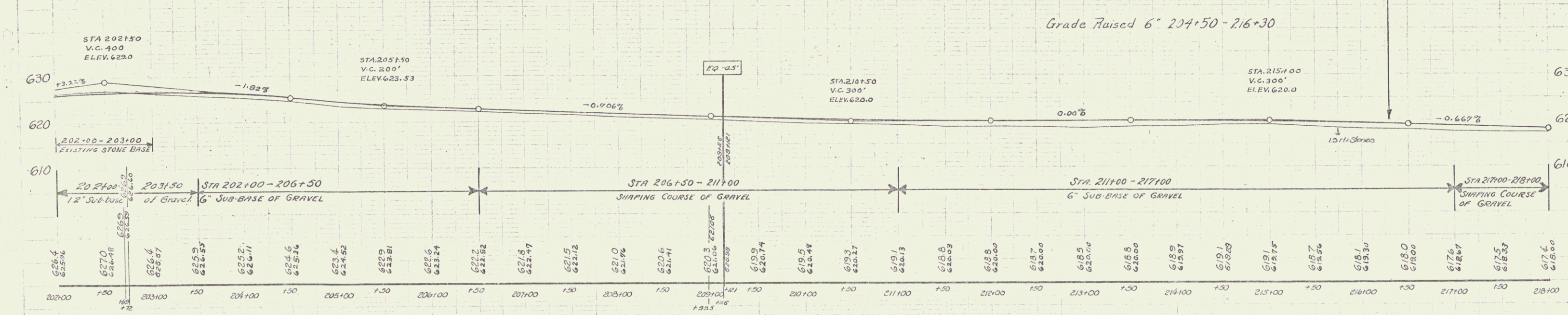
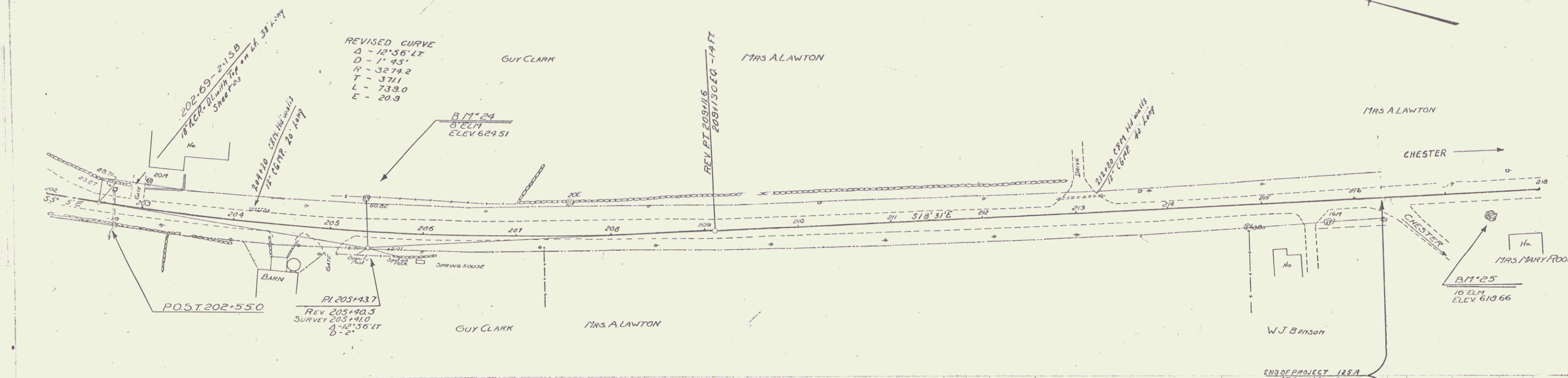

B.M. No. 24 8' E.L.M. 32' LT. STA. 205+36 Elev. 624.51  
 B.M. No. 25 16' E.L.M. 22' RT. STA. 217+46 Elev. 610.66

SERIES F No. 125-A  
 Sheet 19 of 34