

INDEX OF SHEETS

SHEET NO.	TITLE PAGE	DESCRIPTION
1	TITLE PAGE	
2	TYPICAL CROSS-SECTION OF IMPROVEMENT	2 1/2" CRUSHED GRAVEL MIXED IN PLACE SURFACE COURSE WITH CUTBACK ASPHALT AND PRIME COAT OF REFINED TAR. ITEMS 26, 30, B, 31
3	BANKING AND WIDENING TABLES	
4-6	PLAN AND PROFILE	
7	STANDARD SHEETS	SG 2-4 4X4 R.C. BOXES
8		SCW-4 4X4 R.C. BOXES
9		S-28 PIPE CULVERTS
10		S-30 GUARD RAIL
11		S-30A BOUNDARY MARKERS
12		S-40 BARRICADES, SIGNS AND LIGHTS
13		S-41 ROUNDING OF SLOPES
13A		S-48-46 THREE STRAND CABLE GUARD RAIL
13B		S-49-46 SPRING MOUNTED PANEL TYPE GUARD RAIL
14-28	CROSS SECTIONS	

STANDARD STRUCTURE SHEETS APPROVED BY THE CHIEF ENGINEER VERMONT DEPARTMENT OF HIGHWAYS

S-28	APRIL 26, 1941
S-30	MAY 12, 1941
S-30A	APRIL 19, 1941
S-40	DEC. 18, 1945

STATE OF VERMONT
STATE HIGHWAY DEPARTMENT

PLAN AND PROFILE OF PROPOSED
STATE HIGHWAY

FEDERAL AID PROJECT

TOWN OF SHREWSBURY

VERMONT ROUTE 103

LUDLOW - RUTLAND ROAD

BEGINNING AT A POINT 1333.3 FEET EASTERLY OF THE SHREWSBURY-CLARENDON TOWN LINE AND EXTENDING WESTERLY 1333.3 FEET TO THE SHREWSBURY-CLARENDON TOWN LINE

LENGTH OF PROJECT 1333.3 FEET = 0.253 MILES

FED. ROAD DIST. NO.	STATE	PROJ. NO.	FISCAL YEAR	SHEET NO.	TOTAL SHEETS
9	Vt.	110(3)	1946	1	28

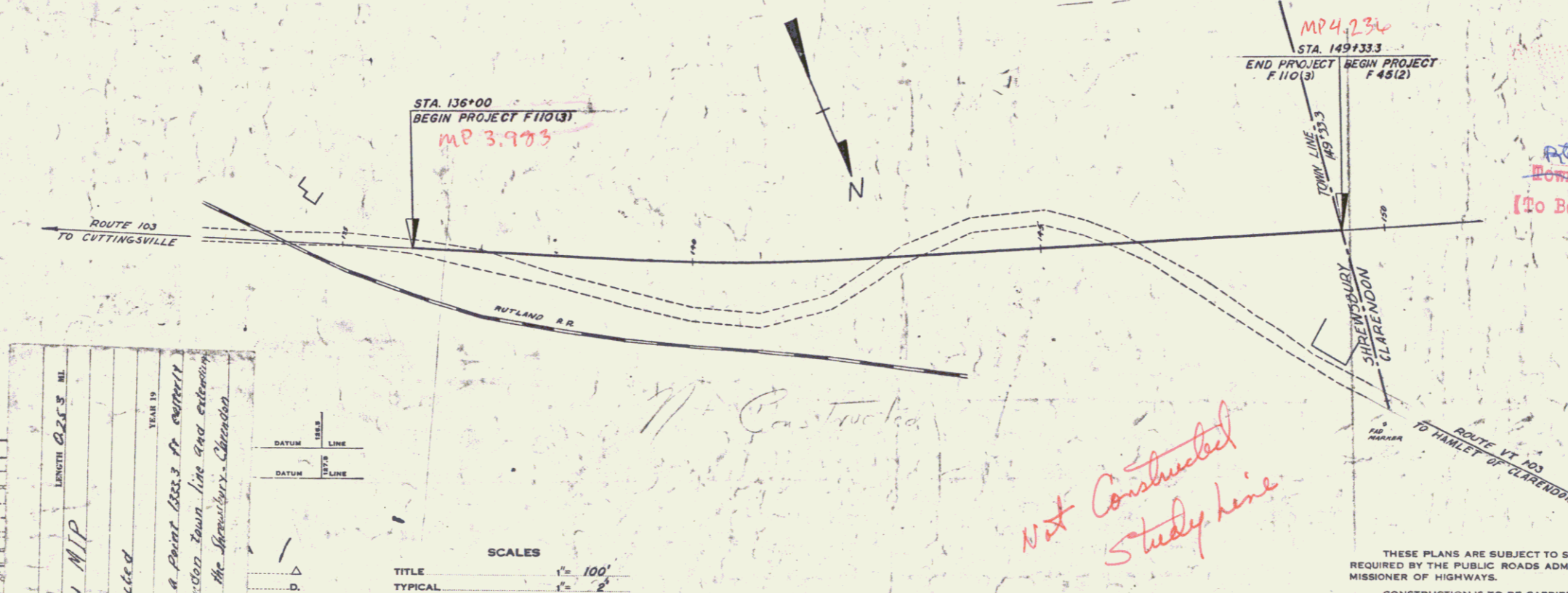
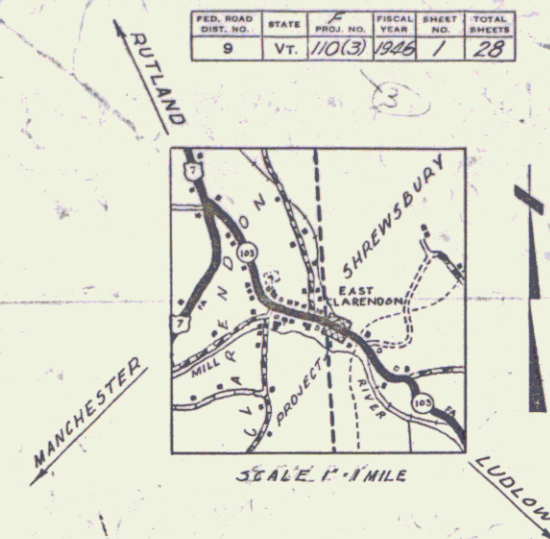

RIGHT-OF-WAY DIVISION
TOWN FILE
PERPETUAL
Town of VT 103
[To Be Returned To R.O.W. Division]

APPROVED: Dec 9 1946
H. August
COMMISSIONER OF HIGHWAYS

SUBMITTED BY ORDER OF THE STATE HIGHWAY BOARD

Date 12/5/1946
Pin # 00R126

RECOMMENDED FOR APPROVAL
DISTRICT ENGINEER
PUBLIC ROADS ADMINISTRATION
FEDERAL WORKS AGENCY

APPROVED
DISTRICT ENGINEER
PUBLIC ROADS ADMINISTRATION
FEDERAL WORKS AGENCY

THESE PLANS ARE SUBJECT TO SUCH REVISIONS AS MAY BE REQUIRED BY THE PUBLIC ROADS ADMINISTRATION OR THE COMMISSIONER OF HIGHWAYS.
CONSTRUCTION IS TO BE CARRIED ON IN ACCORDANCE WITH THE PLANS AND THE STANDARD ROAD AND BRIDGE SPECIFICATIONS OF 1936, AS APPROVED DECEMBER 29TH, 1936 BY THE PUBLIC ROADS ADMINISTRATION, INCLUDING ALL SUBSEQUENT APPROVED REVISIONS AND SUCH REVISED SPECIFICATIONS AND SPECIAL PROVISIONS AS ARE SUBMITTED WITH THE PLANS.

COUNTY LINE	---
TOWN LINE	---
FENCE LINE	---
STONE WALL	---
UNFENCED PROPERTY	---
GUARD RAIL	---
TRAVELED WAY	---
RAILROAD	---
RETAINING WALL	---
CENTER LINE	---
SURVEY LINE	---
CULVERT	---
DROP INLET	---
TROLLEY POLE	---
POWER POLE	---
TELEPHONE POLE	---
TREES	---
HEDGE	---

PROJECT: Shrewsbury
LENGTH: 0.253 MI.
TITLE: Proposed Grant M.P.
CONTRACTOR: Not Constructed
LOCATION: Beginning at a point 1333.3 ft. easterly of Shrewsbury-Clarendon town line and extending westerly 1333.3 ft. to the Shrewsbury-Clarendon town line.

DATE	BY	LINE
		DATE
		BY
		LINE

SCALES

TITLE	1" = 100'
TYPICAL	1" = 2'
PLAN	1" = 80'
PROFILE HORIZONTAL	1" = 80'
PROFILE VERTICAL	1" = 10'
CROSS SECTIONS	1" = 5'

APPROVED: Dec 2, 1946
H. August
DISTRICT HIGHWAY COMMISSIONER

SERIES F No 110(3) FILED
SHEET 1 of 28

FD ROAD	STATE	F	FISCAL SHEET TOTAL
DIST. NO.	YEAR	NO.	NO.
9	VT	110(3) 1946	4 28

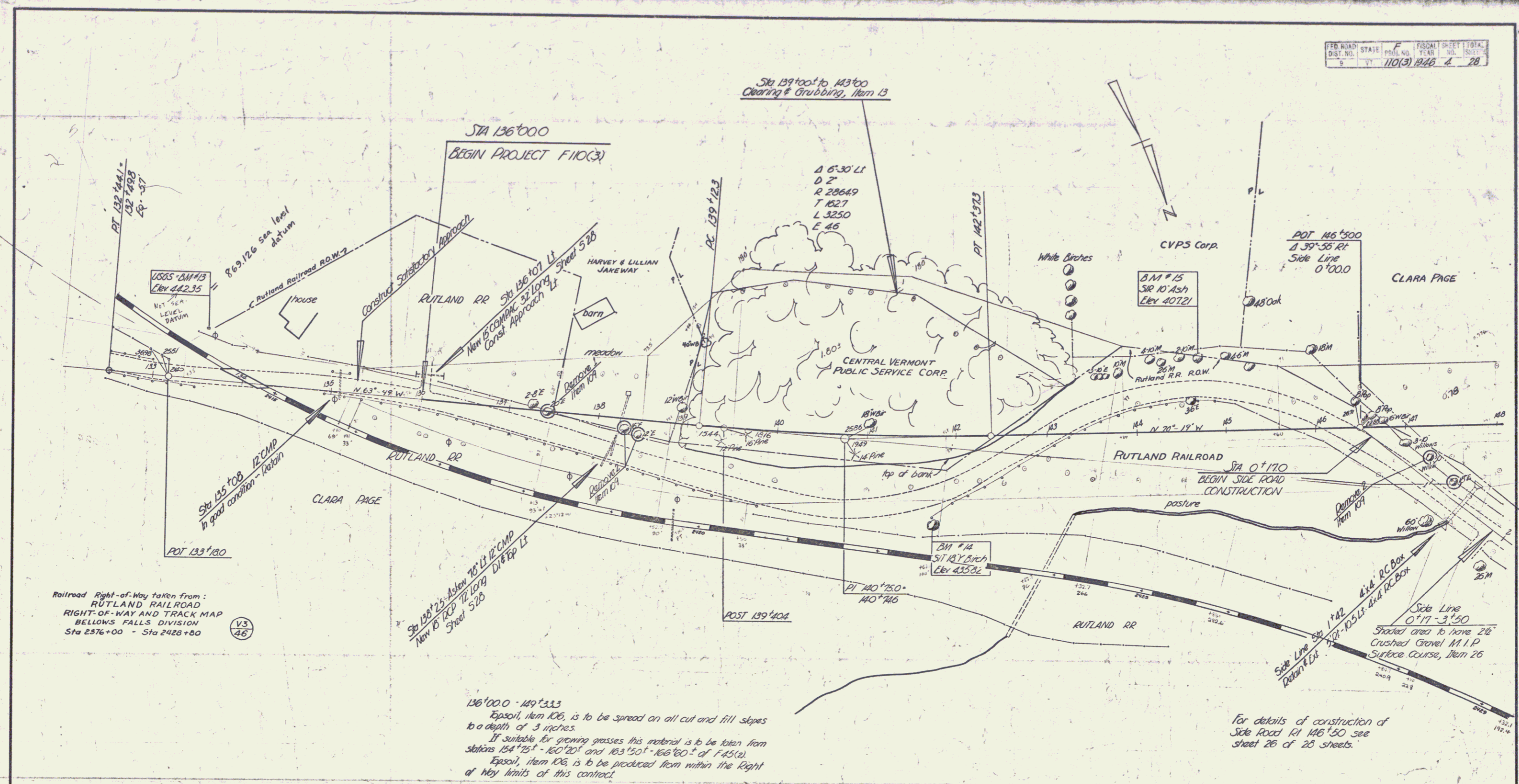

Railroad Right-of-Way taken from:
RUTLAND RAILROAD
RIGHT-OF-WAY AND TRACK MAP
BELLOWS FALLS DIVISION
Sta 2376+00 - Sta 2428+00

136+00.0 - 149+33.3
Topsoil, item 106, is to be spread on all cut and fill slopes
to a depth of 3 inches.
If suitable for growing grasses this material is to be taken from
stations 154+75+ - 160+20+ and 163+50+ - 166+80+ of F-45(c).
Topsoil, item 106, is to be produced from within the Right
of Way limits of this contract.

For details of construction of
Side Road at 146+50 see
sheet 26 of 28 sheets.

SHREWSBURY F 110(3)

Surveyed by	
Designed by	
Drawn by	
Traced by	
Checked by	
Series	F No. 110(3) Filed
	Sheet 4 of 28 Sheets

PLAN
 FACILITY
 DATE
 BY

DATE
 BY

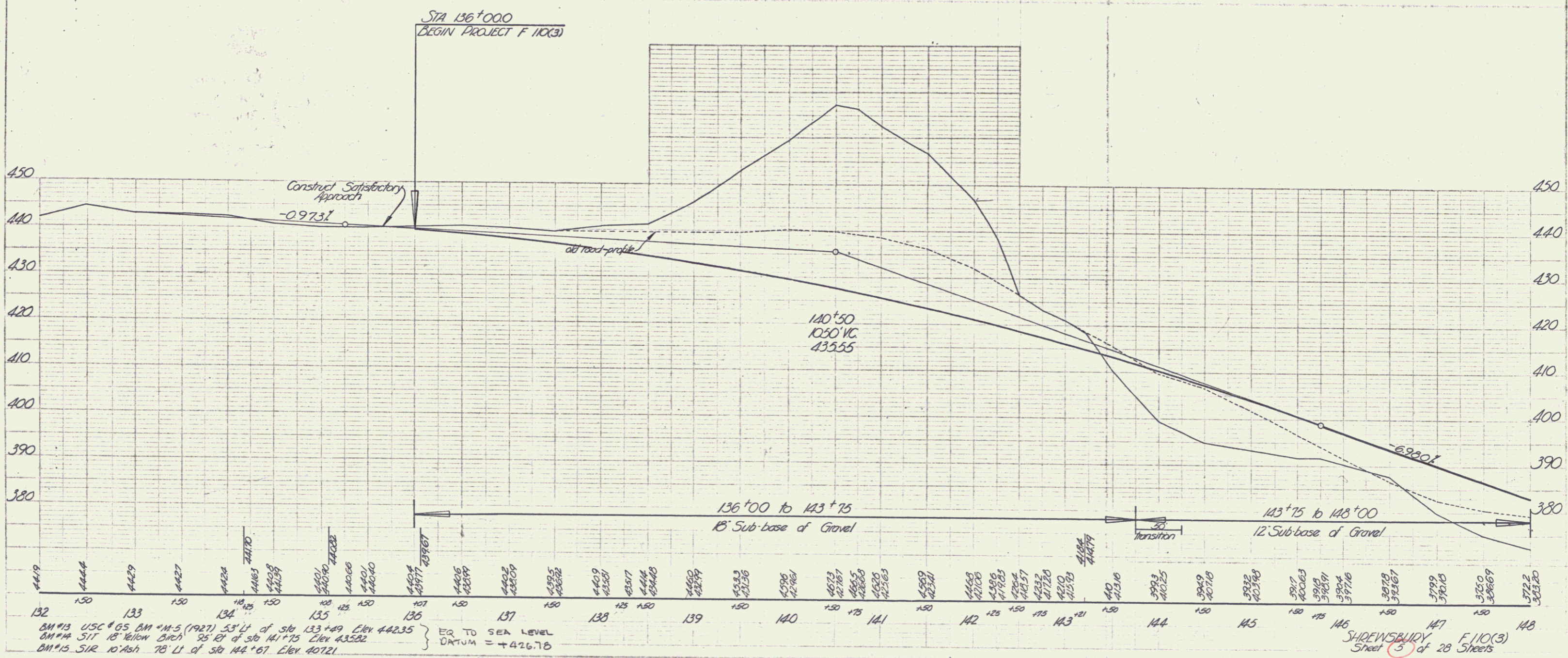

BM #13 USC # 65 BM # M-5 (1927) 53' LI of Sta 133+49 Elev 442.35
 BM #14 S11 15' Yellow Birch 25' LI of Sta 141+75 Elev 435.82
 BM #15 S1R 10' Ash 78' LI of Sta 144+67 Elev 407.21
 EQ TO SEA LEVEL
 DATUM = +426.78

SHEDSBAUDY
 Sheet 5 of 28 Sheets
 F.110(3)

149+33.3
 END PROJECT F110(3) BEGIN PROJECT F45(2)

149 N 70°19'W 149

Shrewsbury
 Claremont

Sta 3+50.0
 END SIDE LINE CONSTRUCTION

BM #16
 S.I.R. 24' Maple
 383.42
 Side Line
 P.I. 2+84.1 =
 2+83.6

149+33.3
 END F110(3) BEGIN F45(2)

152+00
 800' V.C.
 355.28

-6.900%

148+00 - 149+33.3
 12' Subbase of Gravel

372.2
 370.9
 369.5
 368.1
 366.3

148 150 149 150 150
 BM #16 S.I.R. 24' Maple 33' Rt. of Sta. 2+72 Side Line Elev. 383.42

SIDE LINE AT STA. 146+50 RT
 STA. 0+17 TO 3+50

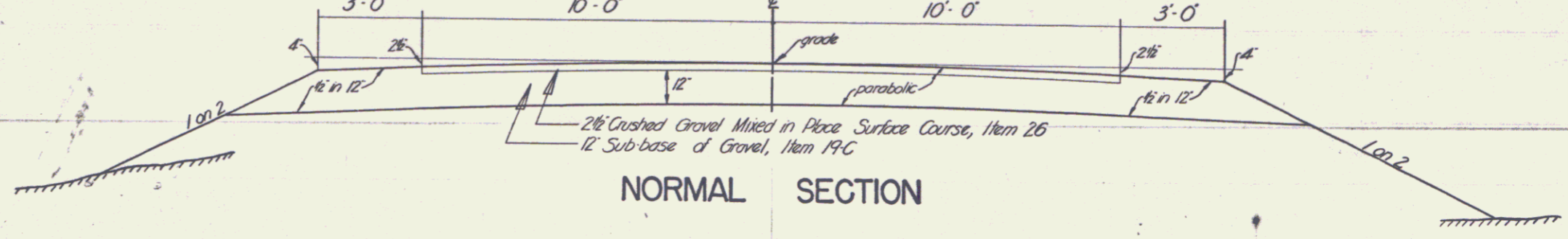

NORMAL SECTION

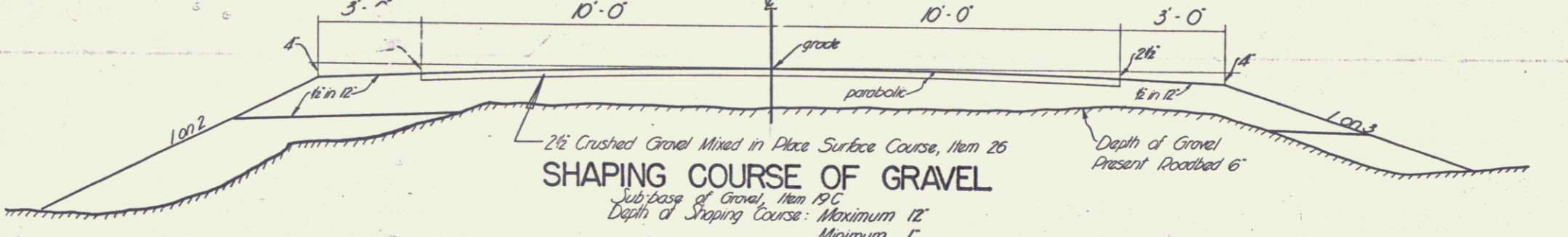

SHAPING COURSE OF GRAVEL

TYPICAL SECTIONS

CRUSHED GRAVEL MIXED IN PLACE SURFACE COURSE, ITEM 26

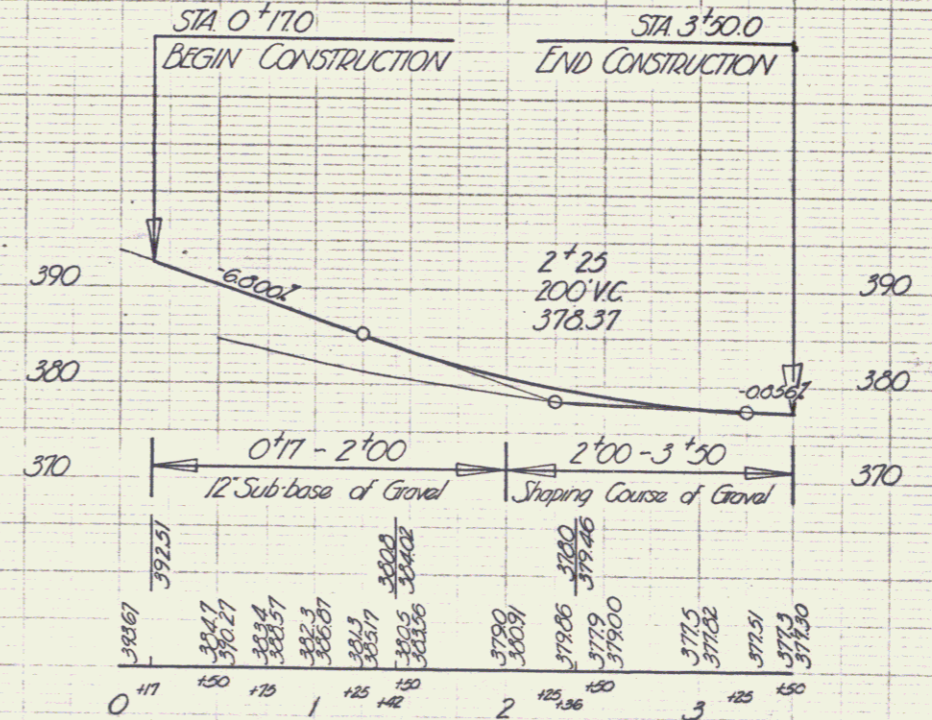

SIDE ROAD STA 146+50.0 RT

SHREWSBURY F110(3)
 sheet 6 of 28

PLAN
 Survey
 Lawn

PLAN
 Survey
 Lawn

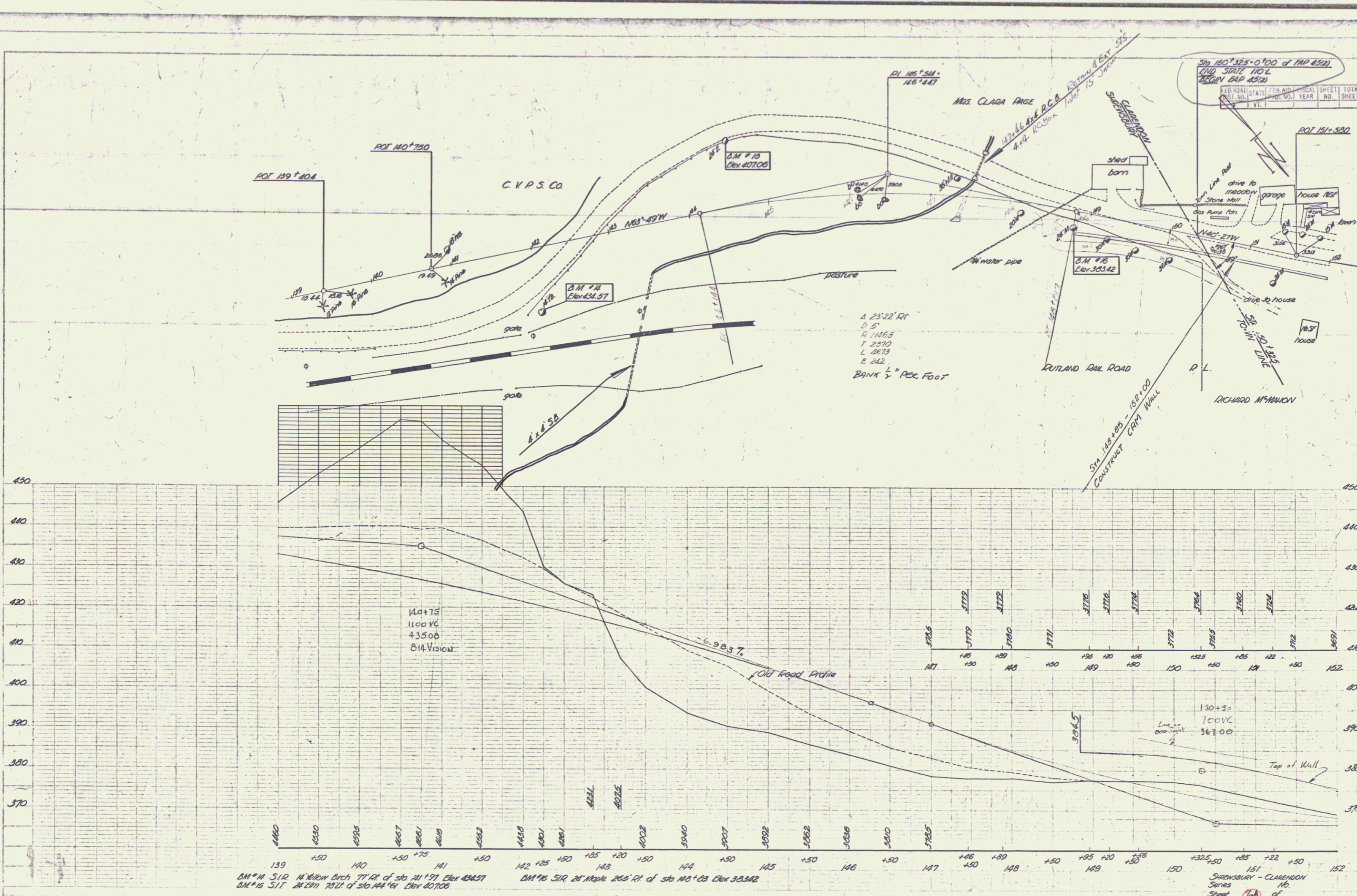

Sta 150+32.5 - 0+00 of TAD 2512
 AND STATE 110 L
 BEGIN MAP 4312

FILE NO. STATE PROJ. NO. YEAR NO. SHEETS
 1 11 1911 15

Δ 23'22" RT
 D 5'
 R 1146.3
 T 2570
 L 1673
 E 242
 BANK 1/2" PER FOOT

M4+15
 1100 VC
 435.06
 814 Vision

130+30
 700 VC
 367.00

BM #14 S.I.R. 14' Yellow Birch T.I. Rt. of Sta. 141+57 Elev. 424.57
 BM #15 S.I.R. 24' Elm T.I. of Sta. 144+61 Elev. 407.06
 BM #16 S.I.R. 24' Maple 265' Rt. of Sta. 146+03 Elev. 383.42

130+30
 151
 SAGHSBURY - CLARENDON
 Series No. 10
 Sheet 6A of 6

5