

INDEX OF SHEETS

1. TITLE PAGE
2. CONSTRUCTION WARNING SIGNS
3. J3 MINIMUM PLANTING DISTANCES, MARCH 10, 1965
4. J5 BRACING OF TREES, MARCH 10, 1965
5. QUANTITY SHEET
- 6-7. PLAN SHEETS

STATE OF VERMONT  
DEPARTMENT OF HIGHWAYS  
**PROPOSED IMPROVEMENT**

**TOWNS OF SHREWSBURY-CLARENDON**  
COUNTY OF RUTLAND  
**VERMONT ROUTE 103**  
LUDLOW-RUTLAND ROAD

BEGINNING AT A POINT 287 FEET SOUTHEASTERLY OF THE SHREWSBURY-CLARENDON TOWNSHIP LINE AND EXTENDING NORTHWESTERLY 2000 FEET.

LENGTH OF PROJECT — 0.379 MILE

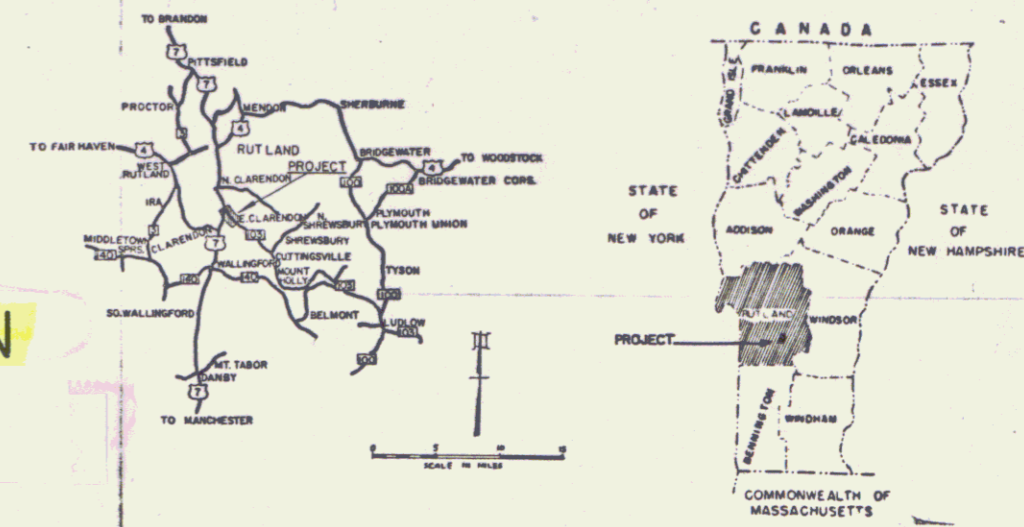

NOTE: THE SPECIFIC LOCATION OF EACH SHRUB AND TREE WILL BE MADE BY THE STATE LANDSCAPE ENGINEER IN THE FIELD PRIOR TO ANY PLANTING BEING PERFORMED BY THE CONTRACTOR. SUCH LOCATIONS WILL BE IN ACCORDANCE WITH THE 1959 "GUIDE FOR SHOWING ROADSIDE IMPROVEMENTS ON PROJECT PLANS," THE 1961 A.A.S.H.O. PUBLICATION "A POLICY ON LANDSCAPE DEVELOPMENT FOR THE NATIONAL SYSTEM OF INTERSTATE AND DEFENSE HIGHWAYS" AND OTHER SUPPLEMENTARY LOCATION REQUIREMENTS WHICH ARE NOW OR MAY BECOME EFFECTIVE.

PROJECT NAME & NUMBER SHREWSBURY-CLARENDON CJF 025-1(1)	TYPE LANDSCAPING
RECORD PLANS - SOURCE OF MATERIALS ROBERT W. BAKER, COMM. McCarthy	
CONTRACTOR - McCarthy's Tree, Landscaping and Spraying Service NO. ADAMS, MASS. RESIDENT ENGINEER - F. MCCOY INSPECTOR - L. MASURE	CONTRACT DATED 7/31/67 STARTED 9/28/67 COMPLETED 11/1/67
RECORD PLANS - R.A. HAY	ACCEPTED 11/1/67

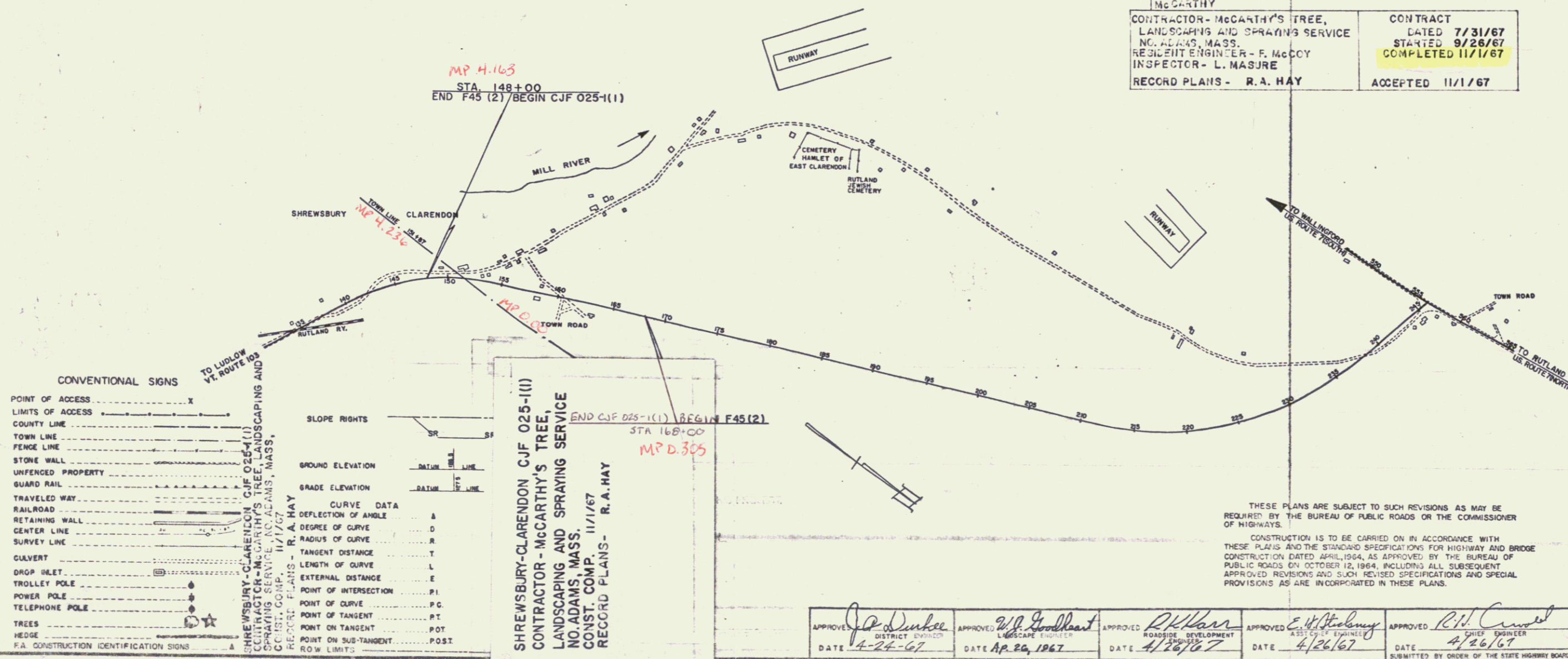

CONVENTIONAL SIGNS

POINT OF ACCESS	X
LIMITS OF ACCESS	---
COUNTY LINE	---
TOWN LINE	---
FENCE LINE	---
STONE WALL	---
UNFENCED PROPERTY	---
GUARD RAIL	---
TRAVELED WAY	---
RAILROAD	---
RETAINING WALL	---
CENTER LINE	---
SURVEY LINE	---
CULVERT	---
DROP BLET	---
TROLLEY POLE	---
POWER POLE	---
TELEPHONE POLE	---
TREES	---
HEDGE	---
P.A. CONSTRUCTION IDENTIFICATION SIGNS	---

SHREWSBURY-CLARENDON CJF 025-1(1)  
CONTRACTOR - MCCARTHY'S TREE, LANDSCAPING AND SPRAYING SERVICE  
NO. ADAMS, MASS.  
CONST. COMP. 11/1/67  
RECORD PLANS - R.A. HAY

THESE PLANS ARE SUBJECT TO SUCH REVISIONS AS MAY BE REQUIRED BY THE BUREAU OF PUBLIC ROADS OR THE COMMISSIONER OF HIGHWAYS.  
CONSTRUCTION IS TO BE CARRIED ON IN ACCORDANCE WITH THESE PLANS AND THE STANDARD SPECIFICATIONS FOR HIGHWAY AND BRIDGE CONSTRUCTION DATED APRIL, 1964, AS APPROVED BY THE BUREAU OF PUBLIC ROADS ON OCTOBER 12, 1964, INCLUDING ALL SUBSEQUENT APPROVED REVISIONS AND SUCH REVISED SPECIFICATIONS AND SPECIAL PROVISIONS AS ARE INCORPORATED IN THESE PLANS.

APPROVED <i>J.P. Dunbar</i> DISTRICT ENGINEER DATE 4-24-67	APPROVED <i>W.J. Goodheart</i> LANDSCAPE ENGINEER DATE AP. 20, 1967	APPROVED <i>R.K. Harr</i> ROADSIDE DEVELOPMENT ENGINEER DATE 4/26/67	APPROVED <i>E.W. Stebbins</i> ASST. CHIEF ENGINEER DATE 4/26/67	APPROVED <i>R.W. Carroll</i> CHIEF ENGINEER DATE 4/26/67
--	---	--	---	--

Pin # 00R125

DEPARTMENT OF TRANSPORTATION  
BUREAU OF PUBLIC ROADS

APPROVED \_\_\_\_\_  
DIVISION ENGINEER DATE \_\_\_\_\_

PROJECT CJF NO. 025-1(1)  
SHEET 1 OF SHEETS

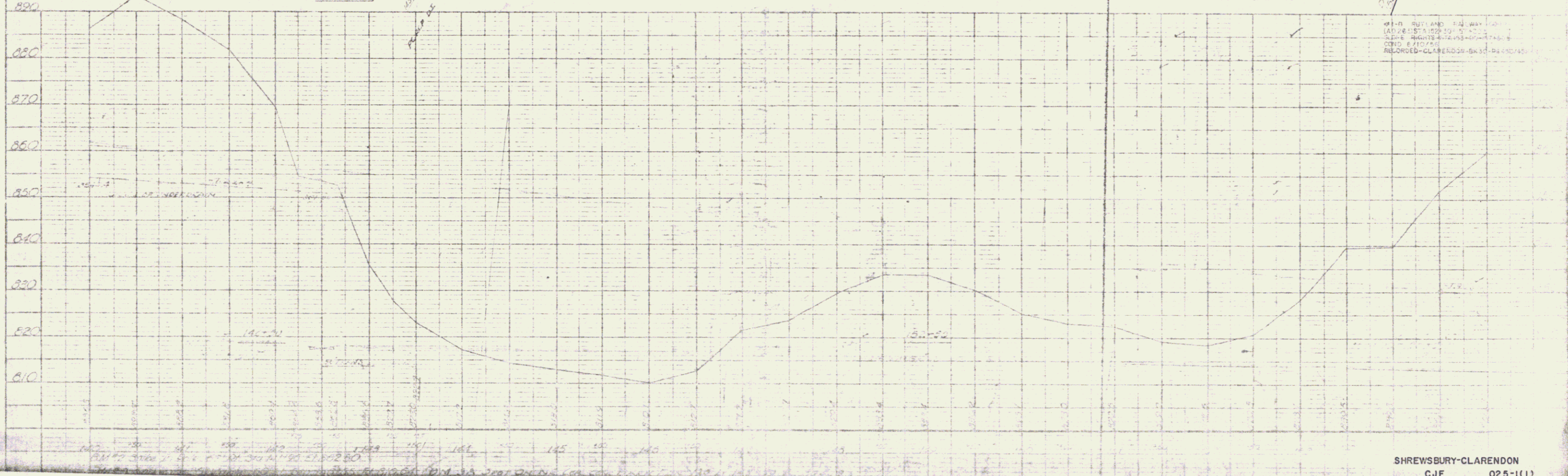
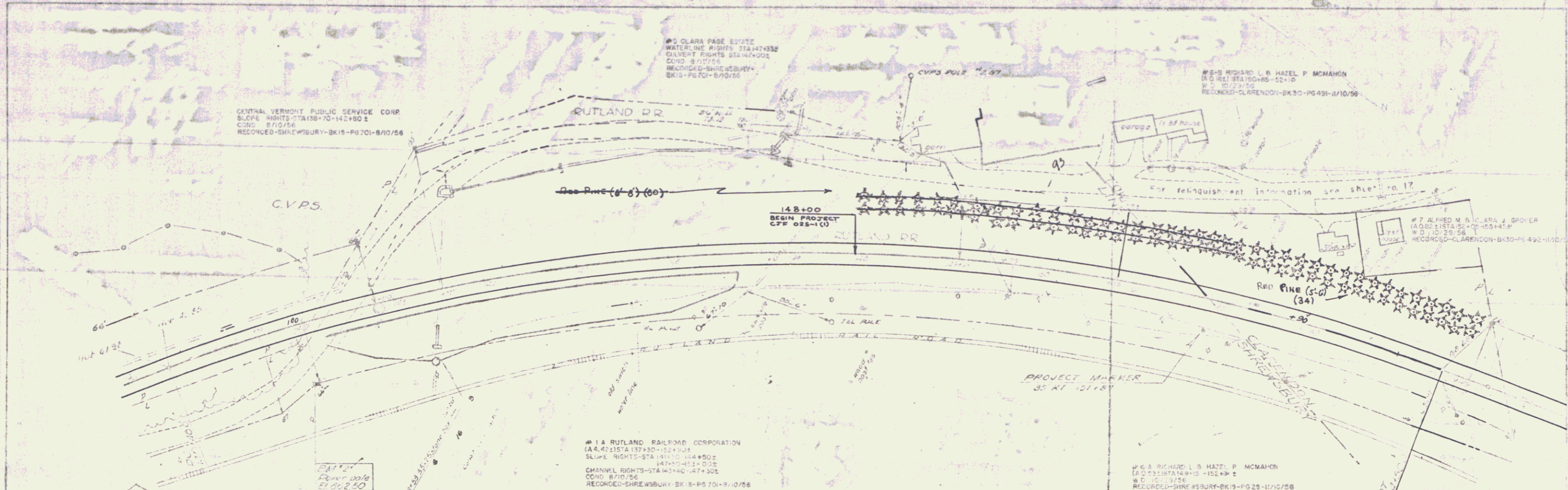

DATE: 11/10/56  
 DRAWN BY: [illegible]  
 CHECKED BY: [illegible]  
 TITLE: [illegible]

DATE: 11/10/56  
 DRAWN BY: [illegible]  
 CHECKED BY: [illegible]  
 TITLE: [illegible]

SHREWSBURY-CLARENDON  
 C.J.F. 025-1(1)  
 6 7

#1-C WALTER B. MINNIE & BLANCHARD  
(A.C. 9215131-140-14641 (SIDE LINE))  
COND. 8/10/56  
RECORDED-CLARENDON-BK 30-PG 450/458-8/10/56

0+50 2+25 735

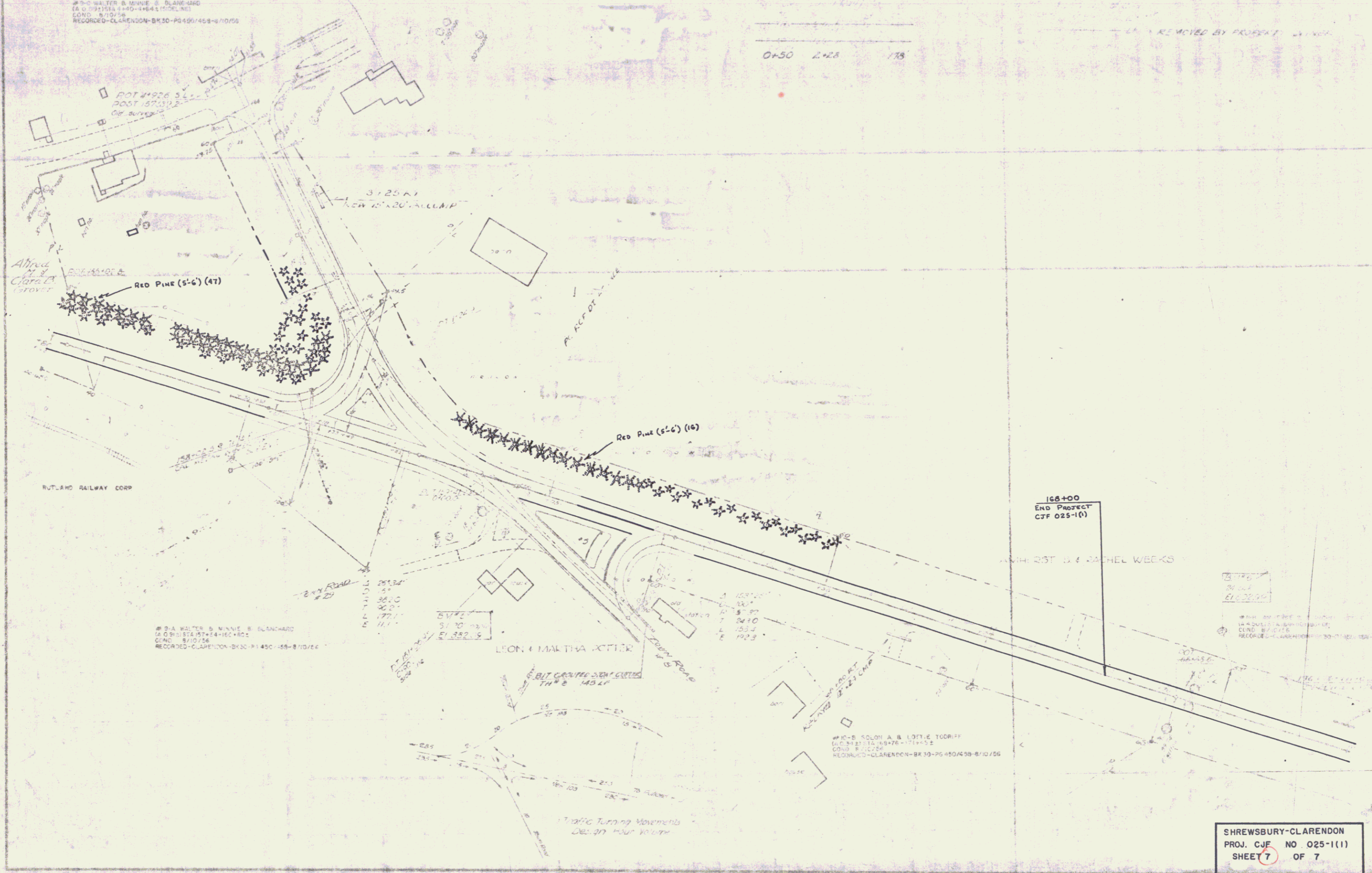

#1-A WALTER B. MINNIE & BLANCHARD  
(A.C. 9215131-140-14641 (SIDE LINE))  
COND. 8/10/56  
RECORDED-CLARENDON-BK 30-PG 450/458-8/10/56

STAKE  
3+20  
5+22.5

LEON & MARTHA POTTER

BIT CARBIDE SIGN CLUSTERS  
TH 2 140 LF

#10-B SOLOH A. & LOYD E. TODRIF  
(A.C. 9215131-140-14641 (SIDE LINE))  
COND. 8/10/56  
RECORDED-CLARENDON-BK 30-PG 450/458-8/10/56

165+00  
END PROJECT  
CJF 025-1(1)

ASHTON ST. & RACHEL WEEKS

165+00  
165+00  
165+00

#10-B SOLOH A. & LOYD E. TODRIF  
(A.C. 9215131-140-14641 (SIDE LINE))  
COND. 8/10/56  
RECORDED-CLARENDON-BK 30-PG 450/458-8/10/56

SHREWSBURY-CLARENDON  
PROJ. CJF NO 025-1(1)  
SHEET 7 OF 7