

PLAN
 DATE 10/11/28
 DRAWN BY
 CHECKED BY
 APPROVED BY

PLAN
 DATE 10/11/28
 DRAWN BY
 CHECKED BY
 APPROVED BY

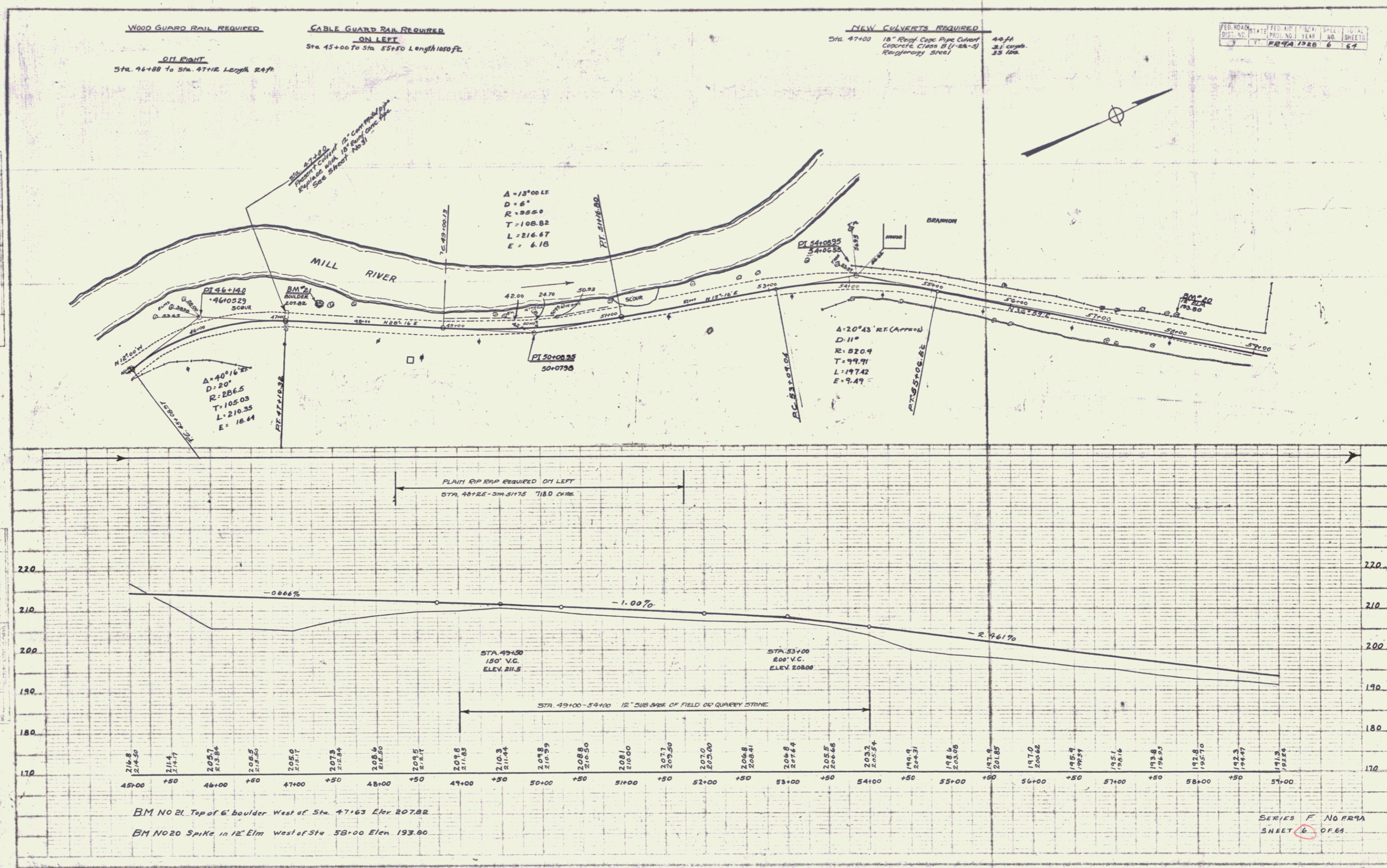

WOOD GUARD RAIL REQUIRED
 ON RIGHT
 Sta. 46+00 to Sta. 47+12 Length 24 ft

CABLE GUARD RAIL REQUIRED
 ON LEFT
 Sta. 45+00 to Sta. 55+50 Length 1050 ft.

NEW CULVERTS REQUIRED
 Sta. 47+00 16" Rein. Conc. Pipe Culvert
 CONCRETE CLASS B (1-24-2)
 Roughness .0001
 44 ft
 31 cu yds
 33 lbs

FED. ROAD DIST. NO.	STATE	FED. AID PROJ. NO.	YEAR	SHEET NO.	TOTAL SHEETS
7	PA	FR9A	1928	6	67

BM NO 21 Top of 6' boulder West of Sta. 47+63 Elev. 207.82
 BM NO 20 Spike in 12" Elm West of Sta. 58+00 Elev. 193.80

SERIES F NO FR9A
 SHEET 6 OF 65