

INDEX OF SHEETS

SHEET NO.	TITLE PAGE
2	TYPICAL CROSS-SECTION OF IMPROVEMENT
3	PLAN AND PROFILE STA. 0+00 TO STA. 11+00
4	" " 11+00 " " 23+83
5-7	CROSS SECTIONS

FED. ROAD DIST. NO.	STATE	FED. AID PROJ. NO.	TOTAL SHEETS	TOTAL SHEETS
9	Vt.	57	1	7

STATE OF VERMONT  
STATE HIGHWAY DEPARTMENT

PLAN AND PROFILE OF PROPOSED  
STATE HIGHWAY  
FEDERAL AID PROJECT  
TOWNS OF  
WALLINGFORD AND MT. HOLLY  
RUTLAND—LUDLOW ROAD  
FROM JOSEPH BULLEY HOUSE TO WILL COLE HOUSE

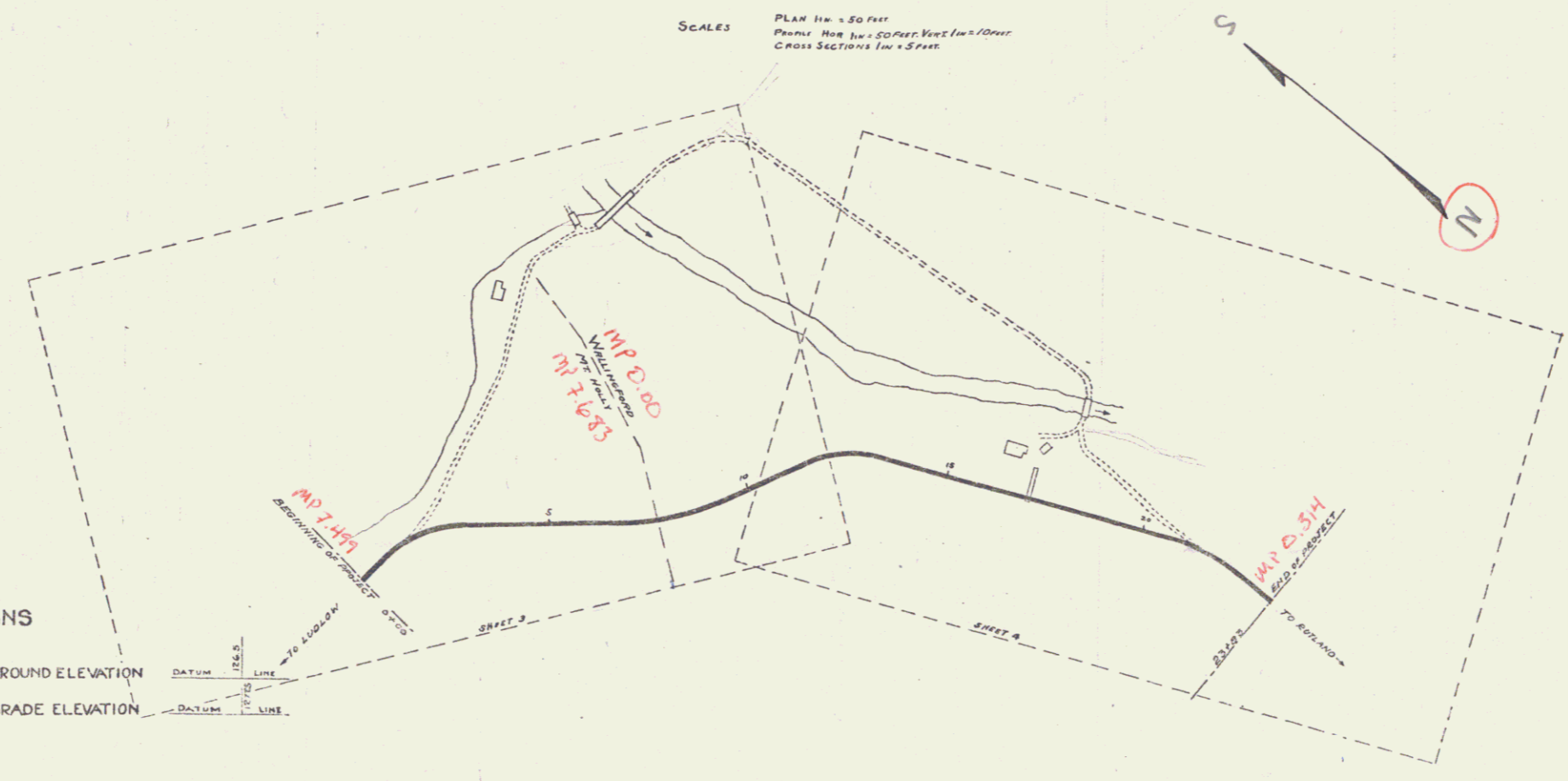
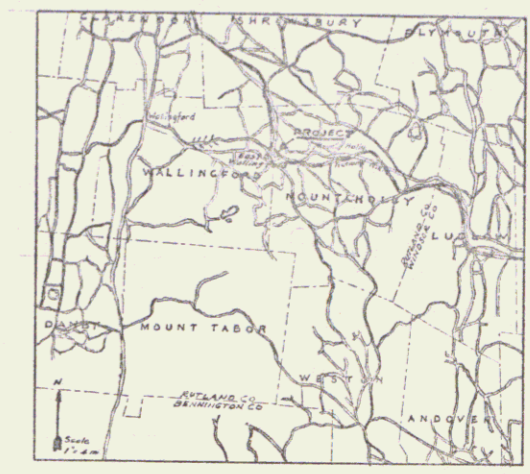

SCALES  
PLAN 1" = 50 FEET  
PROFILES 1" = 50 FEET VERT. 1" = 10 FEET  
CROSS SECTIONS 1" = 5 FEET

RIGHT-OF-WAY DIVISION  
TOWN FILE  
PERPETUAL  
*Rte*  
TOWNS OF VT 103  
(To Be Returned To R.O.W. Division)

SUBMITTED BY ORDER OF THE STATE HIGHWAY BOARD  
[Signature]  
CHIEF ENGINEER  
DEPARTMENT OF HIGHWAYS

- CONVENTIONAL SIGNS
- COUNTY LINE
  - TOWN LINE
  - FENCE LINE
  - STONE WALL
  - UNFENCED PROPERTY
  - GUARD RAIL
  - TRAVELED WAY
  - RAILROAD
  - RETAINING WALL
  - CENTER LINE
  - SURVEY LINE
  - CULVERT
  - DROP INLET
  - TROLLEY POLE
  - POWER POLE
  - TELEPHONE POLE
  - TREES
  - HEDGE

GROUND ELEVATION DATUM [Symbol]  
GRADE ELEVATION DATUM [Symbol]

CURVE DATA  
DEFLECTION ANGLE Δ  
DEGREE OF CURVE D.  
RADIUS OF CURVE R.  
TANGENT DISTANCE T.  
LENGTH OF CURVE L.  
EXTERNAL DISTANCE E.  
POINT OF INTERSECTION P.I.  
POINT OF CURVE P.C.  
POINT OF TANGENT P.T.

LAYOUT 1" = 200 FT

Project F 51  
Pin # 00R117  
Route VT103  
Date 1/1/1922

RECOMMENDED [Signature]  
DISTRICT ENGINEER  
BUREAU OF PUBLIC ROADS  
RECOMMENDED FOR APPROVAL [Signature]  
CHIEF ENGINEER  
BUREAU OF PUBLIC ROADS  
APPROVED [Signature]  
DIRECTOR - BUREAU OF PUBLIC ROADS

SERIES E No. FILED  
SHEET 1 OF 7

DIST. # 3 PLANS

*Wallingford + Mt. Holly*

*Wallingford*