

Note: Shaded area represents new construction along the Center Lines as shown which is to be given a Double Tack Coat of Refined Tar (item 29).

Note: Approach to Mt Holly left of Sta. 153+75.2 and approach to Railroad Station right of Sta. 153+75.2, shown in cross-hatched area, to be given a Double Tack Coat of Refined Tar (item 29).

Note: Areas on right of Sta. 153+75.2 not covered by above requirements to be graded as required and, if ordered by the Engineer, shall be given a Double Tack Coat of Refined Tar (item 29).

FED. ROAD DIST. NO.	STATE	FED. AID FISCAL YEAR	SHEET NO.	TOTAL SHEETS
58-0-0	VT	1942	1	4

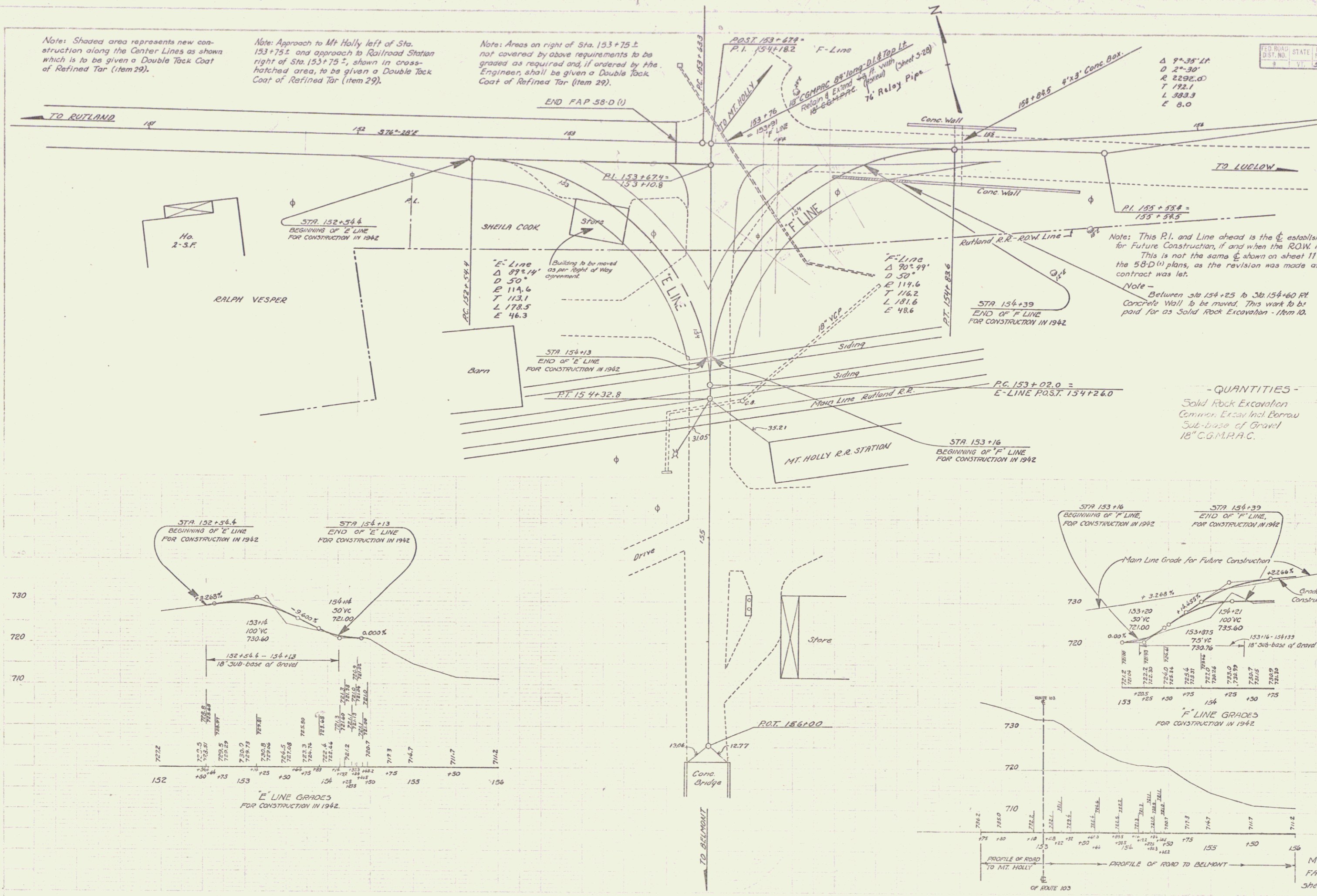

Note: This P.I. and Line ahead is the  $\phi$  established for Future Construction, if and when the ROW is obtained. This is not the same  $\phi$  shown on sheet 11 of 71 of the 58-D(1) plans, as the revision was made after the contract was let.

Note - Between Sta 154+25 to Sta 154+60 Rt Concrete Wall to be moved. This work to be paid for as Solid Rock Excavation - Item 10.

- QUANTITIES -

Solid Rock Excavation	10	cuyds.
Common Excav Incl Borrow	42.5	cuyds.
Sub-base of Gravel	550	cuyds.
18" C.G.M.P.A.C.	42	lin.ft.

