

THIS IS PART OF THE SAME LAND AND PREMISES ACQUIRED BY THE STATE OF VERMONT FROM FREEMAN E. AND LOUISE H. BUSSINO BY WDOE DATED JAN. 12, 1959 AND RECORDED JAN. 16, 1959 IN BOOK 27, PAGE 363 OF THE RECORDS OF THE TOWN OF MT. HOLLY.

STATE OF VERMONT
TO
SHERRIE SURETHING
BY QCD ON 1/17/89
REC'D IN BK 42/207-08

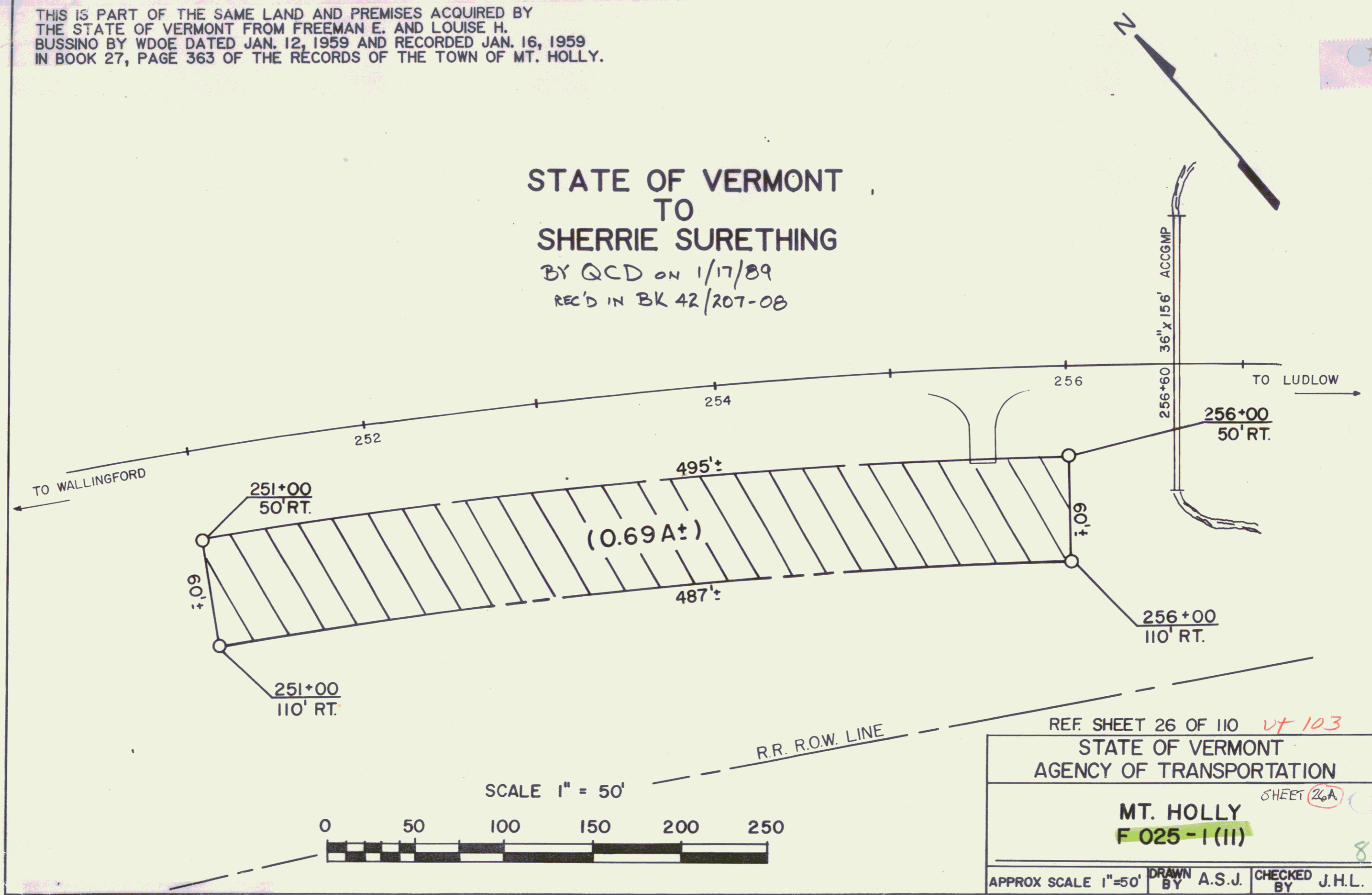

REF. SHEET 26 OF 110 *vt 103*
STATE OF VERMONT
AGENCY OF TRANSPORTATION

MT. HOLLY
F 025-1(II)

SHEET 26A

APPROX SCALE 1"=50' DRAWN BY A.S.J. CHECKED BY J.H.L.