

THREE CABLE GUARD RAIL WITH STEEL POSTS  
218+50-222+00

CS L. & FRANCES C. WINSLOW

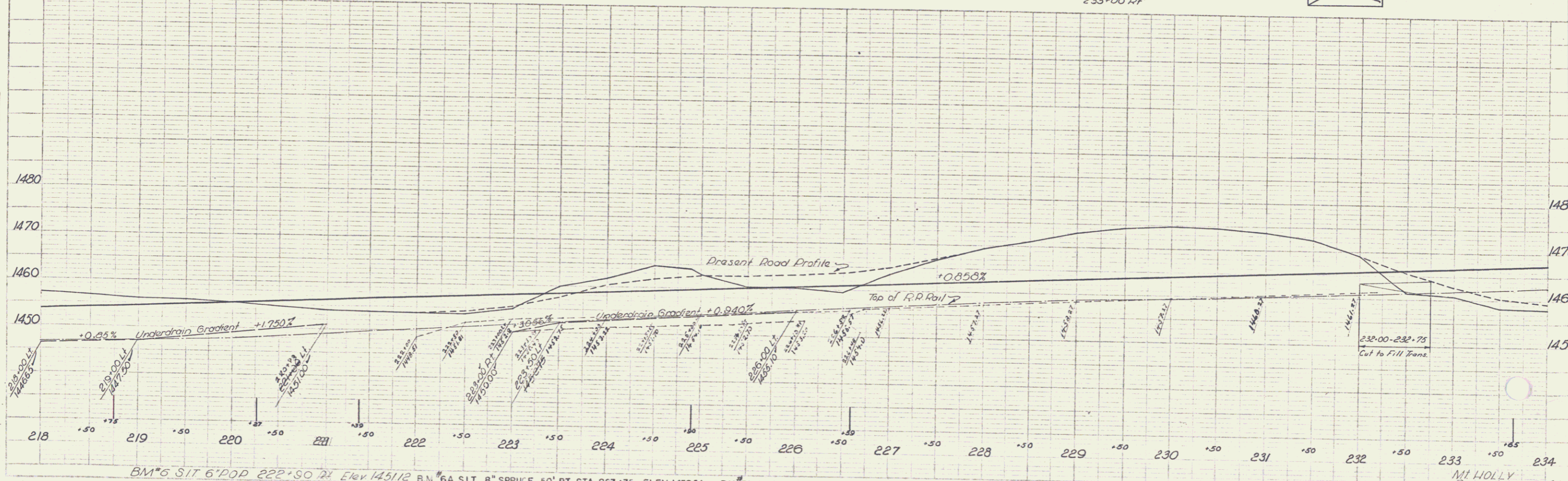
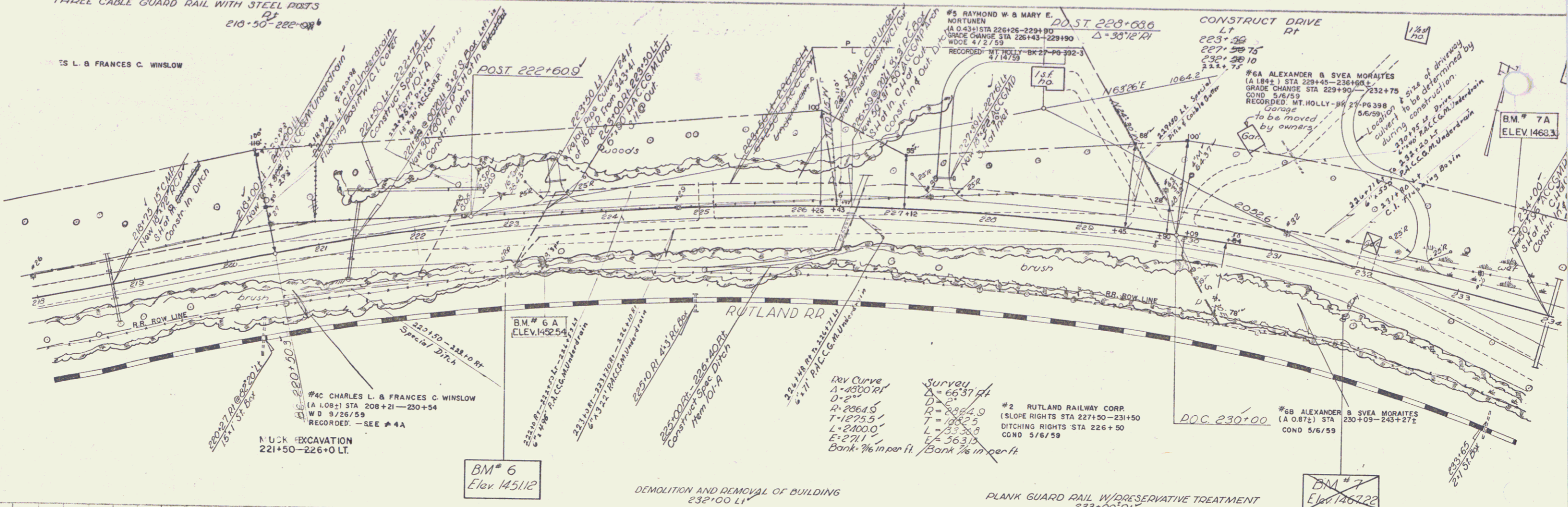

PLAN  
M.Y. H.X. - MR. 923

2-30  
3-30  
3-30  
M.Y. H.X. - MR.

BM#6 SIT 6" POP 222+50 RT. Elev. 1451.12    BM#6A S.I.T. 8" SPRUCE 50' RT. STA. 223+35 ELEV. 1452.54    BM#7A SPOT ON BULDER 75' LT. STA. 233+40 ELEV. 1468.30    BM#7 SIT 8" CHY. 231+87 RT. Elev. 1467.22

MT HOLLY  
Project F-025-1(11)  
Sheet 110