

GUARD RAIL REQUIRED
 ON LEFT
 Sta 18+51 to Sta 18+75 Length 24 ft
 " 24+20 " " 26+12 " 192 "
 " 29+38 " " 29+62 " 24 "
 ON RIGHT
 Sta 17+04 to Sta 17+72 Length 68 ft
 " 18+51 " " 18+75 " 24 "
 " 24+20 " " 26+12 " 192 "
 " 29+38 " " 29+62 " 24 "
 Total this sheet 348 ft

NEW CULVERTS REQUIRED
 Sta 18+63 3-3 Rein. Con. Culvert
 1-2 1/2-3 Con. 11.7 Cuyds
 1-2-8 Con. 3.5 " "
 Rein. Steel 180#
 Sta 26+00 2-8 Rein. Con. Culvert
 1-2 1/2-3 Con. 3.8 Cuyds
 1-2-4 Con. 3.1 " "
 Rein. Steel 75#
 Sta 29+50 2-2 Rein. Con. Culvert
 1-2 1/2-3 Con. 3.4 Cuyds
 1-2-4 Con. 3.1 Cuyds
 Rein. Steel 75# C. L. WINSLOW

PLD. ROAD DIST. NO.	STA.	FISCAL YEAR	SHEET NO.	TOTAL SHEETS
150 A	1923	7	27	

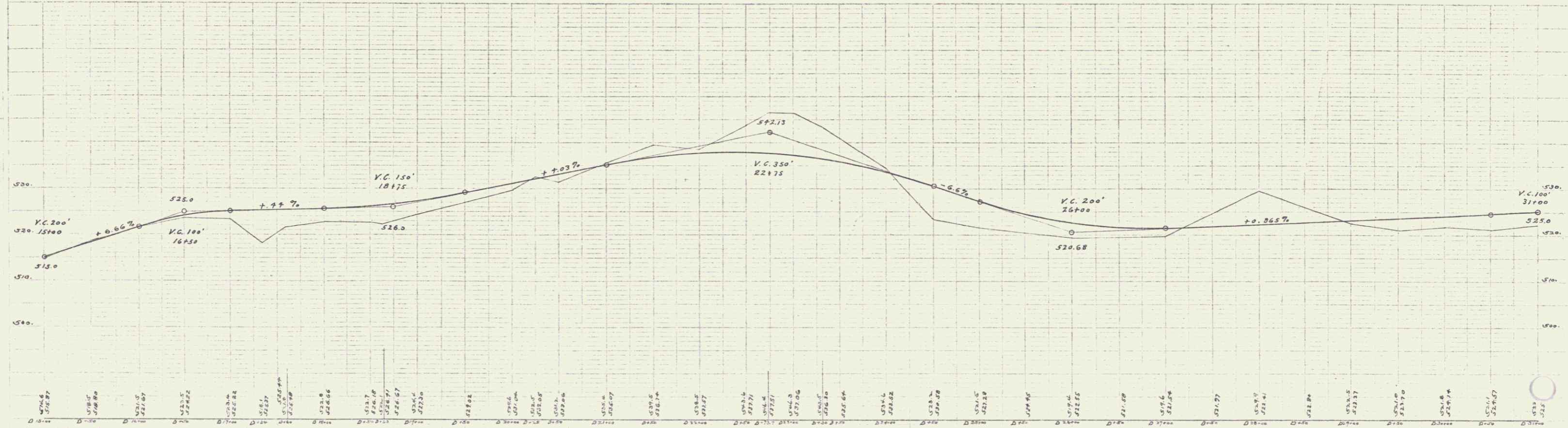
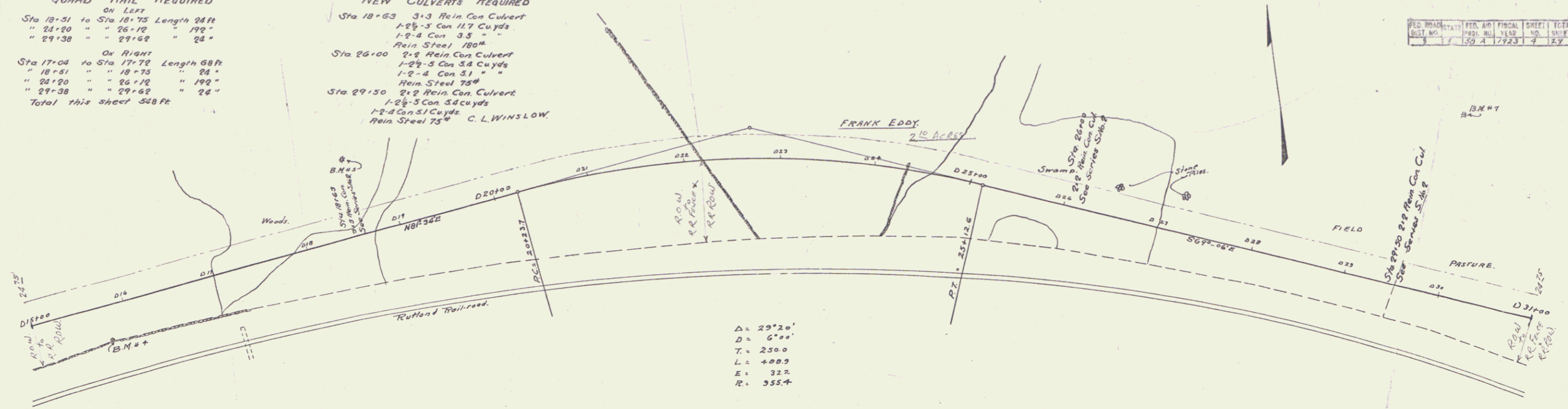

B.M. #4	Spike in 12" Spruce right of Sta 15+72	Elev. 517.74
B.M. #5	Spike in 8" Spruce left of Sta 18+56	Elev. 533.78
B.M. #6	Boulder Sta 24+75	Elev. 538.95
B.M. #7	Spike in 12" Apple tree left of Sta 30+91	Elev. 537.56

Series 1 of 20
 3