

(To Be Returned to R.O.M. Division)  
 Form of VT 102  
 PERMIT  
 TOWN FILE  
 RIGHT-OF-WAY DIVISION

$\Delta = 30^{\circ}14'12''$   
 $D = 3^{\circ}45'$   
 $T = 412.82$   
 $L = 806.22$   
 $E = 5^{\circ}78'$

PLAN  
 CHECKED BY: \_\_\_\_\_  
 DATE: \_\_\_\_\_  
 DRAWN BY: \_\_\_\_\_  
 DATE: \_\_\_\_\_  
 NOTE BOOK NO. \_\_\_\_\_  
 SHEET NO. \_\_\_\_\_  
 NO. \_\_\_\_\_

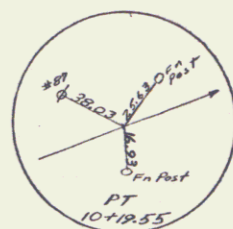
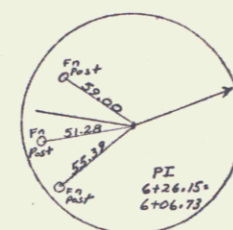
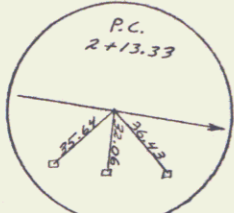
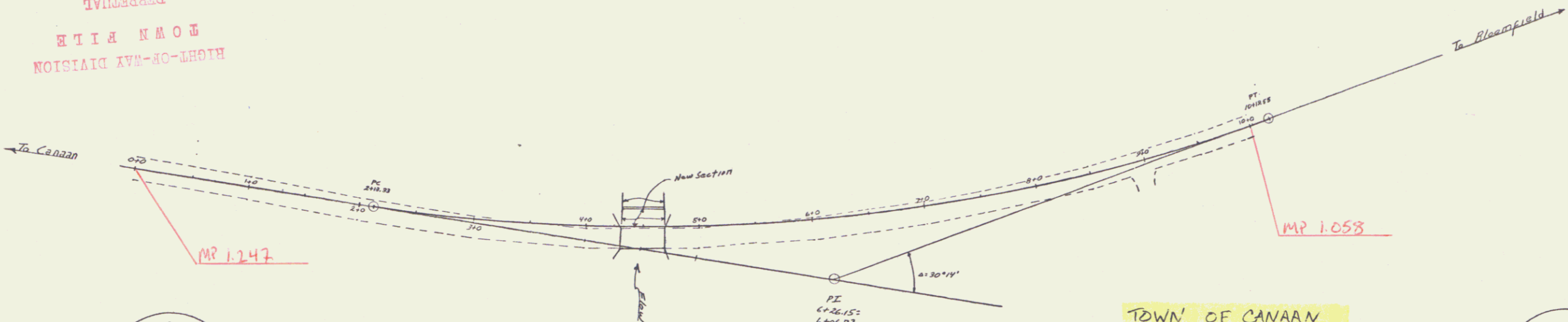

TOWN OF CANAAN  
 Project BMA 622B  
 Pin # 00R103  
 Route VT102  
 Date 1/1/1973

PROFILE  
 CHECKED BY: \_\_\_\_\_  
 DATE: \_\_\_\_\_  
 DRAWN BY: \_\_\_\_\_  
 DATE: \_\_\_\_\_  
 NOTE BOOK NO. \_\_\_\_\_  
 SHEET NO. \_\_\_\_\_  
 NO. \_\_\_\_\_

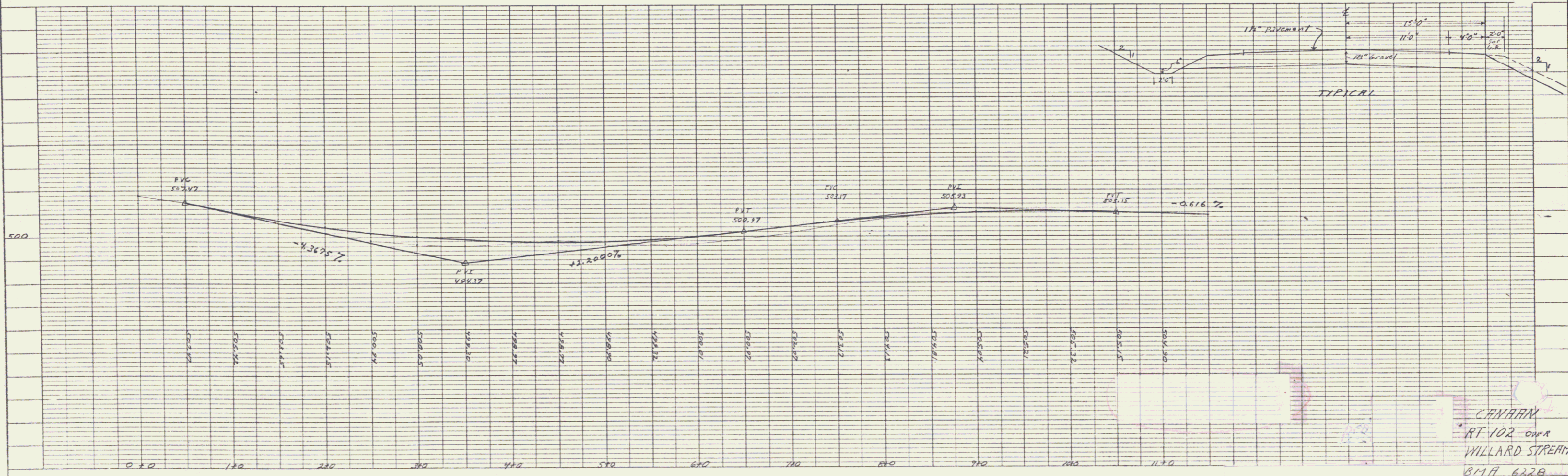

CANAAN  
 RT 102 OVER  
 WILLARD STREAM  
 BMA 622B  
 SHEET 1