

RESIDENT ENGINEER - FRANK B. GAMSBY
 INSPECTORS - J. MARTIN, R. MICHAEL
 RECORD PLANS - D. BARTLETT & A. SPIDLE

STARTED - AUGUST 17, 1960
 COMPLETED - JUNE 14, 1961
 ACCEPTED - JUNE 14, 1961

66+00.0 68+00.0
 END PROJECT BEGIN PROJECT
 ST 161 (N) S-0271 (3)

MP 1.44%

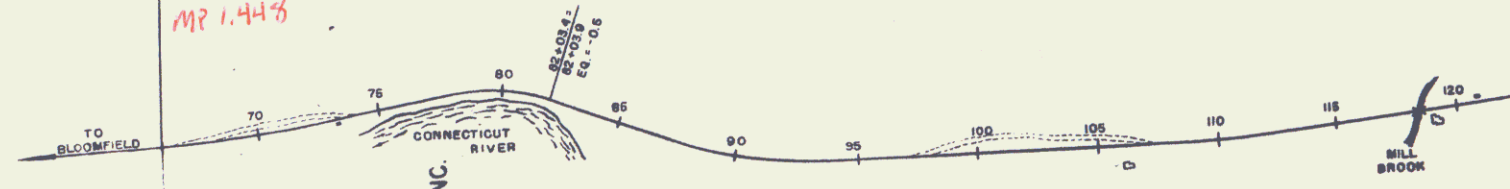

CONCRETE PAVEMENT

DESIGN 2.311
 SAND & GRAVEL
 YEAR 1960-61
 POINT APPROXIMATELY 1.3 MILES NORTH OF THE JUNCTION
 OF VT Rte 104 AND EXTENDING NORTHEASTERLY

S-0271(3)
 ALEDONIA SAND & GRAVEL CO. INC.
 ST. JOHNSBURY, VT.
 D. BARTLETT & A. SPIDLE
 COMPLETED - JUNE 14, 1961

GROUND ELEVATION	DATUM	LINE
GRADE ELEVATION	DATUM	LINE
CURVE DATA		
DEFLECTION OF ANGLE	A	
DEGREE OF CURVE	D	

TITLE
 SCALES
 1" = 400'

W.D.O.E. 7/27/60
REC. BLOOMFIELD BK16 PG 435
8/5/60

#2 NELLIE H. BOUDLE
(SQ FT 2000±) STA 71+15-71+65±
COND. 7/21/60
REC. BLOOMFIELD BK16 PG 417-31
7/21/60

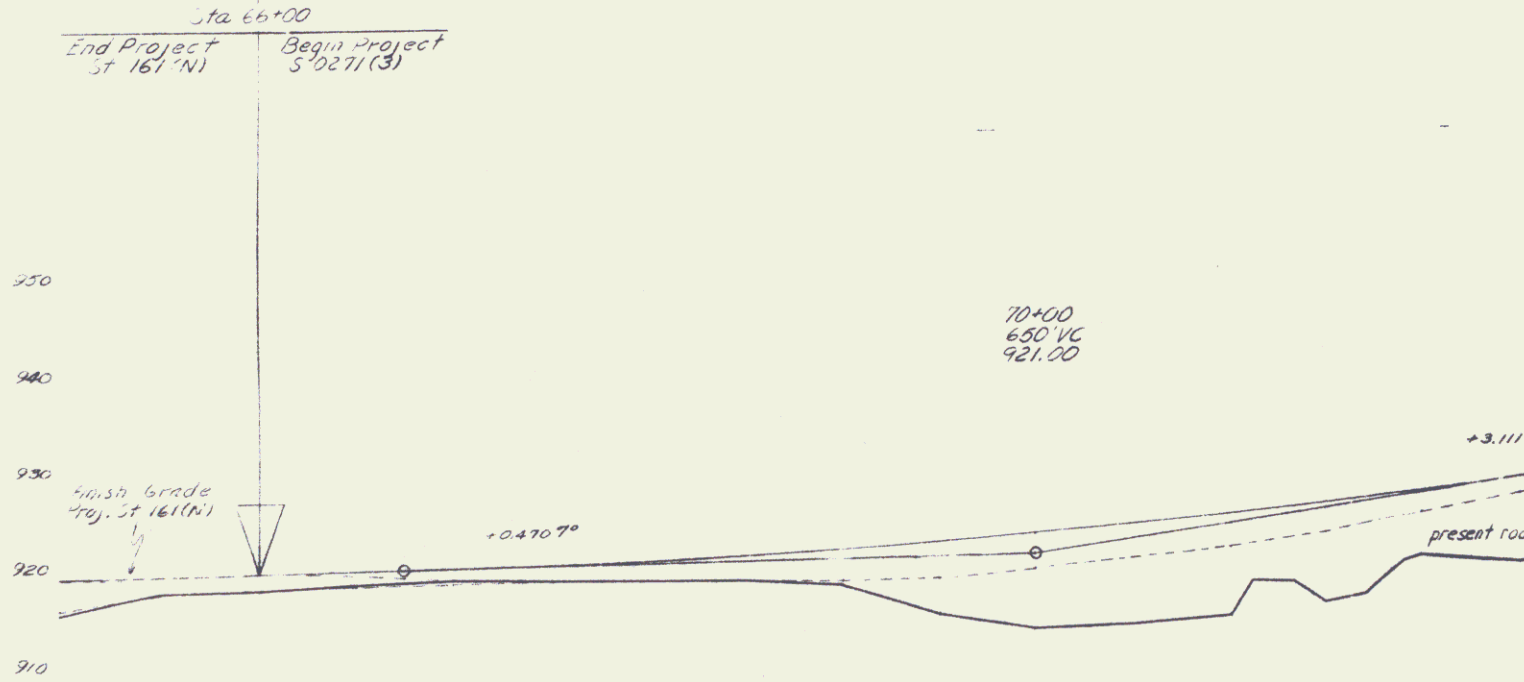

± 4A SHIRLEY J. & FLORA S. MARTIN
(A-3.4±) STA 80+75 - 102+51±
CULVERT RIGHTS STA 82+68, 85+00, 89+53, 96+72
UNDERDRAIN RIGHTS STA 95+16±
COND: 7/21/60
REC: BLODFIELD SK16 P8417-31
7/21/60

Design
Level

950
940
930
920

EQ = -0.5

REV. 82+03.4
SURF. 82+03.9

82+50
400' VC
118.50

+2.500%

present road

-0.647%

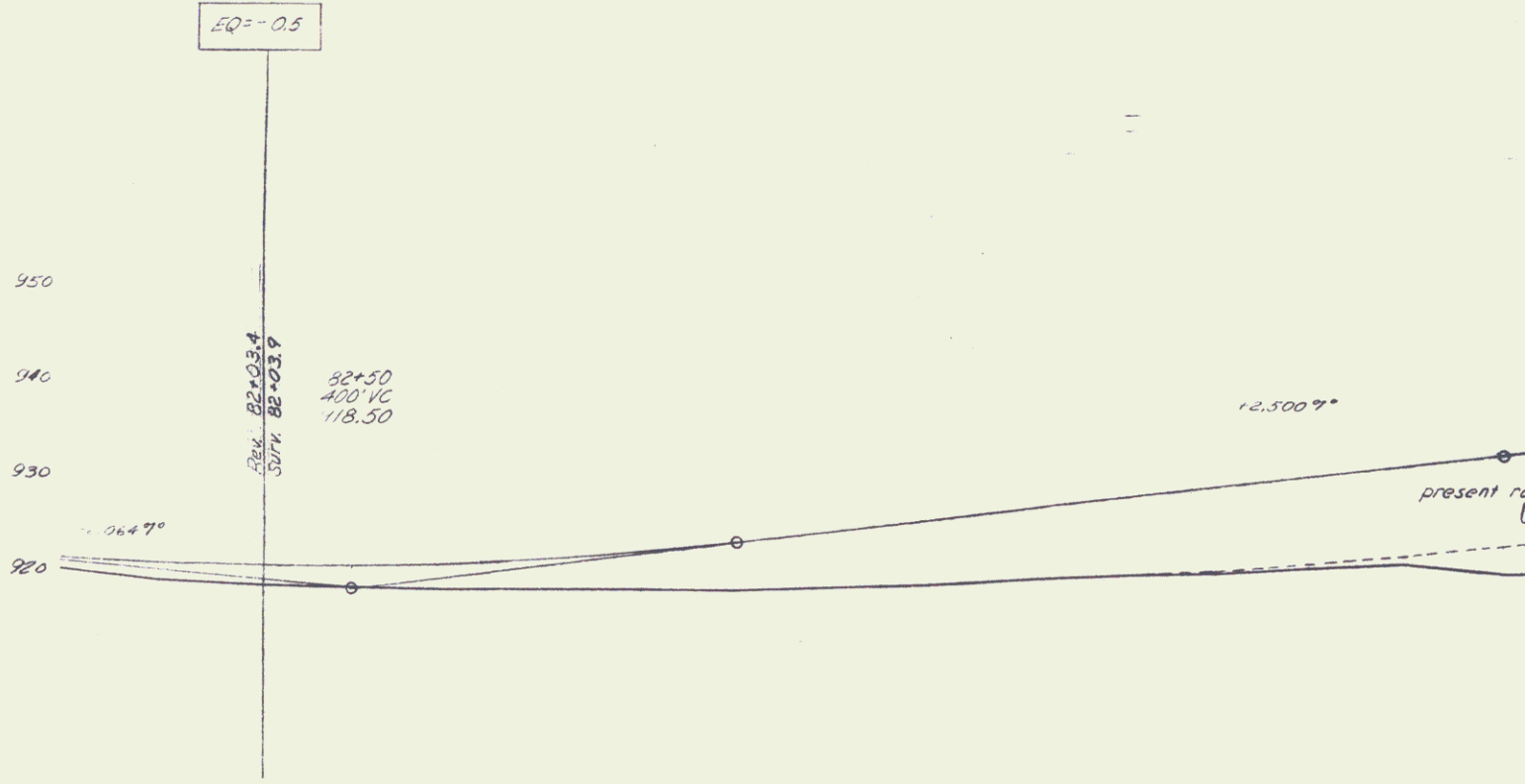

10/2/60
New 18" Inlet

10/2/60
New 18" Inlet

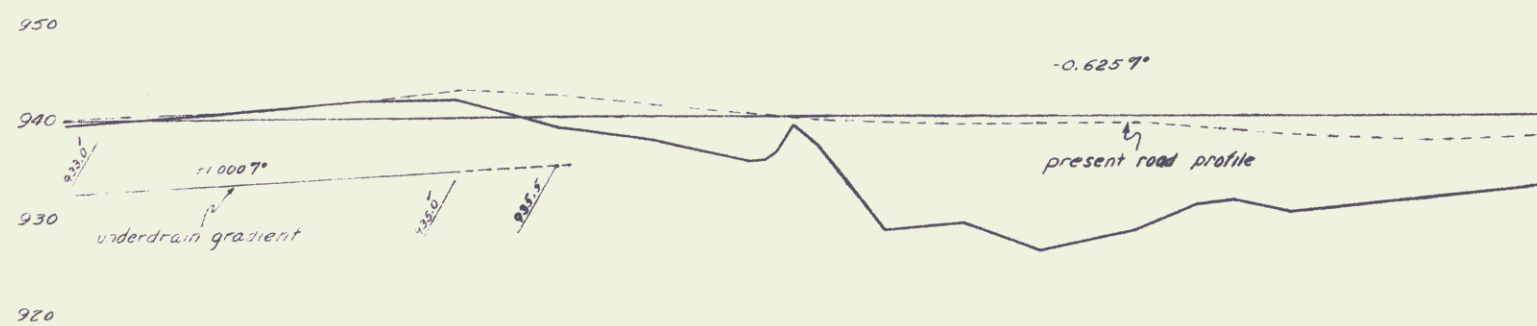

11/22/23
New 2021/06
for sheets 72822

4/16/21

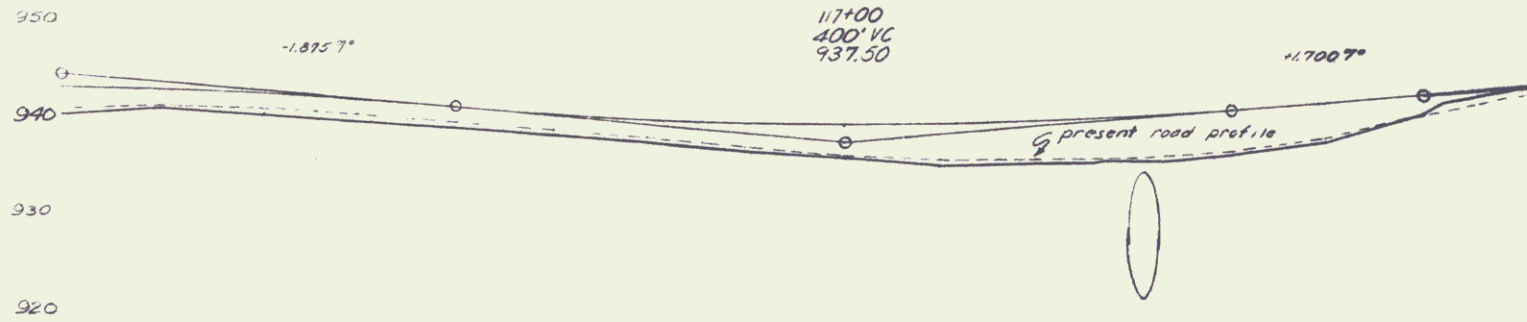

BM # 23
E.I. 950.72

PUBLIC SERVICE COMPANY OF NEW HAMPSHIRE

P/L

1000

990

980

970

960

950

11.0957°

132+50
400' VC
957.50



10" Pipe
B.M. 25-A
Elev. 988.31

1010
1000
990
980
970

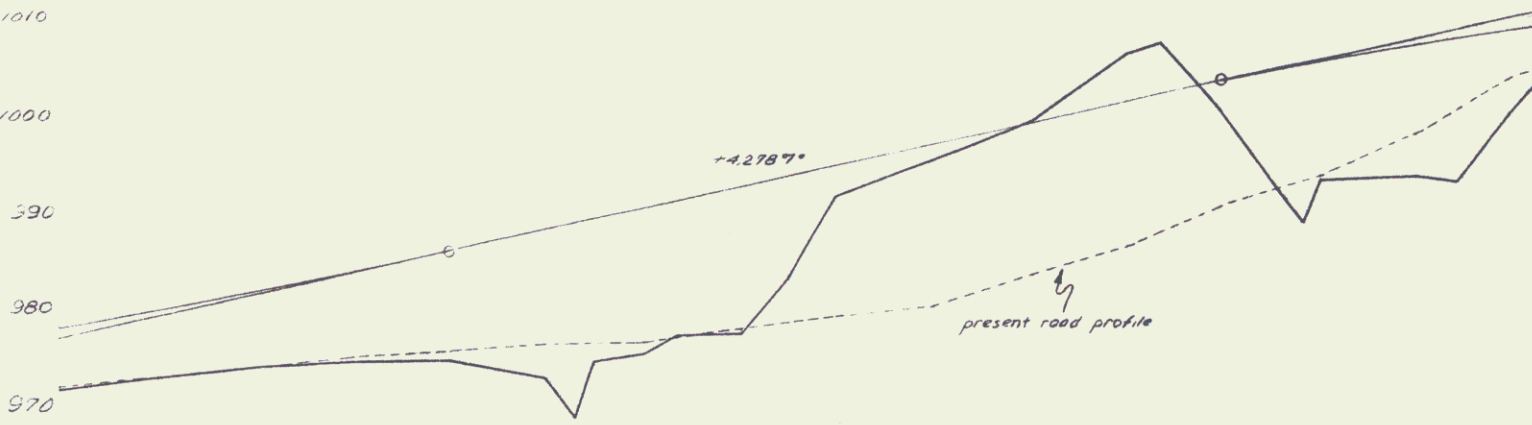

Buildings #3 & #4 - (Property owner
has the right to occupy buildings
until Sept. 1, 1960)
COND 7/21/60
REC: SEE # 6B

6B PUBLIC SERVICE COMPANY OF NEW HAMPSHIRE
(A - 0.3±) STA 160+31 - 166+05±
COND 7/21/60
REC: BLOOMFIELD BK16 PG417-31 7/21/60

*160-31
New 160-31*

1040

1030

+12927°

1020

1010

1000

990

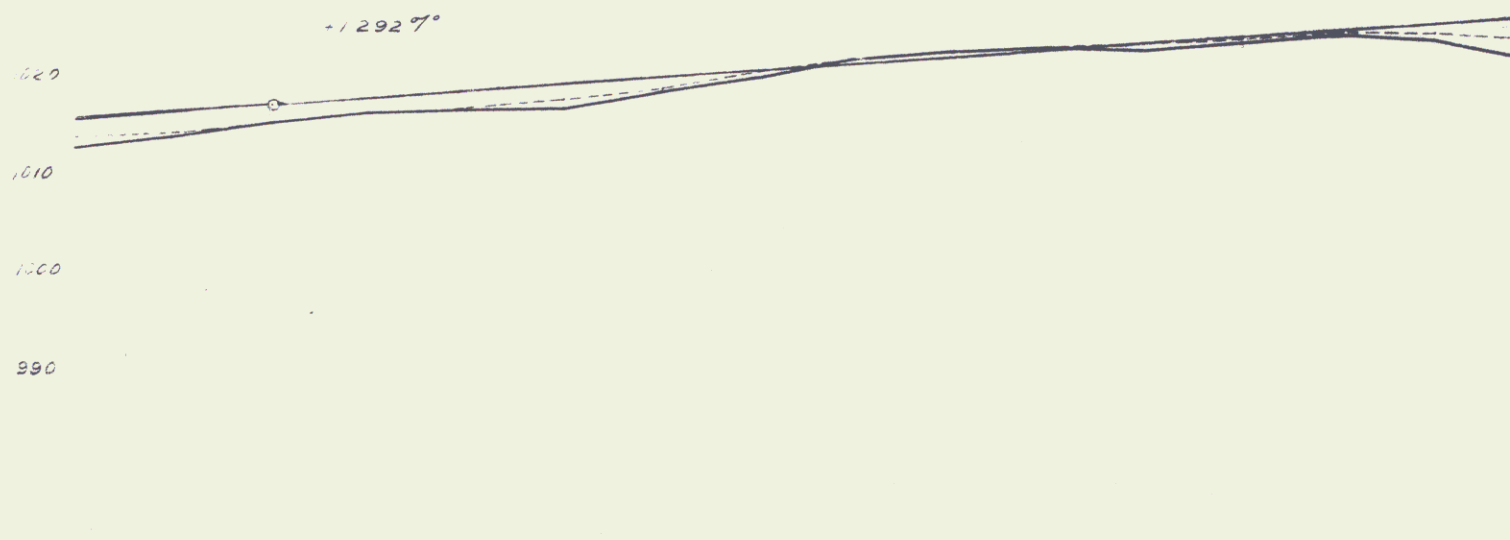

1060

+1.2867°

1050

1040

1030

1020

