

DRILLING AND BLASTING
OF SOLID ROCK SUBGRADE
205+00-206+25: 110° 35'
303+75-305+75: 35'
307+00-309+25: 811+00

WOOD GUIDE POSTS
304+00 - 305+00 R=10
304+25 - 305+00 R=10

CONSTRUCT DRIVE
Lt. Rt. 505+00
305+00 303+80

TWO CABLE GUARD RAIL
Lt. Rt. 212+25 207+50-304+00 303+75
305+50 309+82 308+72

CURVE DATA
Δ 40° 00' Lt
D 5' 15"
P 1091.35
T 397.22
L 761.90
E 700.4
Bank 3/8" in 12'

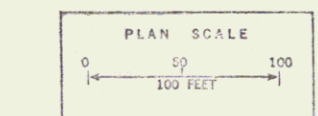
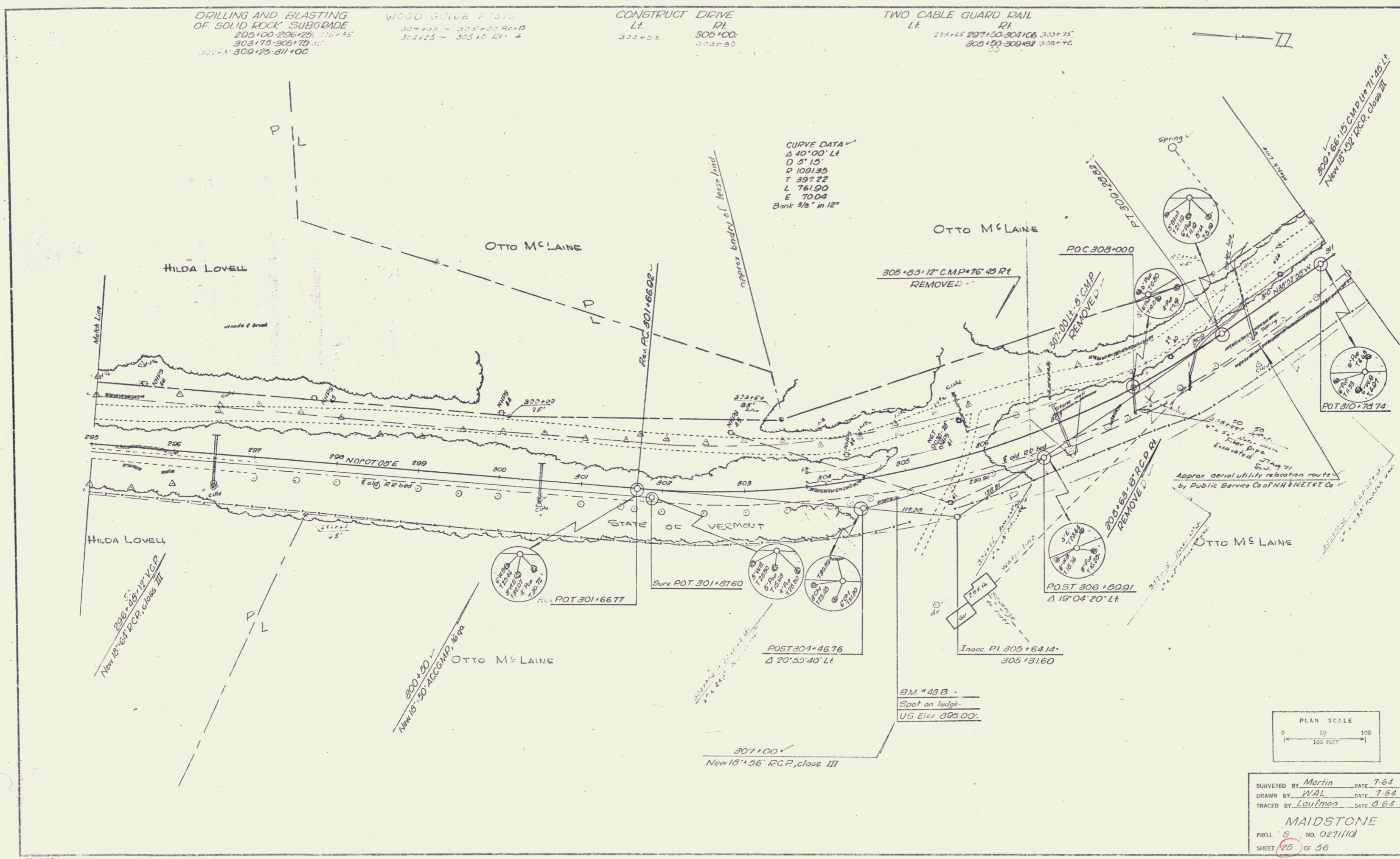

SURVEYED BY Martin DATE 7-64
DRAWN BY WAL DATE 7-64
TRACED BY Loumen DATE 8-64
MAIDSTONE
PROJ. S. NO. 027110
SHEET 25 OF 56