

<b>CONSTRUCT DRIVE</b> LT. 273+60 RT. 277+50	<b>TWO CABLE GUARD RAIL</b> LT. 263+00-266+00 RT. 263+00-271+25	<b>REMOVAL AND DISPOSAL OF PRESENT GUARD RAIL</b> LT. 263+00-279+00 RT.	<b>DRILLING AND BLASTING OF SOLID ROCK SUBGRADE</b> 271+75-277+75	<b>TREATED TIMBER CURB</b> LT. 263+00-266+00 RT. 273+76-279+00	<b>PAVED SHOULDERS</b> LT. 263+00-266+00 RT. 273+76-279+00	<b>WOOD CURB FURF</b> 271+76-271+75 RT-1E 271+83-271+82 RT-5
--	---	---	--	--	--	--

**CONSTRUCT SPECIAL DITCH**  
(to be paid for under the Item 103-A-1)  
264+00 Lt - 266+00 Lt

CONTROL OF 3 SECTIONS OF FORMER VERMONT ROUTE NO. 102, IN THE TOWN OF MAIDSTONE, AND INDICATED ON THESE PLANS, HAS BEEN RELINQUISHED AND RETURNED TO THE TOWN OF MAIDSTONE, JANUARY 31, 1967 AND RECORDED IN LAND RECORDS BOOK 12, PAGE 237 OF THE TOWN OF MAIDSTONE, FEBRUARY 7, 1967.

REV CURVE DATA  
Δ 68°00' Lt  
D 5'  
R 1140.92  
T 772.94  
L 1360.00  
E 236.31  
Bank 1/8 per ft

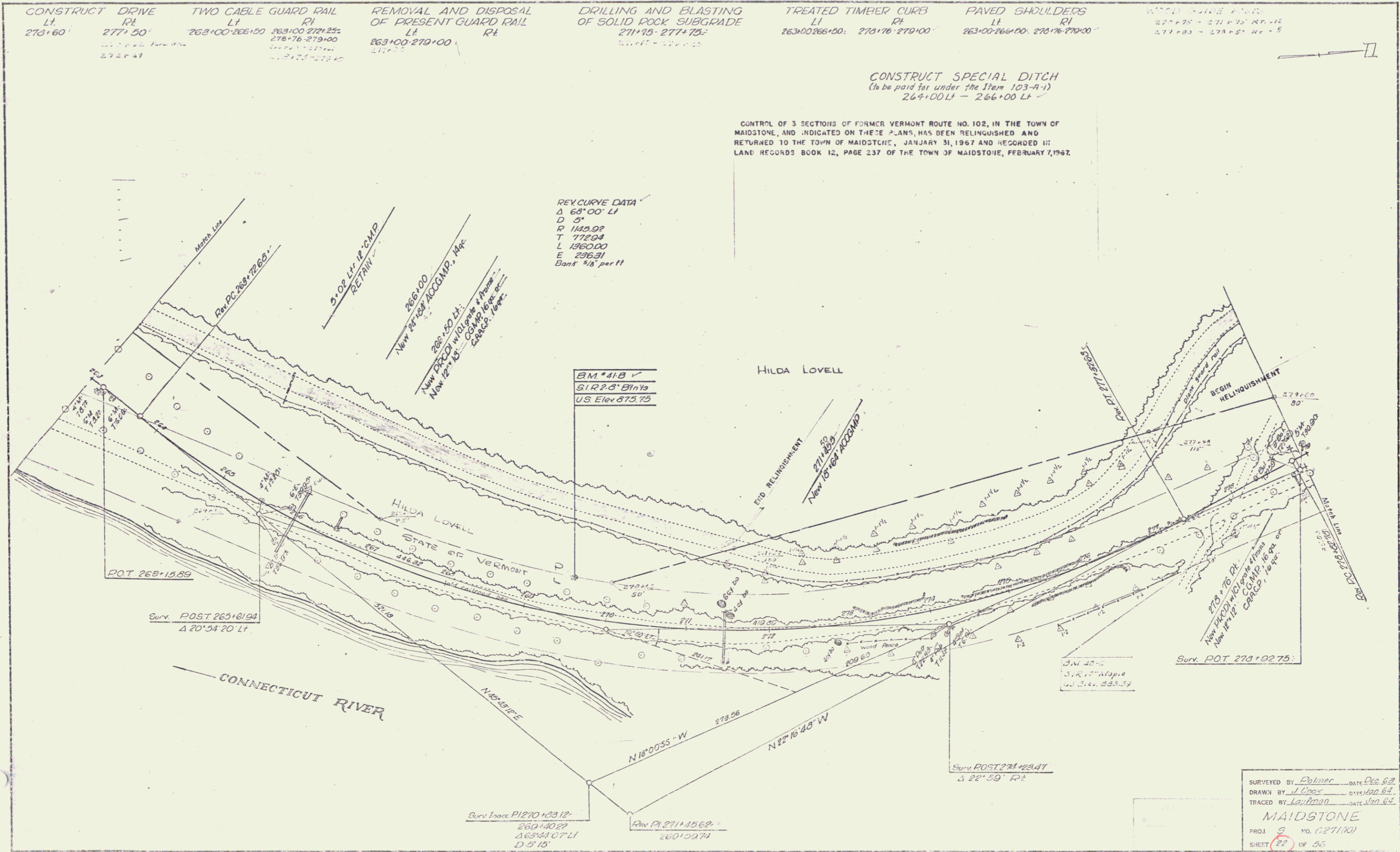

SURVEYED BY Polmer DATE Dec 62  
DRAWN BY J. Coos DATE Jan 63  
TRACED BY Layman DATE Jan 63  
**MAIDSTONE**  
PROJ. 5 NO. 0271/10  
SHEET 22 OF 55