

1. Title Sheet
2. Typical Sections
3. Quantity Sheet
4. Right-of-Way Detail Sheet
5. Plan of Roadway
6. Profile of Roadway
7. Plan and Elevation
8. Borings
9. Framing Plan
10. Typical Section and Bearing Device
11. Abutment No. 1
12. Abutment No. 2
13. Wing Wall Details
14. Approach Slabs
15. Reinforcing Steel
16. Reinforcing Steel
- 17-23. Channel Sections
- 24-33. Roadway Sections

- BRIDGE STANDARDS**
34. SB-E4-71 12/14/71
 35. SCB-D1-71 1/24/72 R
 36. SCB-D6-71 A.D.C.D 5/15/72 R
 37. SCB-D9-71 A 12/14/71
- ROADWAY STANDARDS**
38. A-7 Typ. Slope Eounding 12/14/71
 39. U2 - L.M. Headwalls 12/14/71
 40. D3 - Trapezoidal Buffers 12/14/71
 41. D4 - Gravel Barrow at Culverts 12/14/71
 42. E3 - Bridge Const. Appr. Signs 12/14/71
 43. E5 - B.P. Road Const. Signs 12/14/71
 44. E7 - Barricades 12/14/71
 45. G1b - Box Beam Guard Rail 12/14/71
 46. G4 - Wood Marker Posts 12/14/71
 47. J1 - Erection of Project Markers 12/14/71

STATE OF VERMONT
DEPARTMENT OF HIGHWAYS



PROPOSED IMPROVEMENT
BRIDGE PROJECT

TOWN OF HALIFAX
WINDHAM COUNTY
VT. ROUTE 112, BRIDGE #8

BEGINNING ON VT ROUTE #112 APPROXIMATELY 5.04 MILES
NORTH OF THE VERMONT-MASSACHUSETTS STATE LINE
AND EXTENDING SOUTHERLY 1250 FEET ALONG VT RTE #112

LENGTH OF ROADWAY 1160.8 FEET = 0.216 MILES
LENGTH OF BRIDGE 891.9 FEET = 0.017 MILES
LENGTH OF PROJECT 1250 FEET = 0.233 MILES

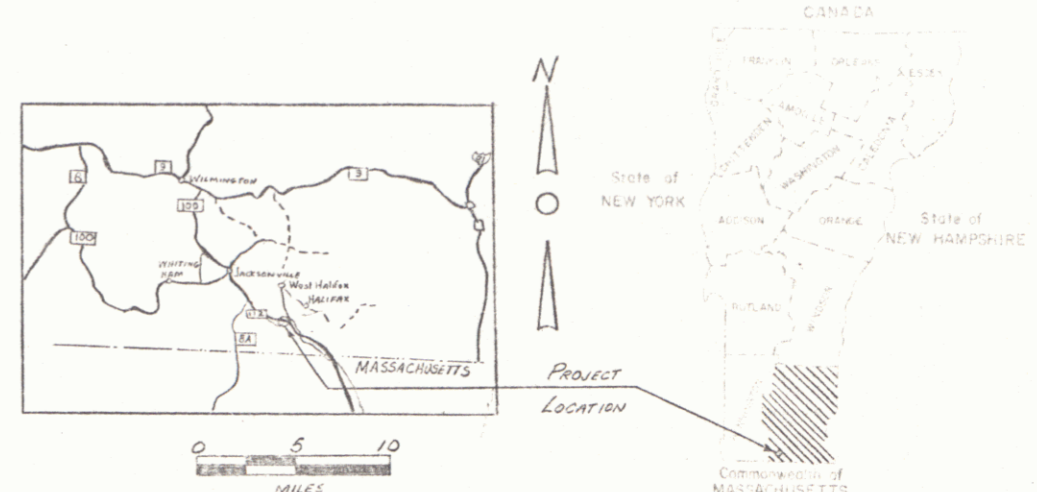

HALIFAX BP 0107-7126
RECORD PLANS PAVEMENT AREA
MATERIALS 3,025 S.Y.

SUBBASE OF GRAVEL - PICKS PIT - HALIFAX, VT. & ROBERTS PIT - COLRAIN, MA.
BITUMINOUS CONCRETE, CONCRETE CLASS A B B - WILLIAM E. DAILEY, INC. - SHAFTSBURY, VT.
METAL CULVERT PIPE - NORTHEASTERN CULVERT CORP. - WESTMINSTER, VT.
REINFORCING STRUCTURAL STEEL - BANCROFT & MARTIN, INC. - PORTLAND, ME.
STEEL CONNECTORS - NORTHEASTERN STUD WELDING CORP. - GUILFORD, N.Y.
MEMBRANE WATERPROOFING - VERMONT SEAL COATING - BARRE, VT.
EPOXY COATING COMPOUND - SIKKA COLTAC DUR - LYNDHURST, N.J.
GRANITE BRIDGE CURB - JOHN SYMONSON GRANITE CO. - CONCORD, N.H.
GUARD RAIL BEAMS - FERRIS WOOD PRODUCTS CO. - WALLINGTON, VT.
SPED & FERTILIZER - OLD FOX CHEMICAL, INC. - HAZARDVILLE, CT.

CONTRACTOR
WARREN BROS. INC. & DELTA MATERIALS CORP.
SUNDERLAND, MA.
RESIDENT ENGINEER - RICHARD P. RUSSELL, JR.
RECORD PLANS - A.G. SPIDLE.

CONTRACT
DATED - AUGUST 14, 1972.
STARTED - AUGUST 30, 1972.
COMPLETED - JULY 6, 1973.
ACCEPTED - JULY 6, 1973.

RIGHT-OF-WAY DIVISION
TOWN FILE
PERPETUAL
Town of U-112
(To Be Returned To R.O.W. Division)

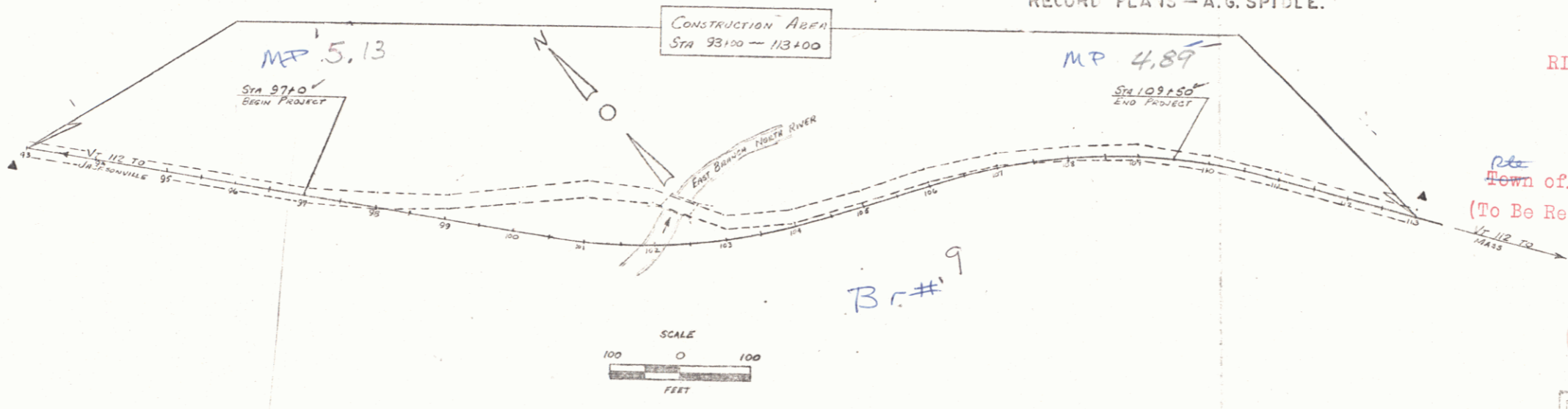

CONVENTIONAL SHEET
M
HALIFAX BP 0107-7126
CONTRACTOR - WARREN BROS. & DELTA MATERIALS CORP.
SUNDERLAND, MA.
CONSTRUCTION COMPLETED - JULY 6, 1973.
RECORD PLANS - A.G. SPIDLE.

RECOMMENDED FOR APPROVAL DISTRICT ENGINEER DATE 6-9-72	RECOMMENDED FOR APPROVAL CONSTRUCTION ENG. DATE 5/16/72	RECOMMENDED FOR APPROVAL BRIDGE ENGR. (SEAL #) DATE 6/19/72	RECOMMENDED FOR APPROVAL ASST. CHIEF ENGINEER DATE 12/14/72
--	---	---	---

Pin#00R086

NOTES ARE FURNISHED IN MATTER CONCERNING THIS PROJECT AND BE RETURNED TO THE FIELD BOOKS OR THE DISTRICT FILE.

These plans are subject to such revisions as may be required by the District Engineer.
Construction is to be carried out in accordance with the plans and the Standard Specifications for Highway and Bridge Construction dated January 3, 1972, including all subsequent approved revisions and such supplemental specifications as may be required from time to time.
R. H. Arnold 6/13/72

HALIFAX
Project BP 0107-7126
SHEET 1 47