

- INDEX OF SHEETS**
- Sheet No. 1-3 Layout and Profile
  - 4 Banking and Widening Tables
  - 5 Std. Struct. Sheet 5-20 Pipe Culverts
  - 6 " " " " 5-30 Cable Guard Rail (Roadway)
  - 7 Abutment Details
  - 8 Superstructure Details
  - 9 Std. Struct. Sheet SB-5C Cable Guard Rail (Bridge)
  - 10 " " " " SB-11 Barricades, Signs, and Lights
  - 11-17 Cross-sections

NO.	DATE	BY	REVISION	TOTAL SHEETS
1				17

HALIFAX  
FLOOD BRIDGE No. 24 P

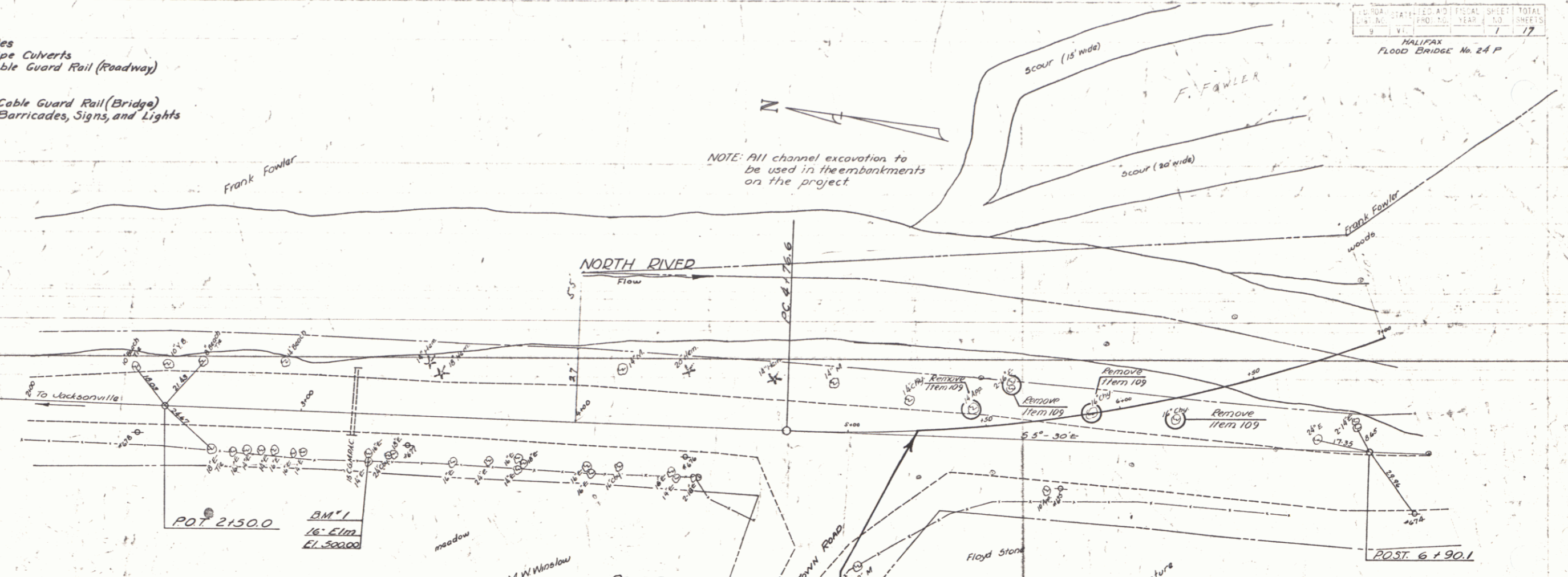
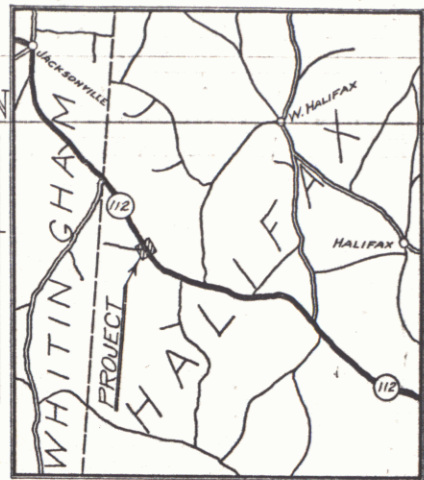

STATION	PARCEL	INSTRUMENT	GRANTOR	GRANTEE	RECORDED BOOK PAGE DATE
4+00-9+40	A	WDOE 8/9/40	FRANK W. FOWLER	ST. OF VERMONT	3/1/40
4+00-11+50	A	WDOE 8/9/40	FLOYD N. STONE	ST. OF VERMONT	

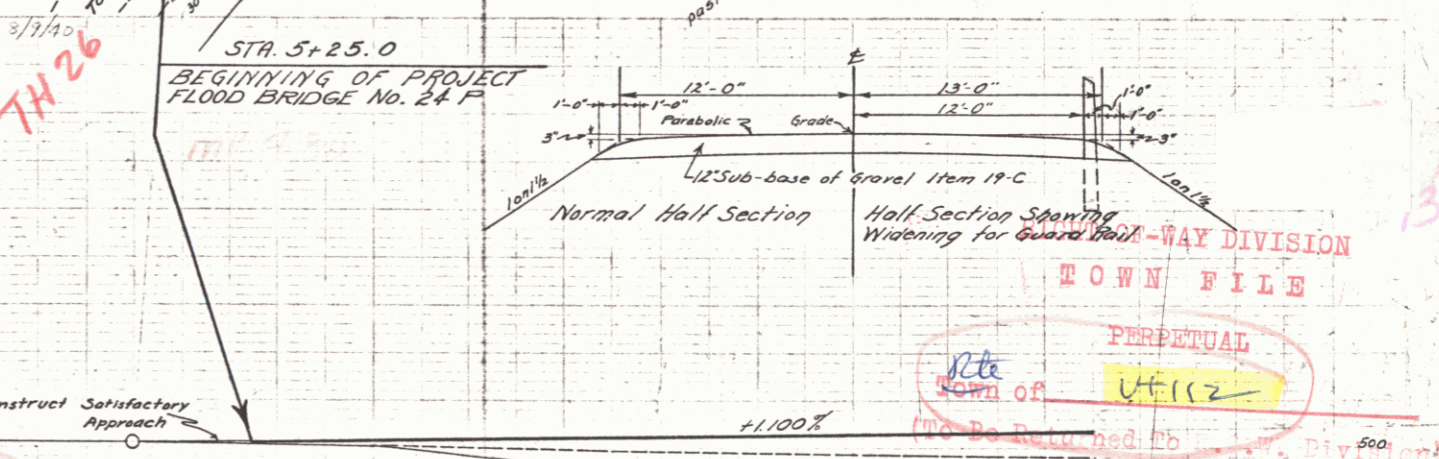

APPROVED: *[Signature]* May 28 1940  
DISTRICT HIGHWAY COMMISSIONER

CORRECT: *[Signature]* 1940  
BRIDGE ENGINEER

APPROVED: *[Signature]* 1940  
COMMISSIONER OF HIGHWAYS

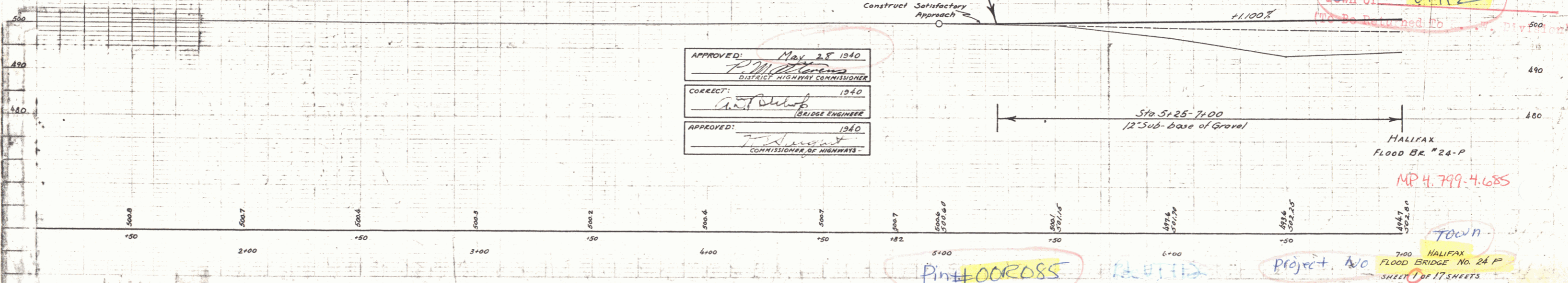

TOWN FILE  
PERPETUAL  
TOWN OF VERMONT

Pin + CROSS

Project No. 7100 HALIFAX FLOOD BRIDGE No. 24 P SHEET 1 OF 17 SHEETS

DIST. # 1 PLANS 1

- INDEX OF SHEETS**
- Sheet No. 1-3 Layout and Profile
  - " 4 Banking and Widening Tables
  - " 5 Std. Struct. Sheet 3-20 Pipe Culverts
  - " 6 " " " 3-30 Cable Guard Rail (Roadway)
  - " 7 Abutment Details
  - " 8 Superstructure Details
  - " 9 Std. Struct. Sheet SB-5C Cable Guard Rail (Bridge)
  - " 10 " " " SB-11 Barricades, Signs, and Lights
  - " 11-17 Cross-sections

**POOR ORIGINAL COPY**

**RIGHT-OF-WAY DIVISION  
TOWN FILE**

**PERPETUAL**

**Town of V+112  
(To Be Returned To R.O.W. Division)**

DATE	BY	REVISION

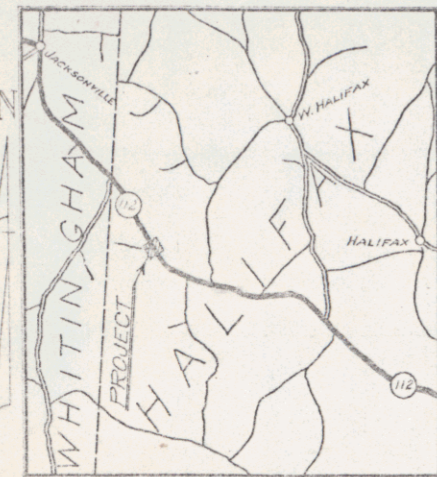

DATE	BY	REVISION

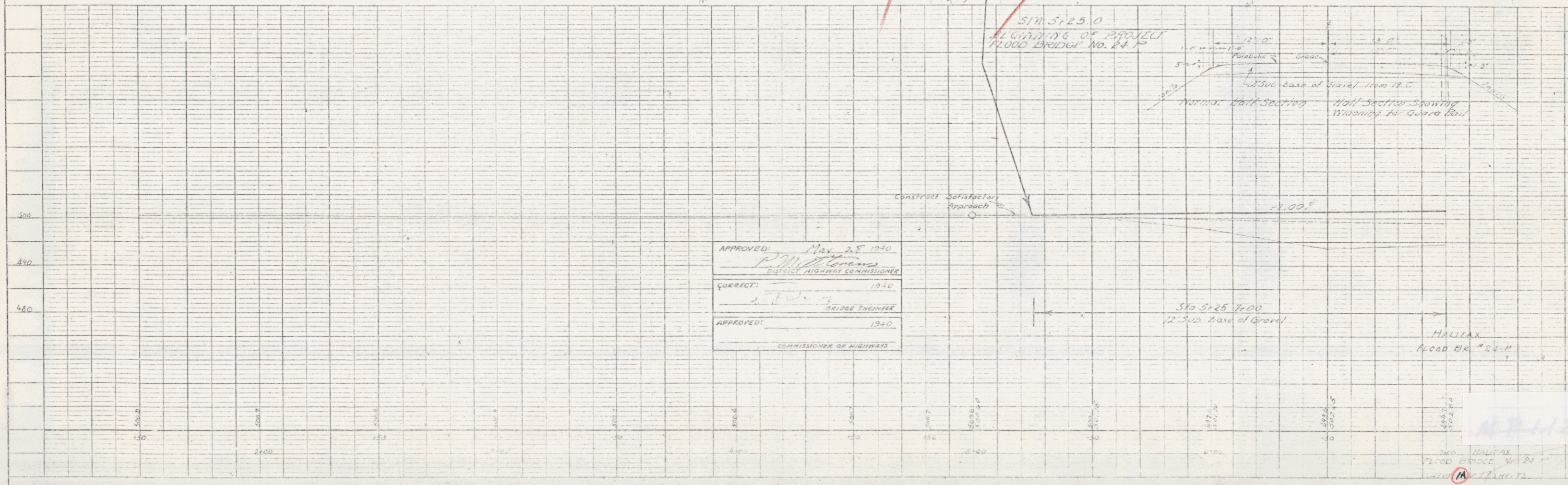

APPROVED: Nov 25 1940  
FRANK POWELL  
 DISTRICT HIGHWAY COMMISSIONER

CHECKED: 1940  
[Signature]  
 BRIDGE ENGINEER

APPROVED: 1940  
[Signature]  
 COMMISSIONER OF HIGHWAYS

**STEARNS R. JENKINS**  
**V+112**

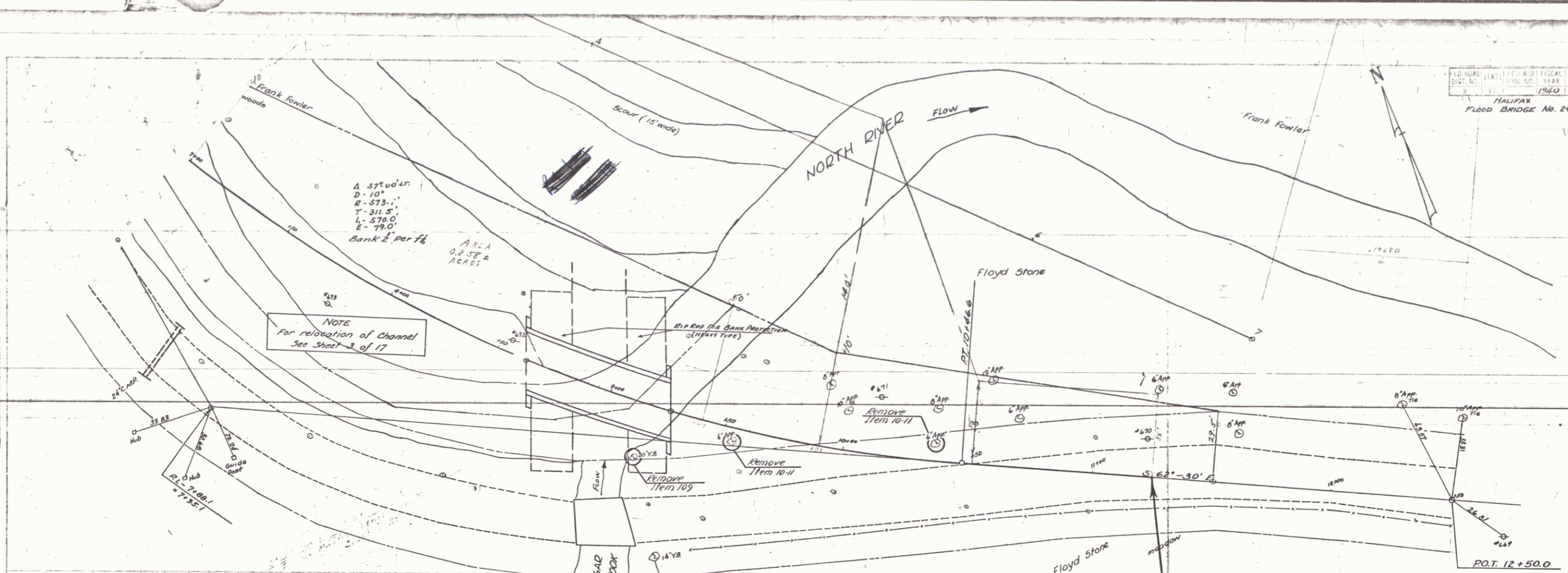

BRIDGE DATA		
	PRESENT	PROPOSED
TYPE	PLANK-SPAWN ARCH	I-BEAM CONC. ARCH
SPAN OVERALL	25'-0"	66'-0"
CLEAR HEIGHT	6'-0"	9'-0"
WIDEWAY	72'-0"	330'-0"
ROADWAY WIDTH	17'-0"	34'-0"
SPAN CLEAR	20'-0"	36'-0"

SUMMARY OF QUANTITIES (BRIDGE ONLY)

QUANTITY	UNIT	ITEM	NO.
400	cu yd	Channel Excavation	15
45	cu yd	Structure Excavation	16
1	L.S.	Maintenance of Traffic	1B
90	cu yd	Concrete Class A	11A
17,980	Lb.	Reinforcing Steel	12
1	L.S.	Steel Superstructure (40,400')	13B
1	L.S.	Removal of Present Superstructure	57
300	cu yd	Riprap for Bank Protection (heavy type)	68-B
120	lin ft	Cable Guard Rail	80A

STA. 11+25  
 END OF PROJECT  
 FLOOD BRIDGE NO. 24-P  
 mp 4.68

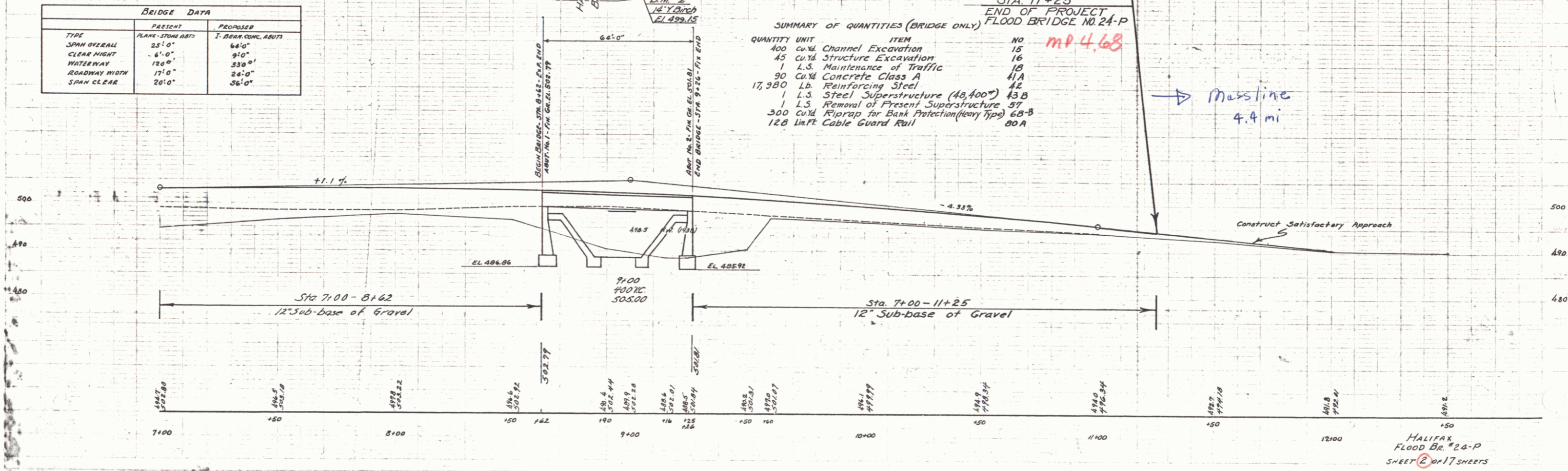

Plan No. 24-P  
 Scale: No. 24-P

Project No. 7  
 Flood Bridge No. 24-P



Bridge Data	
TYPE	SPAN
SPAN	235' 0"
CLEAR HEIGHT	45' 0"
WATERWAY	138' 0"
ROADWAY WIDTH	71' 0"
SKINNING	28' 0"

SUMMARY OF QUANTITIES (BRIDGE ONLY)	
QUANTITY	UNIT
400	cu yd Channel Excavation
15	cu yd Structure Excavation
1	LS Maintenance of Traffic
90	cu yd Concrete Class A
17,380	lb Reinforcing Steel
1	LS Steel Superstructure (40,400')
1	LS Removal of Present Superstructure
300	cu yd Riprap for Art. Protection
128	lin ft Cable Guard Rail

Sub-base of Gravel	
Station	Quantity
Sta 7+00 - 7+25	12' Sub-base of Gravel
Sta 7+25 - 11+25	12' Sub-base of Gravel

Heavy gravel available

Sheet No. 24-P

4

F.D. ROAD DIST. NO.	STATE	FED. AID	FISCAL YEAR	SHEET NO.	TOTAL SHEETS
	VI.	RD	1940	3	17

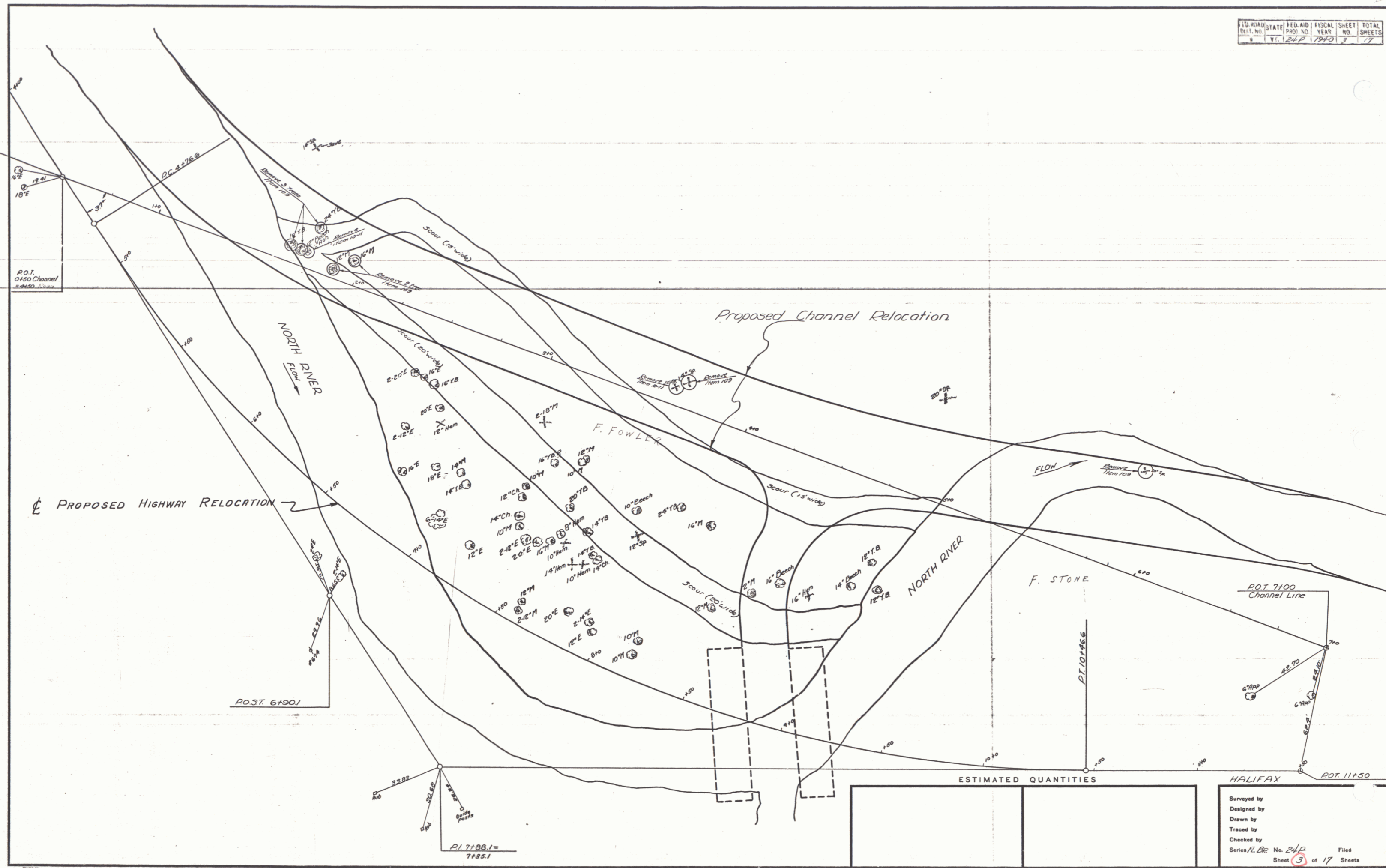

ESTIMATED QUANTITIES		HALIFAX
Surveyed by		Series/FLB No. 242 Sheet 3 of 17 Filed
Designed by		
Drawn by		
Traced by		
Checked by		