

BRIDGE DATA		
TYPE	PRESENT	PROPOSED
SPANS	16'11"	10'
CLEAR HEIGHT	6'-6"	8'
WATER WAY	15'-6"	30"
LENGTH OVERALL	15'-6"	
ROADWAY WIDTH	16'-0"	26'-0" 3/4

Rev. Curve SURR. CURVE
 59°04' RT Δ - 54° 49' E
 20' D - 20'
 287.94 R - 274.4
 163.13 T - 144.5
 295.33 L - 265.8
 43.0 E - 36.4
 Bank 2' per foot
 Do not widen

CABLE GUARD RAIL Anchors
 LT 4+50 to 6+25 175 Lf 2
 RT 4+50 to 6+25 350 Lf 4 each.

RIGHT-OF-WAY DIVISION
 TOWN FILE
 PERPETUAL

- LIST OF SHEETS (W. Division)
- 1 Plan and Profile
 - 2 Culvert Details
 - 3 S&B Lights, Barricades, etc.
 - 4 3-30 Guard Rail
 - 5-B Sections.

ESTIMATE OF QUANTITIES

10-11 Common Excav. incl. Barrow	750 CY
15 Channel Excavation	25 CY
16 Structure Excavation	100 CY
18B Temporary Bridge / Maintenance of Traffic I.L.C.	
19-C Sub-base of Gravel	180 CY
22 Gravel Surface Course	160 CY
4-A Concrete Class-A	68 CY
4-E Reinforcing Steel	7060 lbs.
57 Removal of Present Superst.	1 L.S.
80-A Cable Guard Rail	350 Lf.
80-B Anchors for Cable Guard Rail	4 ea.

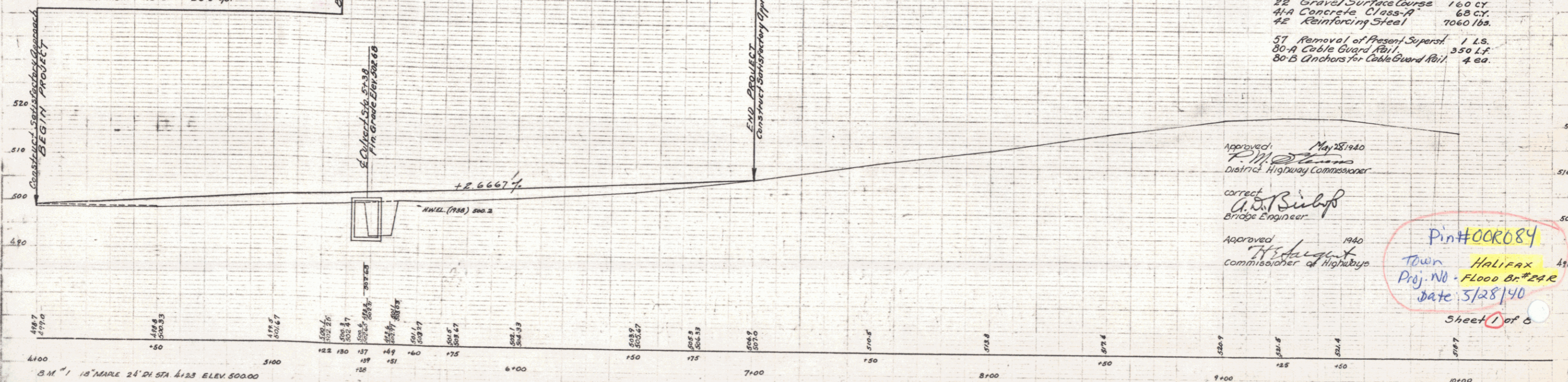

Approved: May 28, 1940
 District Highway Commissioner
 correct
 Bridge Engineer
 Approved 1940
 Commissioner of Highways

Pin#00084
 Town Halifax
 Proj. No. Flood Br. #24R
 Date 5/28/40
 Sheet 1 of 6

DIST. # 1 PLANS 1

