

TOWN OF HOLLAND
 COUNTY OF ORLEANS
 VT. ROUTE N^o III & STATE AID ROUTE N^o 2
 DERBY CENTER - ISLAND POND ROAD

Pin# 00R072

BEGINNING AT THE DERBY-HOLLAND TOWN LINE AND
 EXTENDING SOUTHEASTERLY 0.142 MILES TO THE
 HOLLAND-MORGAN TOWN LINE.

LENGTH OF PROJECT 749.0 FEET ± 0.142 MILES

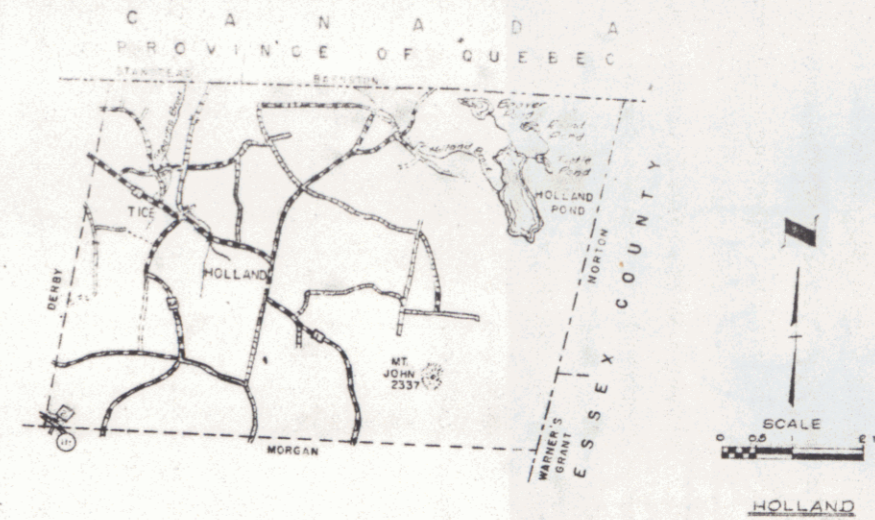

Project No.
 MP 0-00-0.138
 RIGHT-OF-WAY DIVISION
 TOWN FILE

PERPETUAL
 Date 1/1/67
 Town of VT III
 (To Be Returned To R.W. Division)

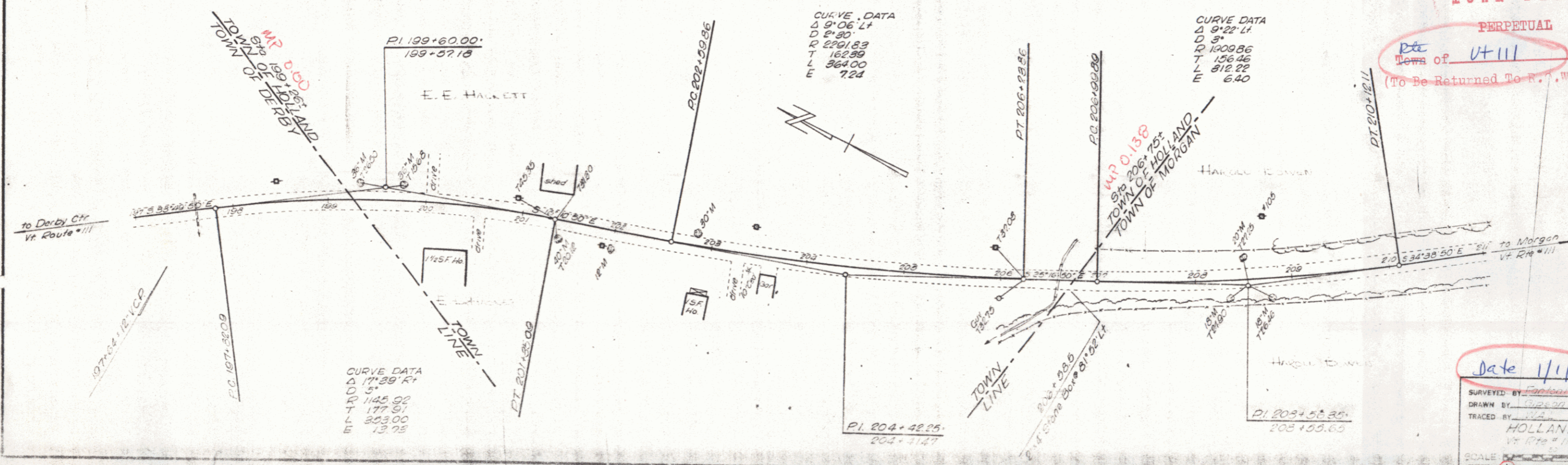

Date 1/1/67

SURVEYED BY	DATE
DRAWN BY	DATE
TRACED BY	DATE
HOLLAND	
VT 17th & III	
SCALE	
SHEET 1	OF 1