

Tunbridge 39

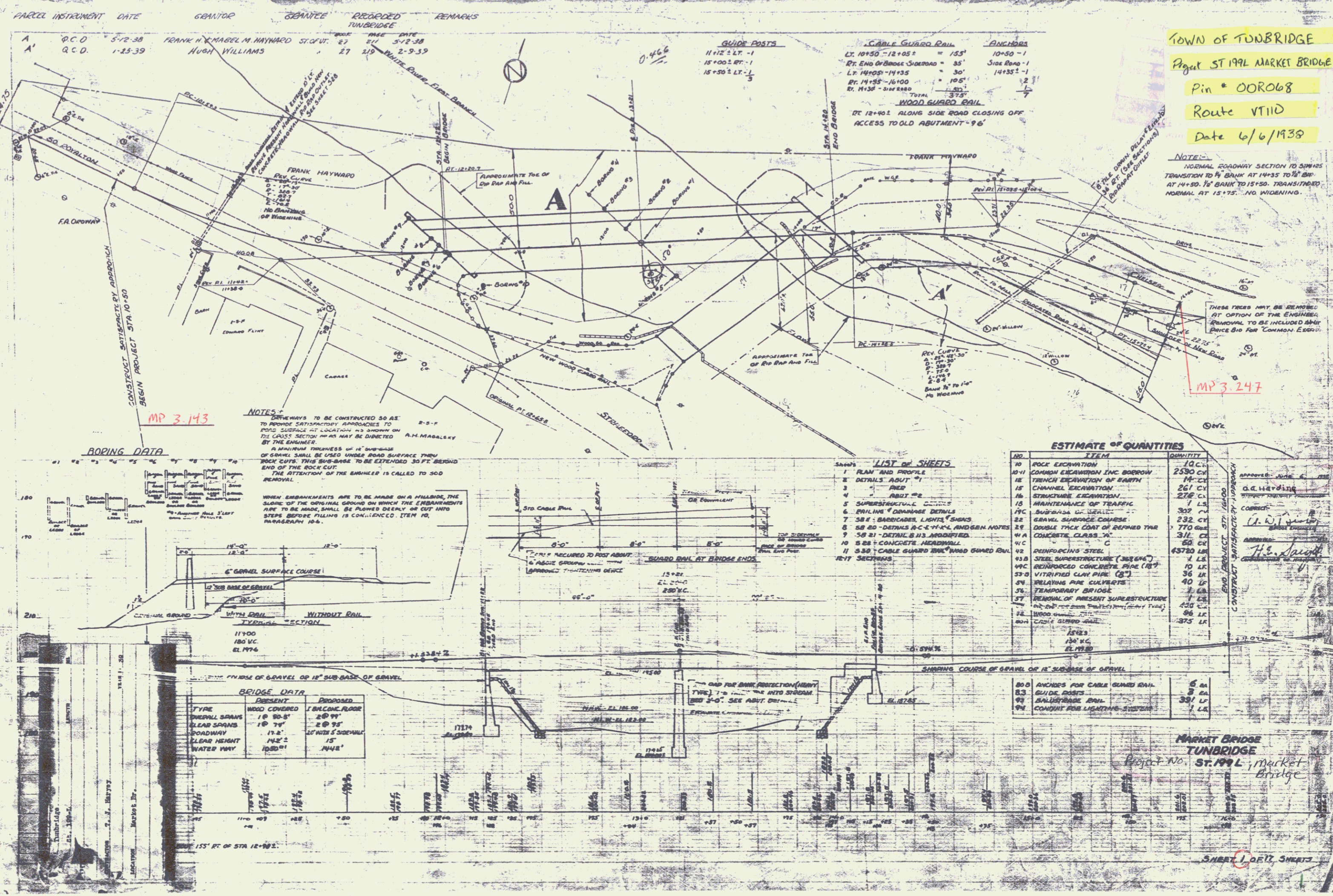

PARCEL INSTRUMENT	DATE	GRANTOR	GRANTEE	RECORDED	REMARKS
P.C.D.	5-12-38	FRANK H. & MABEL M. HAYWARD	ST. 199L	27	5-12-38
Q.C.D.	1-25-39	HUGH WILLIAMS	TUNBRIDGE	27	2-9-39

TOWN OF TUNBRIDGE  
 Project ST 199L MARKET BRIDGE  
 Pin \* 00R068  
 Route VT110  
 Date 6/6/1938

**NOTES**  
 APPROACHES TO BE CONSTRUCTED SO AS TO PROVIDE SATISFACTORY APPROACHES TO ROAD SURFACE AT LOCATION AS SHOWN ON THIS CASE'S SECTION. THEY MAY BE DIRECTED BY THE ENGINEER.  
 A MINIMUM THICKNESS OF 18" SUBGRADE OF GRAVEL SHALL BE USED UNDER ROAD SURFACE THROUGH ROCK CUTS. THIS SUB-BASE TO BE EXTENDED 30 FT BEYOND END OF THE ROCK CUT.  
 THE ATTENTION OF THE ENGINEER IS CALLED TO SOIL REMOVAL.  
 WHEN EMBANKMENTS ARE TO BE MADE ON A HILLSIDE, THE SLOPE OF THE ORIGINAL GROUND ON WHICH THE EMBANKMENTS ARE TO BE MADE, SHALL BE PLANNED CAREFULLY OR CUT INTO STEPS BEFORE FILLING IS COMMENCED. ITEM NO. PARAGRAPH 10-6.

**ROPING DATA**

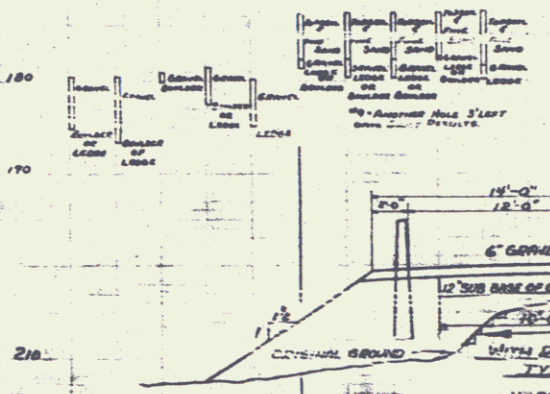

**BRIDGE DATA**

TYPE	PRESENT	PROPOSED
SPRALL SPANS	WOOD COVERED	1 BALCONY FLOOR
SLAB SPANS	10 30'-8"	2 @ 99'
ROADWAY	10' 7"	2 @ 95'
CLEAR HEIGHT	14'-2"	15'
WATER WAY	10'-0"	14'-8"

**LIST OF SHEETS**

- 1 PLAN AND PROFILE
- 2 DETAILS ABOUT 7'
- 3 ABUT 1
- 4 ABUT 2
- 5 SUPERSTRUCTURE DETAILS
- 6 DETAILS OF CHANGE DETAILS
- 7 3/4" BARRICADE LIGHTS LEGS
- 8 3/4" BARRICADE LIGHTS LEGS
- 9 3/4" BARRICADE LIGHTS LEGS
- 10 3/4" BARRICADE LIGHTS LEGS
- 11 3/4" BARRICADE LIGHTS LEGS

**ESTIMATE OF QUANTITIES**

NO.	ITEM	QUANTITY
10	ROCK EXCAVATION	10 C.Y.
10-1	COMMON EXCAVATION INC BORROW	2530 C.Y.
11	TRENCH EXCAVATION OF EARTH	14 C.Y.
12	CHANNEL EXCAVATION	261 C.Y.
13	STRUCTURE EXCAVATION	276 C.Y.
14	MAINTENANCE OF TRAFFIC	1 L.S.
15	SURFACE OF GRAVEL	309 C.Y.
16	GRAVEL SURFACE COURSE	232 C.Y.
17	DOUBLE THICK COAT OF REPAVED TAR	170 SQA.
18	CONCRETE CLASS "A"	311 C.Y.
19	CONCRETE CLASS "C"	60 C.Y.
20	REINFORCING STEEL	43780 LB.
21	STEEL SUPERSTRUCTURE (3000#)	1 L.S.
22	REINFORCED CONCRETE PILE (18")	10 LF.
23	VITRIFIED CLAY PIPE (18")	36 LF.
24	RELATING PIPE CHOLETS	40 LF.
25	TEMPORARY BRIDGE	1 L.S.
26	REMOVAL OF PRESENT SUPERSTRUCTURE	1 L.S.
27	WOOD SHORING	400 LF.
28	WOOD BRACKETS	86 LF.
29	CABLE GUARD RAIL	375 LF.
30	ANCHORS FOR CABLE GUARD RAIL	6 AN.
31	SALESYMANE GRAY	331 LF.
32	CONDUIT FOR LIGHTING SYSTEM	1 L.S.

MARKET BRIDGE  
 TUNBRIDGE  
 Project No. ST 199L Market Bridge

SHEET 1 OF 2 SHEETS