

PARCEL INSTRUMENT	DATE	GRANTOR	GRANTEE	RECORDED WASHINGTON BOOK PAGE DATE	REMARK
C	W.006	8-30-41	E.D. PALMER	ST OF W. 27 258 11-7-61	

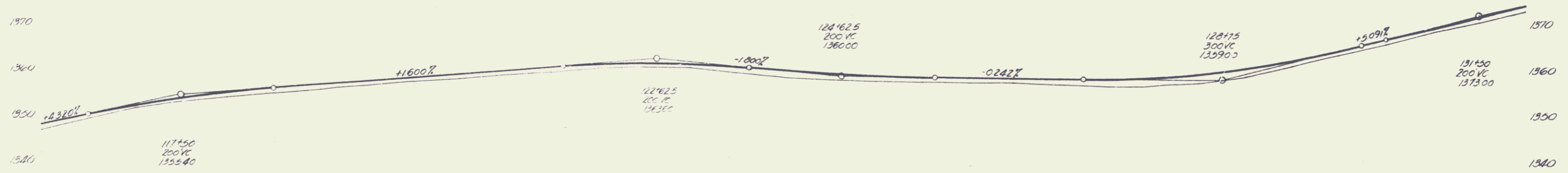
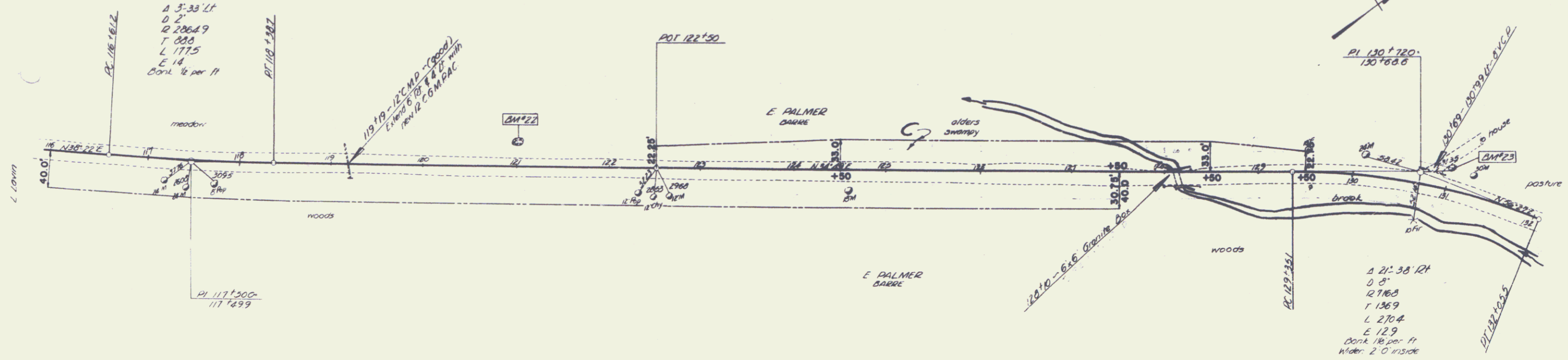

Station	Point	Distance	Bearing
118	118+282	0	
119	119+19	20' 11"	
120	120+10	6.6'	
121	121+150	200 VC	
122	122+50		
123	123+17		
124	124+625	200 VC	
125	125+115		
126	126+115		
127	127+115		
128	128+115	300 VC	
129	129+115		
130	130+115		
131	131+150	200 VC	
132	132+150		
133	133+150		
134	134+150		
135	135+150		
136	136+150		
137	137+150		
138	138+150		
139	139+150		
140	140+150		
141	141+150		
142	142+150		
143	143+150		
144	144+150		
145	145+150		
146	146+150		
147	147+150		
148	148+150		
149	149+150		
150	150+150		

SHEET 29

14 N.M. 123 2nd ch. @ October 22 1941 Sta 121+00 - L&W 132.27

151 WASHINGTON 130  
SIPLES ST 126 1942