

PARCEL	INSTRUMENT	DATE	GRANTOR	GRANTEE	RECORDED	WASHINGTON	REMARKS
A B C	Q.C.D.	11-27-39	JOHN COOK	ST OF VT	BOOK 27	PAGE 163	12-2-39
A	Q.C.D.	11-27-39	WILLIAM & BESSIE MARSHALL	ST OF VT	BOOK 27	PAGE 165	12-2-39

ED. ROAD. STAFF LOCAL SHEET 101 AM
 EST. NO. 1790 NO. 2150 NO. 10115
 1790 2 36

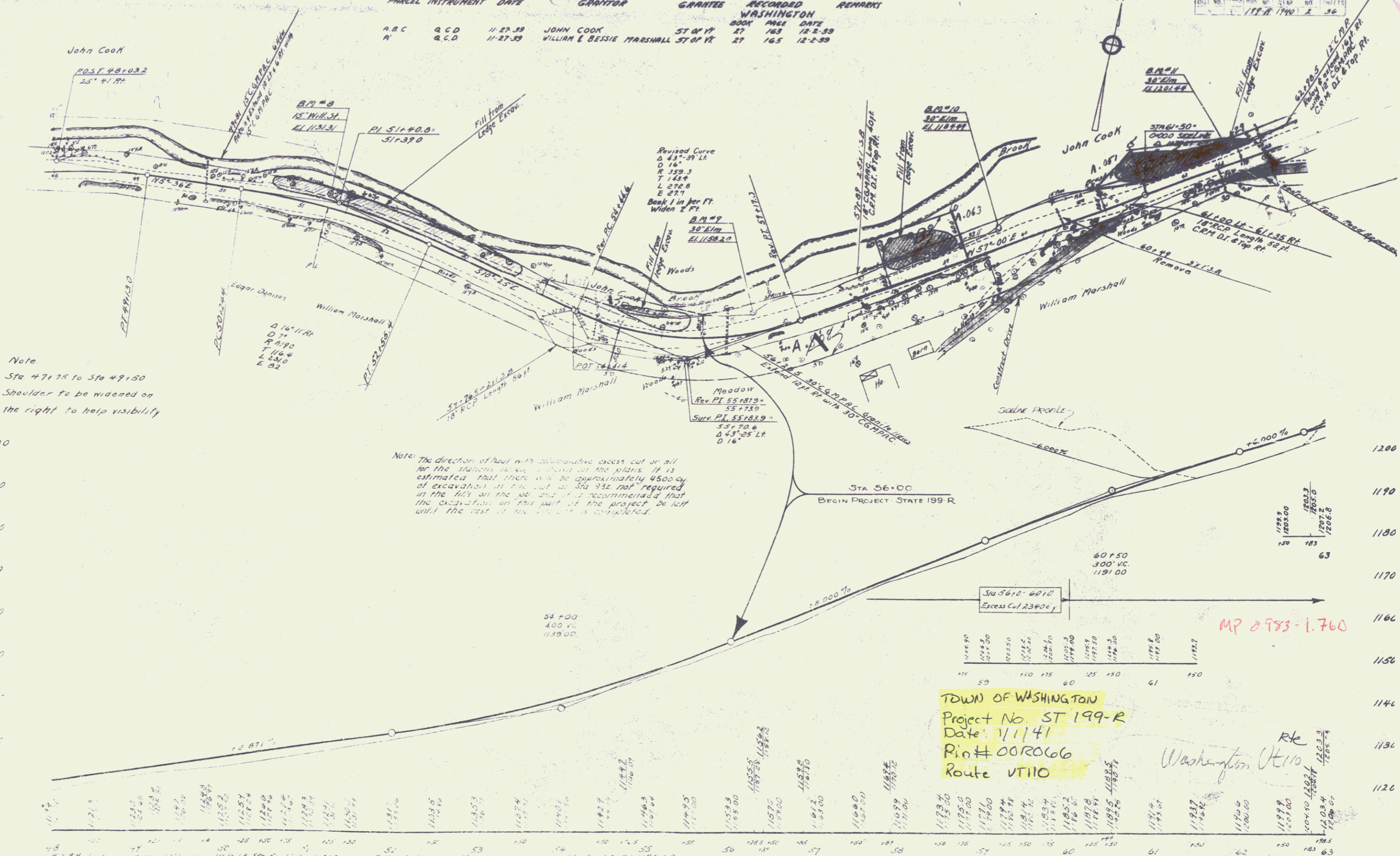

Note:
 Sta 47+75 to Sta 49+50
 Shoulder to be widened on
 the right to help visibility

Note:
 The direction of haul with approximate excess cut or fill
 for the stations shown is shown on the plans. It is
 estimated that there will be approximately 4500 cu
 of excavation in the cut at Sta 93+ not required
 in the fill on the job and it is recommended that
 the excavation on this part of the project be left
 until the rest of the project is completed.

TOWN OF WASHINGTON
 Project No. ST 199-R
 Date: 1/1/41
 Pin # 000066
 Route VT110

Washington Vt 110

WASHINGTON
 STATE 199-R
 Speed 27 To Street