

A.C. HOFF
 DISTRICT ENGINEER
 DATE 9/1/1955
 PROJECT NO. 100-100
 SHEET NO. 7 OF 7

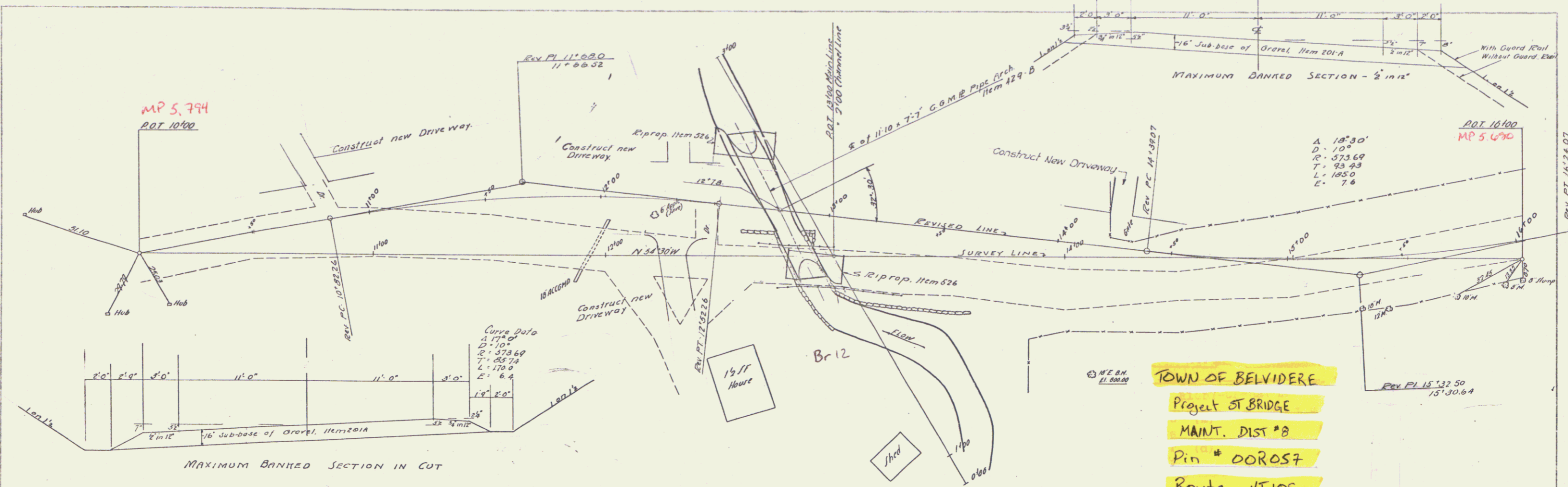

TWO CABLE GUARD RAIL

Side	From Rev. Sta.	To Rev. Sta.	Length
Left Side	10'25" to 10'73"	48'	
"	10'84" to 12'25"	136'	
"	12'41" to 14'19"	178'	
Right	12'40" to 13'60"	112'	
TOTAL LIN. FT.		474	

ESTIMATED QUANTITIES

INCLUDES OVER-RUN OF	QUANTITY	UNIT	ITEM	ITEM NO.
	53 CY	CY	Common Excavation	101A
	140 CY	CY	Borrow	102
	10 CY	CY	Unclassified Channel Excavation	104C
	10 CY	CY	Structure Excavation (Mod)	107
	1	LS	Maintenance of Traffic for Bridge Projects	109
	97 CY	CY	Sub-base of Gravel (Meas. in Place)	201A
	87	CY	Gravel Backfill	222
	18	LF	18" Asph. C&G Corr. Galv. Metal Pipe	425H
	1	LS	Corr. Galv. Metal Plate Pipe Arch (28'30")	429A
	76	CY	Riprap for Bank Protection	524
	474	LF	Two Cable Guard Rail	542
	8	EA	Anchor for Two Cable Guard Rail	542

LIST OF SHEETS

Sheet	Description
1 of 7	Plane & Profile (This sheet)
2	Arch Pipe Details
3	Earthwork Sheet
4	Roadway Sections
5	
6	Channel Sections
7	S.B.'s, Barricades, Signs & Lights

TOWN OF BELVIDERE
 Project ST BRIDGE
 MAINT. DIST #8
 Pin # 00R057
 Route VT109
 Date 9/1/1955

BRIDGE DATA

Type	Stone Curved Road	C.G.M.P. Pipe Arch
Overall Length	15'-0"	14'-0"
roadway Width	16'-0"	30'-0"
Clear Height	11'-0"	7'-7"

Approved: *[Signature]* DATE Sept. 1 1955
 DISTRICT ENGINEER
 Correct: _____ DATE _____ 1955
 BRIDGE ENGINEER
 Approved: _____ DATE _____ 1955
 CHIEF ENGINEER

