

A.C. HOFF  
 DISTRICT ENGINEER  
 STATE BRIDGE MAINT. DIST. #8  
 BELVIDERE, VT.  
 NO. 1000

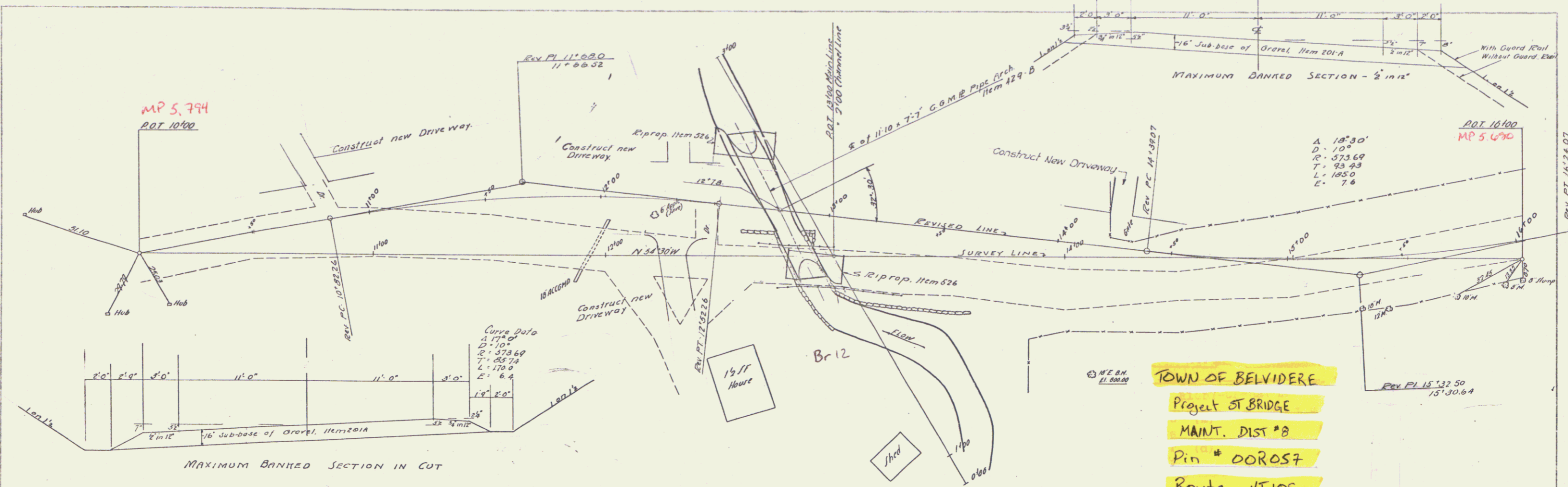

TWO CABLE GUARD RAIL

Left Side	From Rev. Stas 10+25 to 10+73 = 48'
	10+84 to 12+23 = 136'
	12+41 to 14+19 = 178'
Right	12+40 to 13+60 = 112'
TOTAL LIN. FT. = 474	

8 Anchors Req.

ESTIMATED QUANTITIES

INCLUDES OVER-RUN OF	QUANTITY	UNIT	ITEM	ITEM NO.
	53	CY	Common Excavation	101A
	140	CY	Borrow	102
	10	CY	Unclassified Channel Excavation	104C
	10	CY	Structure Excavation (Mod)	107
	1	LS	Maintenance of Traffic for Bridge Projects	109
	97	CY	Sub base of Gravel (Meas. in Place)	201A
	87	BCY	Gravel Backfill	222
	18	LF	18" Asph. C'd. Corr. Galv. Metal Pipe	425H
	1	LS	Corr. Galv. Metal Plate Pipe Arch (28' x 30")	426A
	76	CY	Riprap for Bank Protection	526
	474	LF	Two Cable Guard Rail	542
	8	EA	Anchors for Two Cable Guard Rail	542

LIST OF SHEETS

Sheet 1 of 7	Plane & Profile (This sheet)
2	Arch Pipe Details
3	Earthwork Sheet
4	Roadway Sections
5	
6	Channel Sections
7	S.B.'s, Barricades, Signs & Lights

Date 9/1/1955

BRIDGE DATA

Type	SPACING	DOORWAY	ROADWAY
CG.M.P.P.A. Arch	14'-0"	14'-0"	14'-0"
Stone Curbs, Wood	8'-0"	11'-0"	11'-0"
Overall Length	15'-0"	14'-0"	14'-0"
Doorway Width	16'-0"	30'-0"	30'-0"
Clear Height	11'-0"	7'-7"	7'-7"

Approved: *E. J. Nickerson* DATE Sept. 1 1955  
 DISTRICT ENGINEER  
 Correct: \_\_\_\_\_ DATE \_\_\_\_\_ 1955  
 BRIDGE ENGINEER  
 Approved: \_\_\_\_\_ DATE \_\_\_\_\_ 1955  
 CHIEF ENGINEER

