

RIGHT-OF-WAY DIVISION  
 TOWN FILE  
 PERPETUAL  
 Town of #108  
 (To Be Returned To R.O.W. Division)

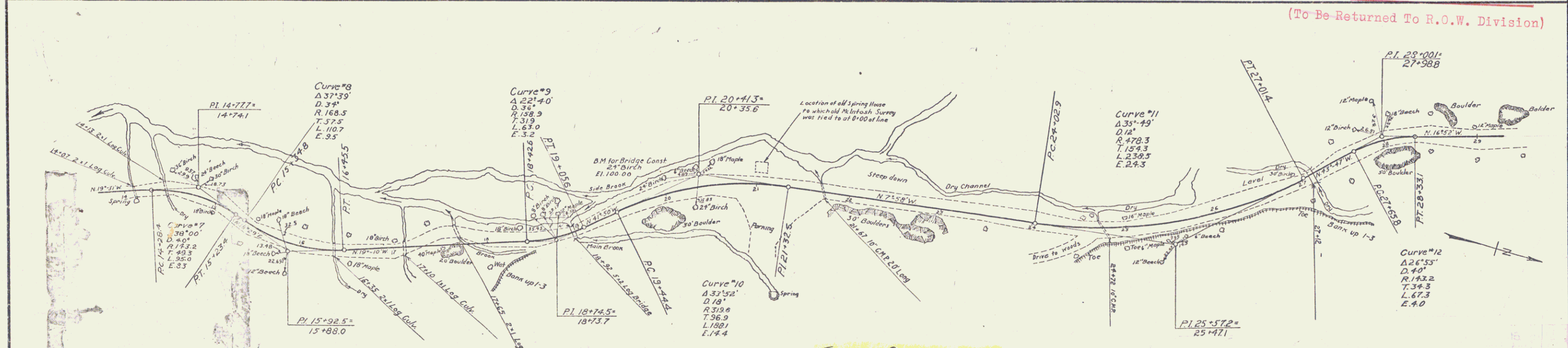

TOWN OF CAMBRIDGE  
 Project MM 0.00-1.00  
 Pin # 00R052  
 Route VT 108  
 Date 5/1/1981

MP 0.00-0.994  
 TOWN OF CAMBRIDGE  
 SMUGGLERS NOTCH ROAD  
 Scale: 1"=50'

Surveyed by	Putnam, May, 1931
Designed by	5/1/1931
Drawn by	Groason
Traced by	R. Planders
Checked by	
Series	No. of Sheets
	Sheet 1 of 2