

THIS PARCEL IS PART OF VERMONT ROUTE 108
 PRIOR TO RELOCATION OF SAME IN THE ABOVE
 PROJECT. VERMONT RT. 108 WAS TAKEN INTO THE
 STATE HIGHWAY SYSTEM ON MARCH 28, 1935 BY
 ORDER OF THE STATE HIGHWAY BOARD.

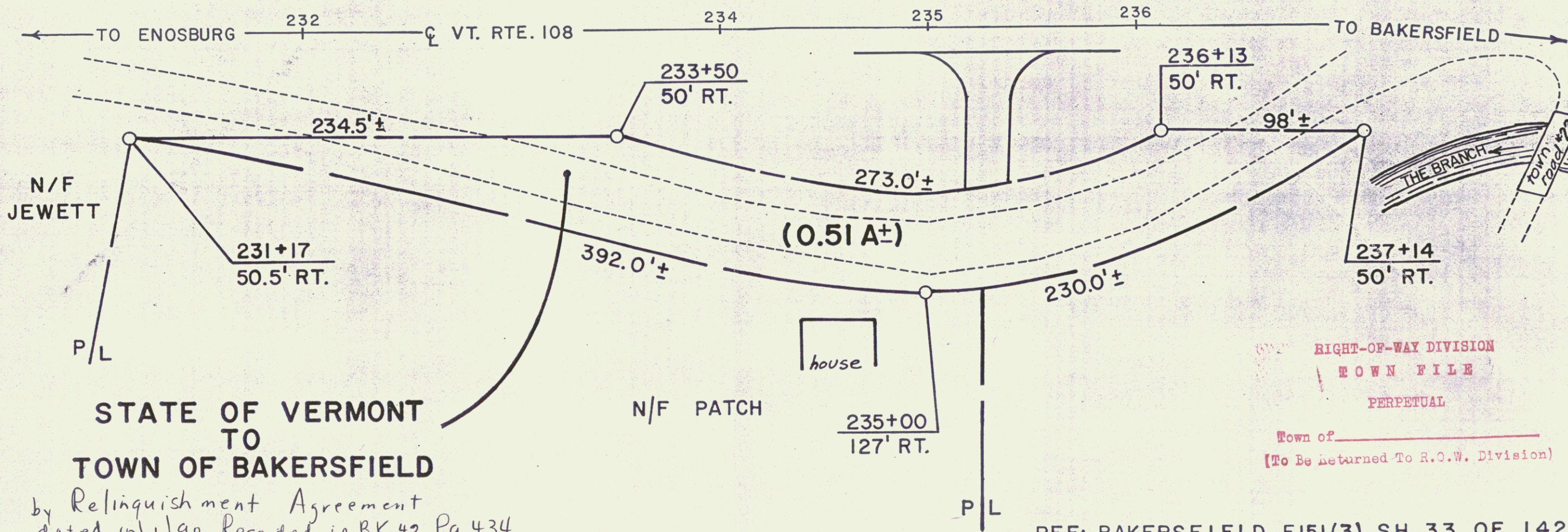
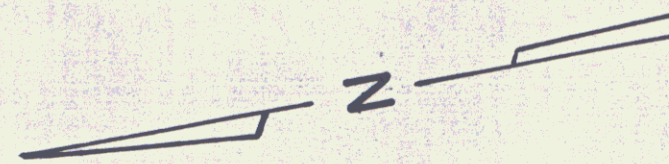

STATE OF VERMONT
 TO
 TOWN OF BAKERSFIELD
 by Relinquishment Agreement
 dated 10/1/90 Recorded in BK 42, Pg 434

RIGHT-OF-WAY DIVISION
 TOWN FILE
 PERPETUAL
 Town of _____
 (To Be Returned To R.O.W. Division)

REF: BAKERSFIELD F151(3) SH. 33 OF 142



STATE OF VERMONT AGENCY OF TRANSPORTATION		
		SHEET 33A
TOWN OF BAKERSFIELD		
		25
APPROX. SCALE 1"=50'	DATE: 8-22-90	DRAWN BY C.P.