

INDEX OF SHEETS

SHEET NO. 1	TITLE PAGE	
" 2	TYPICAL CROSS-SECTION OF IMPROVEMENT	} gravel surface course
" 3	BANKING & WIDENING TABLES	
" 4-8	PLAN & PROFILE SHEETS	
" 9	STANDARD STRUCTURE SHEET	3-28 PIPE CULVERTS
" 10	STANDARD STRUCTURE SHEET	3-30 GUARD RAIL
" 11	BARRICADES, SIGNS & LIGHTS	SD-11
" 12-23	CROSS SECTIONS	

Standard structure sheet 3-28 submitted to the Chief Engineer on May 16, 1933.
Standard structure sheet 3-30 submitted to the Chief Engineer on Aug. 15, 1933.

FED. ROAD DIST. NO.	STATE	F. R. S. PROJ. NO.	FISCAL YEAR	SHEET NO.	TOTAL SHEETS
9	VT.	151	1933	1	23

**STATE OF VERMONT
STATE HIGHWAY DEPARTMENT**

**PLAN AND PROFILE OF PROPOSED
STATE HIGHWAY**

NATIONAL RECOVERY SECONDARY PROJECT

TOWN OF CAMBRIDGE

JEFFERSON ENOSBURG FALLS ROAD

FROM A POINT 1100 FT. NORTH FROM THE
RESIDENCE OF MRS. IVY KITTEL, NORTHERLY
1.086 MILE TO THE CAMBRIDGE FLETCHER
TOWN LINE.

LENGTH OF PROJECT 5,737.0 FT. = 1.086 MILES.

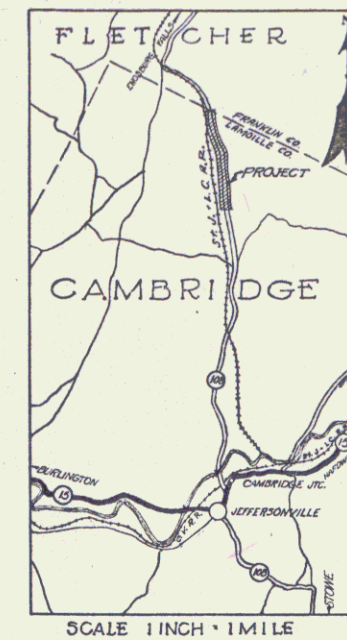

RECORD PLANS

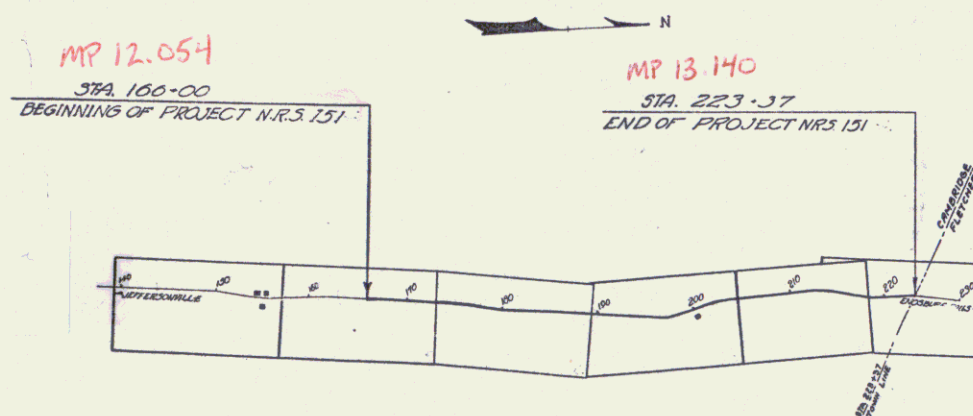

RIGHT-OF-WAY DIVISION
TOWN FILE
PERPETUAL
Rte. Town of VT 108
(To Be Returned To R.O.W. Division)

APPROVED: Nov 13 1933
H. Sargent
COMMISSIONER OF HIGHWAYS
SUBMITTED BY ORDER OF THE STATE HIGHWAY BOARD

NOTE: FOR FURTHER INFORMATION CONCERNING
FUND CATEGORIES, AMOUNTS OR OTHER DETAILS
RELATIVE TO THIS PROJECT MAY BE FOUND IN
EITHER THE FIELD BOOKS OR THE ESTIMATE
FILE.

CONVENTIONAL SIGNS

COUNTY LINE	GROUND ELEVATION	BATH	LINE
TOWN LINE	FENCE LINE	STONE WALL	UNFENCED PROPERTY
GUARD RAIL	TRAVELED WAY	RAILROAD	RETAINING WALL
CENTER LINE	SURVEY LINE	CULVERT	DROP INLET
TROLLEY POLE	POWER POLE	TELEPHONE POLE	TREES
HEDGE			

CURVE DATA

DEFLECTION ANGLE	Δ
DEGREE OF CURVE	D
RADIUS OF CURVE	R
TANGENT DISTANCE	T
LENGTH OF CURVE	L
EXTERNAL DISTANCE	E
POINT OF INTERSECTION	P. I.
POINT OF CURVE	P. C.
POINT OF TANGENT	P. T.
POINT ON TANGENT	P. O. T.

CAMBRIDGE MRS 151
RECORD PLANS
STATE FORCE ACCOUNT
FISCAL YEAR 1934

SCALES
TITLE 1"=1000'
PLAN 1"=30'
PROF. VERT. 1"=10'
CROSS SECTIONS 1"=5'

These plans are subject to such revisions as
may be required by the Bureau of Public
Roads or the Commissioner of Highways.
Construction is to be carried on in accordance
with the standard road and bridge specifications
of 1930 with all subsequent approved revisions
and such specifications and special provisions
as are submitted with the plans.

RECOMMENDED FOR APPROVAL

DISTRICT ENGINEER BUREAU OF PUBLIC ROADS

RECOMMENDED FOR APPROVAL

CHIEF ENGINEER BUREAU OF PUBLIC ROADS

APPROVED

DIRECTOR - BUREAU OF PUBLIC ROADS

Pin # 00R041
Route VT 108
Date 11/13/1933

NOV 13 1933
ROAD ENGINEER

SERIES MRS. NO. 151
SHEET 1 OF 23