

PLAN
 DATE: 10/25/66
 DRAWN BY: [illegible]
 CHECKED BY: [illegible]
 NO. 1

NOTE: Pavement is to be carried full width (to the point of shoulder) in areas where guard rail is used.
 Subbase of Gravel, Item 201-A, shall be used to stabilize cut slopes, if required, as directed by the engineer.

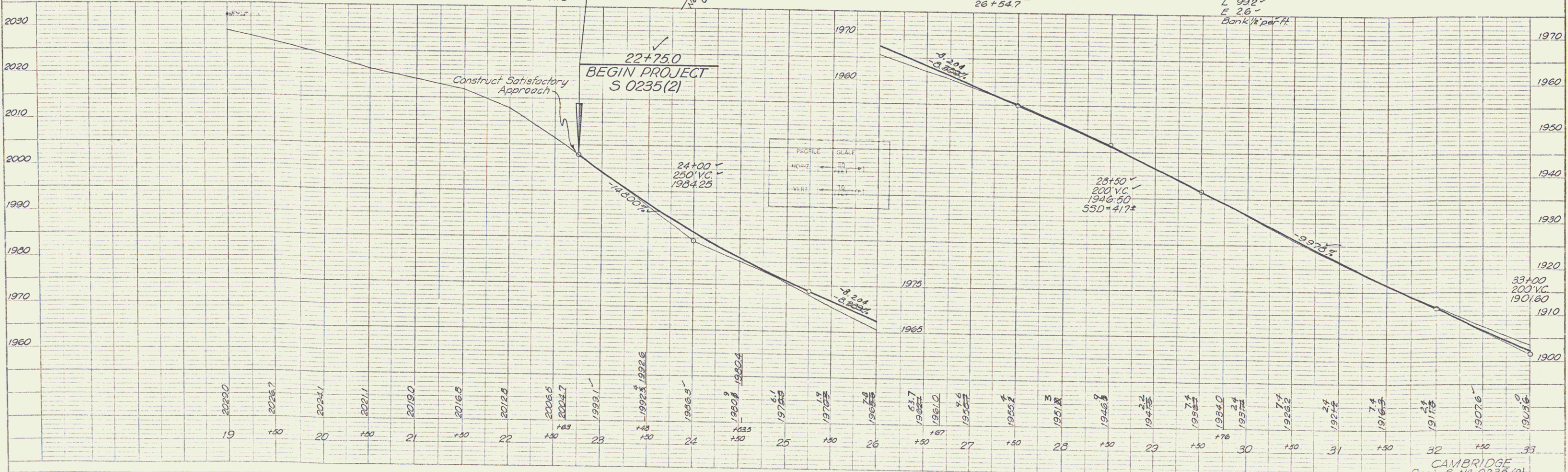
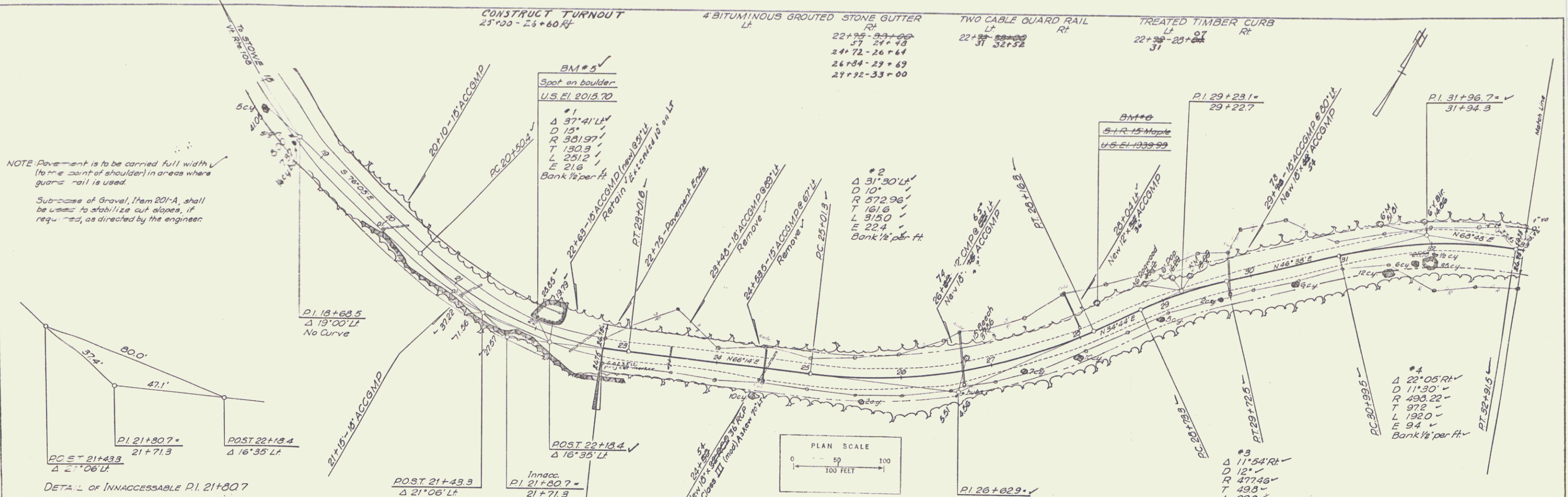

PROFILE
 DATE: 10/25/66
 DRAWN BY: [illegible]
 CHECKED BY: [illegible]
 NO. 1